

# U. S. Public Land Corner Maintenance

# 26

Corner: N1/4 Sec. 10, T16N-R1E

41601030020

<u>Date</u>	<u>Crew</u>	<u>Monument type</u>
December 4, 2023	Zachariah P. Dechant Gary L. Dechant	Found Harrison, set sign 1' east between two ravines

References:

- 1) Set 5/8"x 24" round rebar
- 2) Set 1"x24" iron pipe
- 3) Set 5/8"x 5' round rebar, 4' NW of 12" Maple
- 4) Set 5/8"x 5' round rebar

Compass bearings  
Stone over bars

<u>Bearing</u>	<u>Distance</u>
N27E	27.55'
N66E	17.79'
S55E	17.72'
N25W	21.62'



I, William C. Jung do hereby certify that on the seventeenth day of June 1980, I found (evidence) ~~Section 10~~ of the North 1/4 corner of Section 10, T16 N, R1 E Fourth Principal Meridian, and I re-established said corner according to the Wisconsin Statutes as shown and described hereon.

Dated this 23rd day of Feb. 1981.

William C. Jung

William C. Jung - R.L.S. 1323  
Title

History of corner establishment since Original Government Survey

Gary Sime set a 3/4" iron bar at the occupied fence corner in July of 1976.

Description of corner evidence found:

Found the corner of record at the occupied fence corner. Removed the iron bar, and replaced it with a Harrison marker. Accepted the fence corner as the <sup>best</sup> available evidence of the original government corner.

See Reverse Side For Maintenance

COUNTY SURVEYOR FORM NO. 1

Description of corner and witness monuments, references and accessories used to perpetuate the original or re-established location of this corner:

Witnesses to corner location:

William Jung  
Gary Dechant  
Todd Tormoen

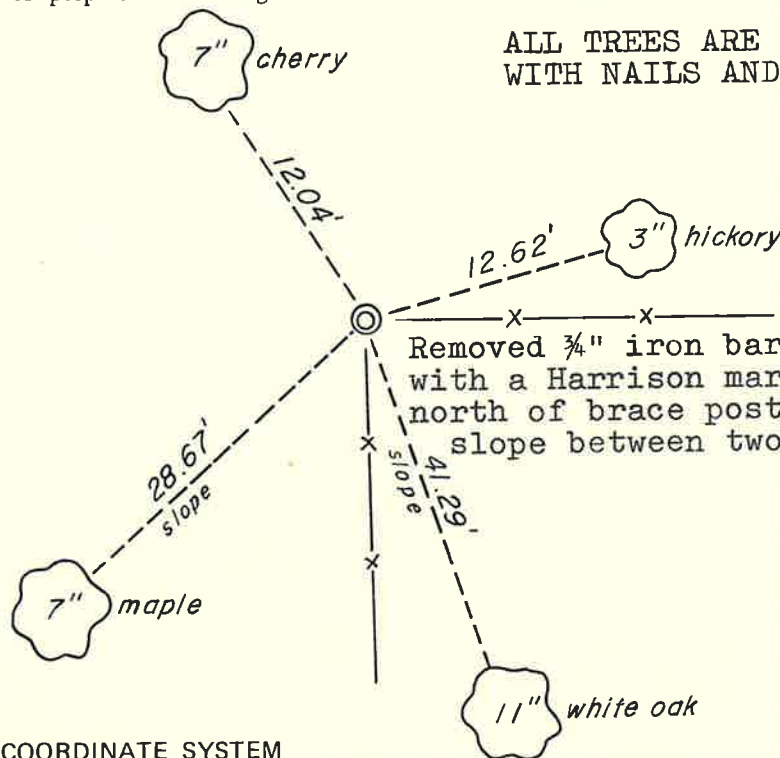
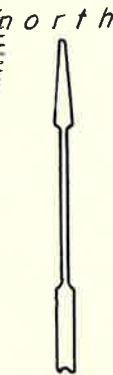
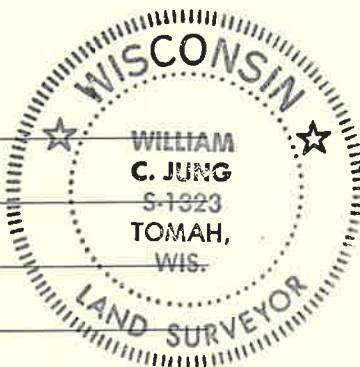

ALL TREES ARE DOUBLE BLAZED WITH NAILS AND CAPS SET.

Removed 3/4" iron bar and replaced it with a Harrison marker, up 3" and north of brace post. Corner is on side slope between two ravines.

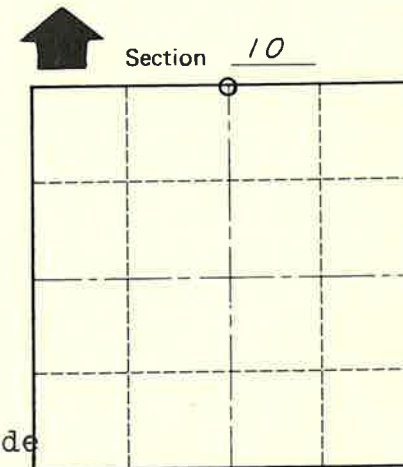

O = LOCATION CORNER

T 16 N R 1 E

WISCONSIN

Approved: **HARLEY A. SIME**  
**MONROE CO. SURVEYOR**

SURVEY CONTROL ORDER

Horizontal	_____
Vertical	_____

WISCONSIN COORDINATE SYSTEM

Corner	East (X)	North (Y)	Elevation (Z)	Zone
Control Sta. Name				

~~City, Village or~~ Town of Clifton  
County of Monroe  
Wisconsin