

# U. S. Public Land Corner Maintenance

# 19

Corner: E1/4 Sec. 2, T17N-R2W

21702022000

<u>Date</u>	<u>Crew</u>	<u>Monument type</u>
August 18, 2023	Zachariah P. Dechant Gary L. Dechant	Found Harrison at remnants of fence corner. Old woven wire running north, bath wire south and east.

References:

- 1) Set 5/8"x24" round rebar, stone over bar
- 2) Set 5/8"x24" round rebar, west of 4" Catulpa
- 3) Set 5/8"x24" round rebar in pasture, down 6"
- 4) Set 5/8"x24" round rebar in pasture, down 6"
- 5) 1978 bearing tree 30" White Oak

Compass bearings  
Trees double blazed

<u>Bearing</u>	<u>Distance</u>
N29E	26.48'
S87E	35.80'
S70W	27.14'
N51W	31.03'
NW	14'

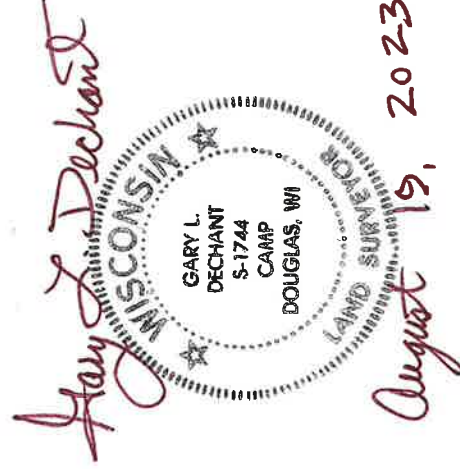

I, Harley A. Sime, do hereby certify that on the 27th day of March 1978, I found (evidence) ~~(no evidence)~~ of the E 1/4 corner of Section 2, T17 N, R 2 W, Fourth Principal Meridian, and I re-established said corner according to the Wisconsin Statutes as shown and described hereon.

Dated this 21st day of Nov. 1978.

Harley A. Sime, R.L.S. 355

County Surveyor

Title

History of original corner establishment:

Schroeder set post in 1883. Hurlburt set an auto drive shaft over an existing iron pipe in November of 1940.

Description of corner evidence found:

W. Jung found an auto axle inside a pipe, up 6", in Dec. of 1974. It was set by R. Hurlburt in 1940.

**See Reverse Side For Maintenance**

Description of corner and witness monuments, references and accessories used to perpetuate the original or re-established location of this corner:

Witnesses to corner location:

G. Dechant

C. Pietz

(All trees double blazed with N&C's set)

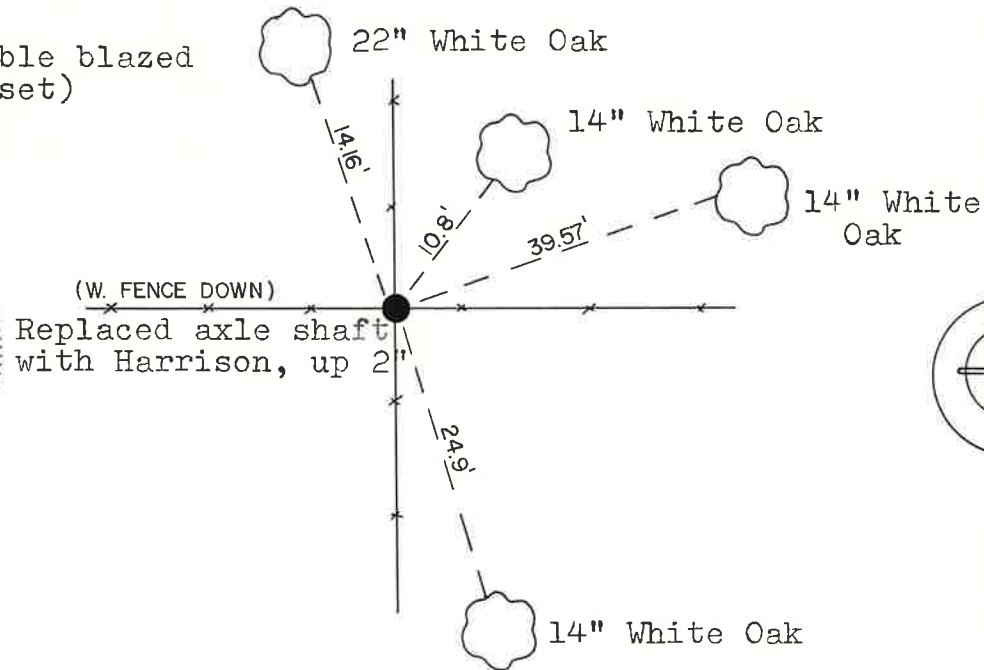
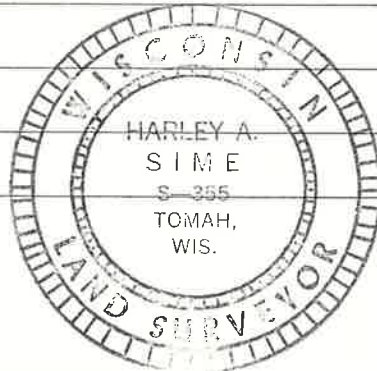

(W. FENCE DOWN)

Replaced axle shaft with Harrison, up 2'

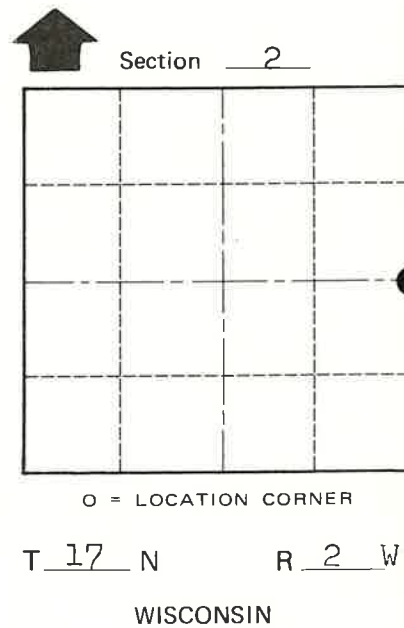

O = LOCATION CORNER

T 17 N R 2 W

WISCONSIN

COUNTY SURVEYOR FORM NO. 1

SURVEY CONTROL ORDER

Horizontal	_____
Vertical	_____

WISCONSIN COORDINATE SYSTEM

Corner	East (X)	North (Y)	Elevation (Z)	Zone
Control Sta. Name				

City, Village or Town Adrian

County of Monroe