

**U.S. PUBLIC LAND CORNER
MAINTENANCE**

33

**Corner ID: NW Sec. 7, T19N-R4W
21905010000**

DATE	CREW	MONUMENT INFO
April 21, 2023	Zachariah P. Dechant Gary L. Dechant	Found Harrison in remnants of fence corner, north side of broken concrete fence corner, 24' south & 12' east of gravel private road intersection. On line with newer fence running north of road, Harrison down 8"
1) Set 5/8"x24" round rebar, 4' SW of 6" White Oak		<u>Bearing</u> <u>Distance</u>
2) Set 5/8"x24" round rebar, 4' NW of 8" White Oak		N30E 62.13'
3) Set 5/8"x24" round rebar, 3' north of 12" White Pine		S42E 42.36'
4) Set 5/8"x24" round rebar, 4' SE of 6" White Pine		S85W 28.24'
		N15W 64.21'

Compass bearings
Trees double blazed

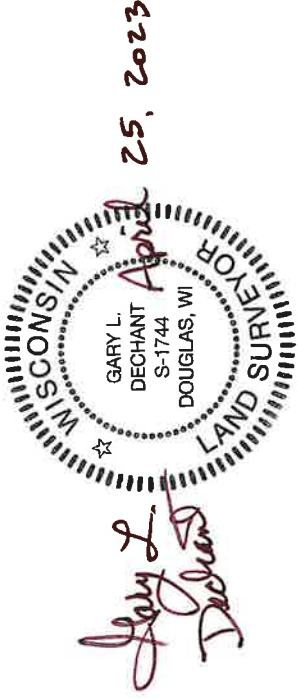

I, Gregory J. Hofmeister, do hereby certify that on the 22nd day of September 1982, I found (evidence) ~~(no evidence)~~ of the Northwest corner of Section 7, T 19 N, R 4 W Fourth Principal Meridian, and I re-established said corner according to the Wisconsin Statutes as shown and described hereon.

Dated this fourth day of October 1982.

Gregory J. Hofmeister

Registered Land Surveyor
Title

History of corner establishment since Original Government Survey

Surveys by Fred Holden in 1904 of Sections 6 and 7 and W. Kenyon in 1886 of Section 7 make no mention of this corner since this work was done in the east half of these sections. There are no other records of surveys in this area.

Description of corner evidence found:

A four inch by four inch concrete post at the corner of fences east and south is said to be the corner of Sections 1, 12, 6, and 7 by Lyle Koehler, the owner of lands north and west of the corner. Distances and bearings to adjacent corners fit reasonably well, therefore I have accepted this location.

See Reverse Side For Maintenance

Description of corner and witness monuments, references and accessories used to perpetuate the original or re-established location of this corner:

Witnesses to corner location:

Gregory J. Hofmeister

Ernest H. Koepe



P-K NAIL WITH SHINER IN SIDE OF 8" WHITE OAK.

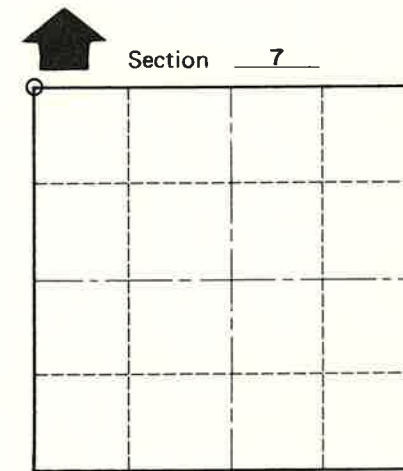
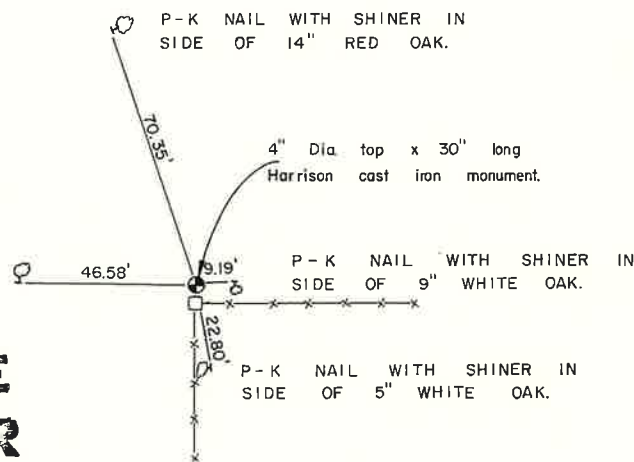

O = LOCATION CORNER

T 19 N R 4 W

WISCONSIN

**Approved: HARLEY A. SIME
MONROE CO. SURVEYOR**

COUNTY SURVEYOR FORM NO. 1

SURVEY CONTROL ORDER

Horizontal _____
Vertical _____

ALL TREES BLAZED FACING CORNER.

WISCONSIN COORDINATE SYSTEM

Corner	East (X)	North (Y)	Elevation (Z)	Zone
Control Sta. Name				

City, Village or Town Little Falls
County of Monroe