

**U. S. Public Land Corner  
Maintenance**

# 20

Corner: E1/4 Sec. 1, T19N-R4W

21904012000

Date	Crew	Monument type
April 6, 2023	Zachariah P. Dechant Gary L. Dechant	Found Stone (+) at remnants of fence corner, downed fencing running south, north and west, Stone(+) leaning north but fits nails in 1981 oak bearing trees. Stone has what appears to be a "u," scribed on south side stone, placed a flat stone in existing pit 6.5' east, set sign 2' south

References:

- 1) Set 5/8"x24" round rebar 7' SW of 12" White Oak
- 2) Set 5/8"x24" round rebar, 7' NE of 8" White Pine
- 3) Set 5/8"x24" round rebar,
- 4) Set 5/8"x24" round rebar, 5' SE of 7" White Pine (1981 BT)

Compass bearings  
Trees double blazed  
Set stone over rebars

Bearing	Distance
N76E	16.20'
S46W	26.24'
N89W	44.13'
N8W	15.59'



I, Harley A. Sime, do hereby certify that on the 4<sup>th</sup> day of November 19 81, I found (evidence) ~~(no evidence)~~ of the East 1/4 corner of Section 1, T 19 N, R 4 W Fourth Principal Meridian, and I re-established said corner according to the Wisconsin Statutes as shown and described hereon.

Dated this 10<sup>th</sup> day of Nov. 19 81.

Harley A. Sime R.L.S. 355

History of corner establishment since Original Government Survey  
 Keach was here in October of 1902. David Blencoe was here in November of 1929 and set a sandstone.

Description of corner evidence found:

Found Keach's sandstone on North side of hill.

**See Reverse Side For Maintenance**

County Surveyor

Approved: **HARLEY A. SIME**  
**MONROE CO. SURVEYOR**

COUNTY SURVEYOR FORM NO. 1

Description of corner and witness monuments, references and accessories used to perpetuate the original or re-established location of this corner:

Witnesses to corner location:

B. Meyer

C. Pietz

Trees Double Blazed With Nail In Lower Blaze

Distances Are Slope Measurements

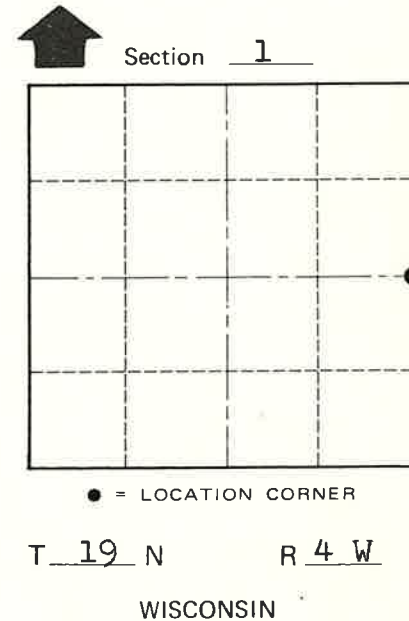
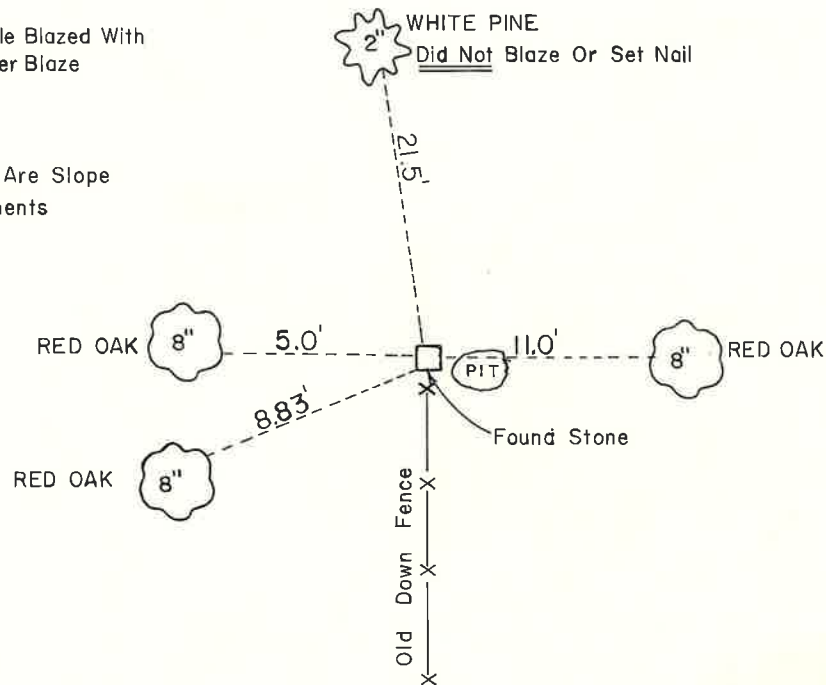

SURVEY CONTROL ORDER

Horizontal	_____
Vertical	_____

WISCONSIN COORDINATE SYSTEM

Corner	East (X)	North (Y)	Elevation (Z)	Zone
Control Sta. Name				

~~City Village or~~ Town Little Falls  
 County of Monroe  
Wisconsin