

**U. S. Public Land Corner
Maintenance**

17

Corner: E1/4 Sec. 4, T19N-R4W

21904042000

<u>Date</u>	<u>Crew</u>	<u>Monument type</u>
March 27, 2023	Zachariah P. Dechant Gary L. Dechant	Found stone with mag nail near center, stone is up 1' from ground level, set sign 2' north, 5" White Oak 3' east portion of stone exposed is 5"x2', scribing in rock ledge to west still visible, but deteriorating and covered with moss

References:

- 1) Set 5/8"x24" round rebar, 6' south of 14" White Oak, (1981 BT)
- 2) Set 5/8"x24" round rebar, 4' SW of White Oak sapling
- 3) Set 5/8"x24" round rebar, 4 NW of White Pine sapling
- 4) Set 5/8"x24" round rebar on south side of large stone

Compass bearings

Trees double blazed

Set stone over rebars at reference markers 1, 2, & 3

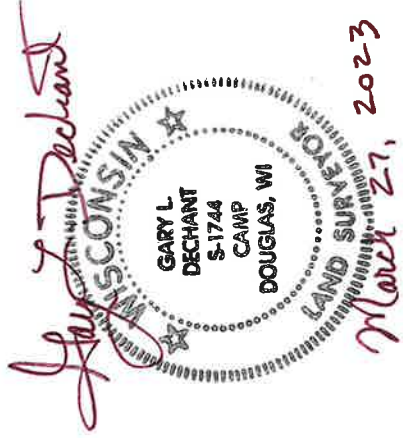

I, Harley A. Sime, do hereby certify that on the tenth day of August 1981, I found ~~evidence (the evidence)~~ of the East 1/4 corner of Section 4, T19 N, R4 W Fourth Principal Meridian, and I re-established said corner according to the Wisconsin Statutes as shown and described hereon.
 Dated this 28th day of Aug. 1981.

Harley A. Sime

Monroe County Surveyor

Approved: **HARLEY A. SIME**

MONROE CO. SURVEYOR

COUNTY SURVEYOR FORM NO. 1

Description of corner and witness monuments, references and accessories used to perpetuate the original or re-established location of this corner:

Note: Trees are double blazed with a nail set in the lower blaze.

Witnesses to corner location:

Bryan H. Meyer - Crew Chief

Carlton R. Pietz

History of corner establishment since Original Government Survey

Keach was here in the early 1900s, and set a stone. Blencoe was here in October of 1949 and could not find Keache's stone. He did, however set another stone. I used this stone in my 1973 survey.

Description of corner evidence found:

Found Blencoes stone and accepted it as the corner.

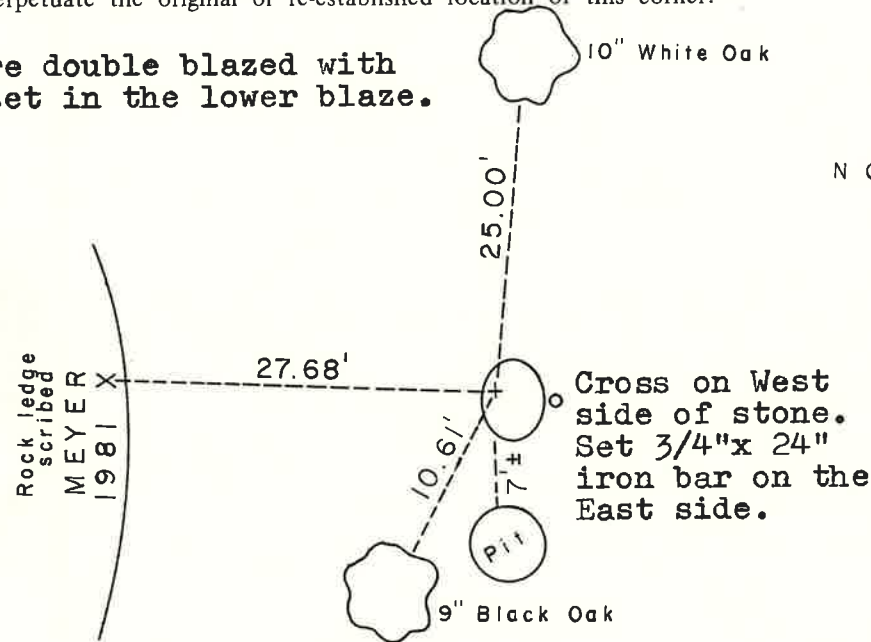

N O R T H

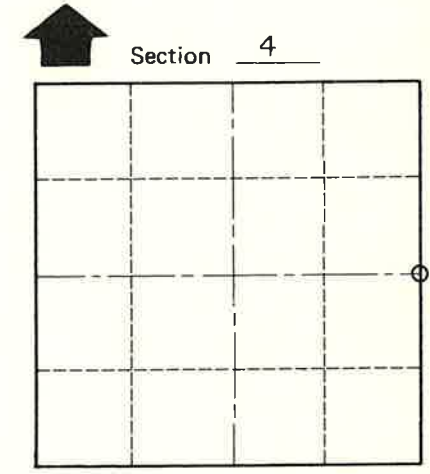

O = LOCATION CORNER

T 19 N R 4 W

WISCONSIN

SURVEY CONTROL ORDER

Horizontal	_____
Vertical	_____

WISCONSIN COORDINATE SYSTEM

Corner	East (X)	North (Y)	Elevation (Z)	Zone
Control Sta. Name				

~~City/Village of~~ Town of Little Falls

County of Monroe

See Reverse Side For Maintenance