

**U. S. Public Land Corner
Maintenance**

91

Corner: SE Sec. 19, T17N-R1W

21701190000

Date	Crew	Monument type
March 24, 2023	Zachariah P. Dechant Gary L. Dechant	Found Harrison at 4-way fence corner, verified by 1975 bearing tree stumps, set sign 1.5' SW

References:

- 1) Set 5/8"x24" round rebar, 4' SW of 11" Maple
- 2) Set 5/8"x24" round rebar in open area
- 3) Set 5/8"x24" round rebar, 9' south of fence
- 4) Set 5/8"x24" round rebar, 4' SE of 8" Hickory

Compass bearings
Trees double blazed

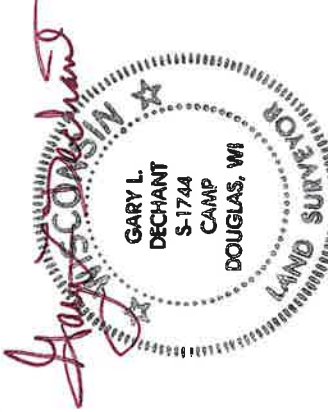

March 25, 2023

I, Harley A. Sime, do hereby certify that on the 21 day of November 1975, I found (evidence) ~~(see witness)~~ the SE corner of Section 19, T 17 N, R 1 W Fourth Principal Meridian, and I re-established said corner according to the Wisconsin Statutes as shown and described hereon.

Dated this 16th day of March 19 77.

Harley A. Sime

County Surveyor
Title

History of original corner establishment:

Holden was at this corner in 1910.

Schroeder was probably at this corner too in April of 1890. Malliet used this corner in a survey of Sept., 1978.

Description of corner evidence found:

Found a 3/4" Iron Bar in strong 4-way fence corner. Set by Jung & Malliet in Summer, 1974. This fits record distance to the west perfectly and fits distance to north. Accepted corner as best available evidence.

July 20, 1979

Crew: Dade and Meyer

Removed existing iron bar and replaced it with a Harrison marker.

Description of corner and witness monuments, references and accessories used to perpetuate the original or re-established location of this corner:

Existing 3/4" Iron Bar NW of large post

Witnesses to corner location:

William C. Jung

Douglas Malliet

August Lueck

Dade & Meyer

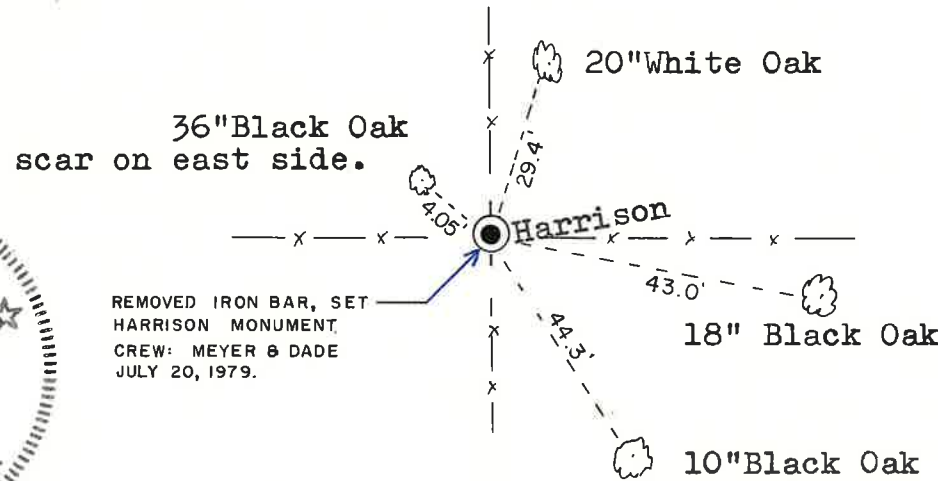
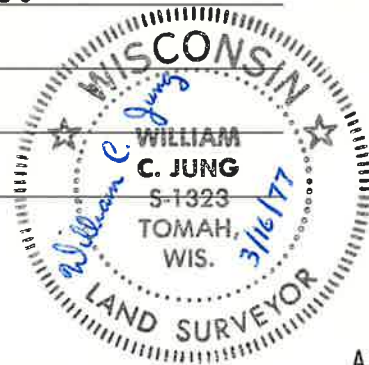

See Reverse Side For Maintenance

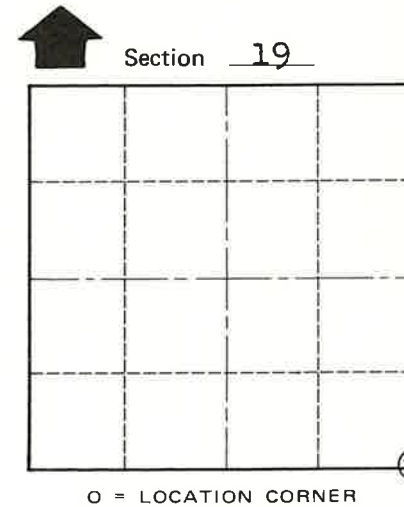

O = LOCATION CORNER

T 17 N R 1 W

WISCONSIN

All Trees blazed and N&C's set.

Approved: **HARLEY A. SIME**
MONROE CO. SURVEYOR

SIGN PLACED 7-13-90 J. Sime

COUNTY SURVEYOR FORM NO. 1

SURVEY CONTROL ORDER

Horizontal	_____
Vertical	_____

WISCONSIN COORDINATE SYSTEM

Corner	East (X)	North (Y)	Elevation (Z)	Zone
Control Sta. Name				

~~City/Town~~ or Town Tomah
County of Monroe