

I, William C. Jung, do hereby certify that on the 17th day of November 19 77, I found (evidence) (~~no evidence~~) of the N.W. corner of Section 9, T19 N, R 1 W. Fourth Principal Meridian, and I re-established said corner according to the Wisconsin Statutes as shown and described hereon.

History of original corner establishment:

O.R. Dahl, County Surveyor, was at this corner in February of 1871.

**See Reverse Side For Maintenance**

Description of corner evidence found:

In February of 1964 H.A. Sime found a rotted 4"x4" hub in the swamp. The origin of this hub is unknown. Later, after traversing Sections 4 and 9, it was found that this corner fits the original government notes very well. Accepted the hub and replaced it with an iron pipe.

Dated this 28th day of Nov. 19 77.

William C. Jung, R.L.S. 1323

Crew Chief, County Surveyor's  
Title Office

COUNTY SURVEYOR FORM NO. 1

Description of corner and witness monuments, references and accessories used to perpetuate the original or re-established location of this corner:

Removed rotted 4" x 4" hub and replaced it with a 2½" x 7' iron pipe, up 1.5', by old steel fence post.

Witnesses to corner location:

W. Jung

C. Pietz

G. Dechant

(All trees double blazed and Nails & Caps set)

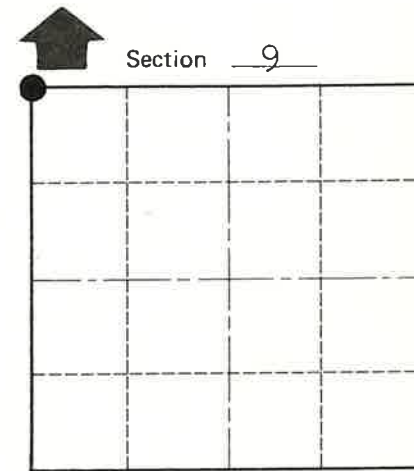
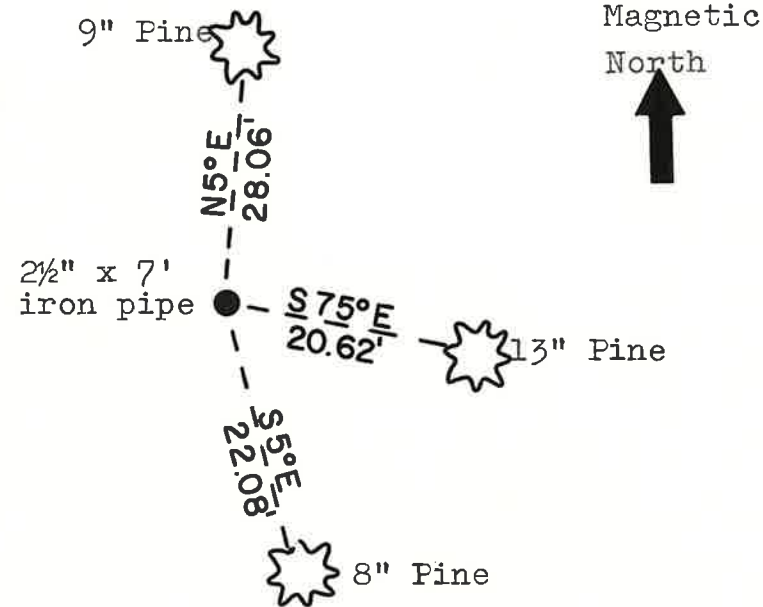
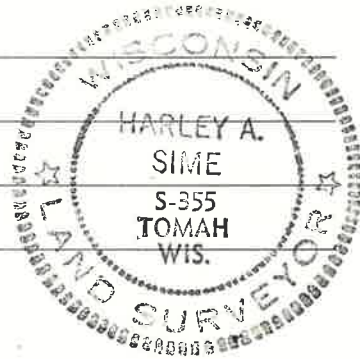

O = LOCATION CORNER

T 19 N R 1 W  
 WISCONSIN

SURVEY CONTROL ORDER

Horizontal	_____
Vertical	_____

Approved: Harley Sime  
 County Surveyor

WISCONSIN COORDINATE SYSTEM

Corner	East (X)	North (Y)	Elevation (Z)	Zone
Control Sta. Name				

City, Village or Town Lincoln  
 County of Monroe

**U. S. Public Land Corner  
Maintenance**

# 29

Corner: NW Sec. 9, T19N-R1W

21901050000

<u>Date</u>	<u>Crew</u>	<u>Monument type</u>
February 10, 2023	Al Hoff Gary L. Dechant	What was swamp when the corner was found in 1964 and in 1977 is now a reservoir. Drilled hole in ice and found water to be 9' deep plus muck. Did get a signal with metal detector. Computed corner based from surveys, forty corners, adjacent PLSS corners. Did not set a new monument.

References:

	<u>Bearing</u>	<u>Distance</u>
1) Set 3/4"x24" round iron bar, in small clump of sapling pine.	S6°30'07"W	318.44'
2) Set 3/4"x24" round iron bar	S14°46'35"W	313.27
3) Set 3/4"x24" round iron bar	S22°40'07"W	305.15'
4) Set 3/4"x24" round iron bar, 7' NE of 6" White Pine	S32°28'17"W	243.28'

Trees double blazed.

