

CERTIFICATE

CERTIFIED LAND CORNER

No. 36B

I, William C. Jung, do hereby certify that on the 6th day of January 1978, I found (evidence) ~~(no evidence)~~ of the C 1/4 corner of Section 9, T19 N, R 1 W Fourth Principal Meridian, and I re-established said corner according to the Wisconsin Statutes as shown and described hereon.

History of original corner establishment:

O.R. Dahl established this corner in an irregular fashion in February of 1871.

Description of corner evidence found:

Surveyed out all of Section 9. Set the corner at the intersection of the 1/4 lines using the existing exterior corners of the section. Found an angle iron to the North of the computed true corner. This may or may not have been Dahl's corner. Decided to use the pipe at the present true corner.

Dated this 10th day of Jan. 1978.

William C. Jung, R.L.S. 1323

Crew Chief, County Surveyor's
Title Office

COUNTY SURVEYOR FORM NO. 1

Description of corner and witness monuments, references and accessories used to perpetuate the original or re-established location of this corner:

Set 2 1/2"x7' iron pipe in swamp, up 18" at true C 1/4.

Witnesses to corner location:

W. Jung

G. Dechant

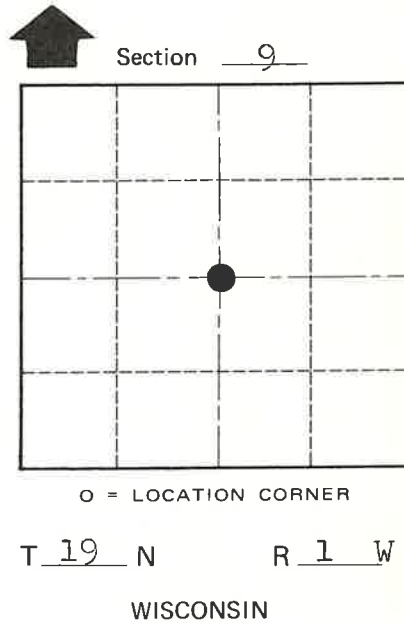
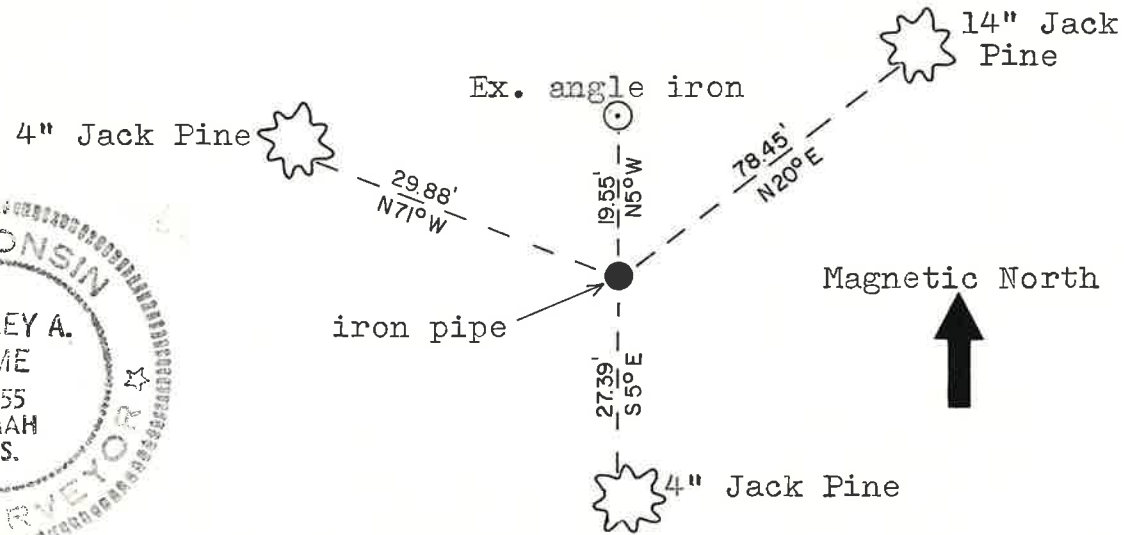
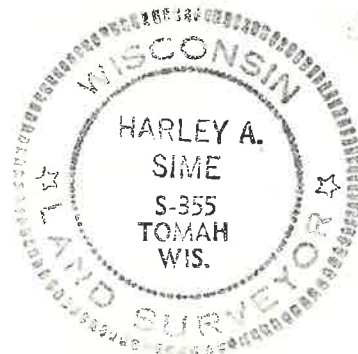

SURVEY CONTROL ORDER

Horizontal	_____
Vertical	_____

Approved: Harley A. Sime
County Surveyor

WISCONSIN COORDINATE SYSTEM

Corner	East (X)	North (Y)	Elevation (Z)	Zone
Control Sta. Name				

(All trees single blazed with N&C's set)

City, Village or Town Lincoln

County of Monroe

**U. S. Public Land Corner
Maintenance**

36 B

Corner: C1/4 Sec. 9, T19N-R1W

21901092020

<u>Date</u>	<u>Crew</u>	<u>Monument type</u>
February 10, 2023	Al Hoff Gary L. Dechant	Found 2- 1/2" iron pipe in swamp, set survey sign 1' north, verified with remaining ties.

<u>References:</u>	<u>Bearing</u>	<u>Distance</u>
1) Set 3/4"x24" round iron bar, 4' south of 4" White Pine	N18°38'00"E	37.24'
2) Set 3/4"x24" round iron bar, 4' NW of 4" White Pine	S53°44'23"E	21.34'
3) Set 3/4"x24" round iron bar, 4' NE 8" White Pine	S60°40'15"W	36.03'
4) Set 3/4"x24" round iron bar, 4' SE of 10" White Pine	N71°20'13"W	29.61'

Trees double blazed.

