

CERTIFICATE

CERTIFIED LAND CORNER

No. 794

21702233000

I, Harley A. Sime, do hereby certify that on the 21 day of November 19 75, I found (evidence) (no evidence) of the W/16-NW/4 corner of Section 24, T 17 N, R 2 W Fourth Principal Meridian, and I re-established said corner according to the Wisconsin Statutes as shown and described hereon.

History of original corner establishment:

O.R.Dahl set this corner in August of 1868.

Description of corner evidence found:

Set "By Law" after running out Section 24

Dated this 5th day of April 19 77.

Approved: HARLEY A. SIME

County Surveyor
Title

MONROE CO. SURVEYOR

COUNTY SURVEYOR FORM NO. 1

Description of corner and witness monuments, references and accessories used to perpetuate the original or re-established location of this corner:

Set 3/4" iron bar.

Witnesses to corner location:

Jung

Malliet

Tueck

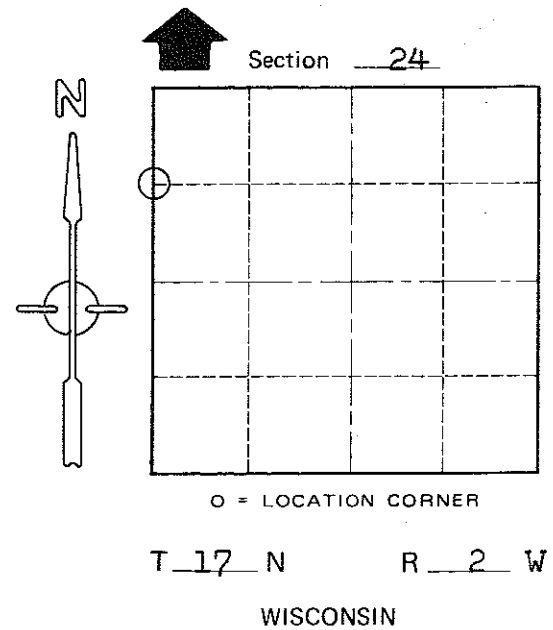
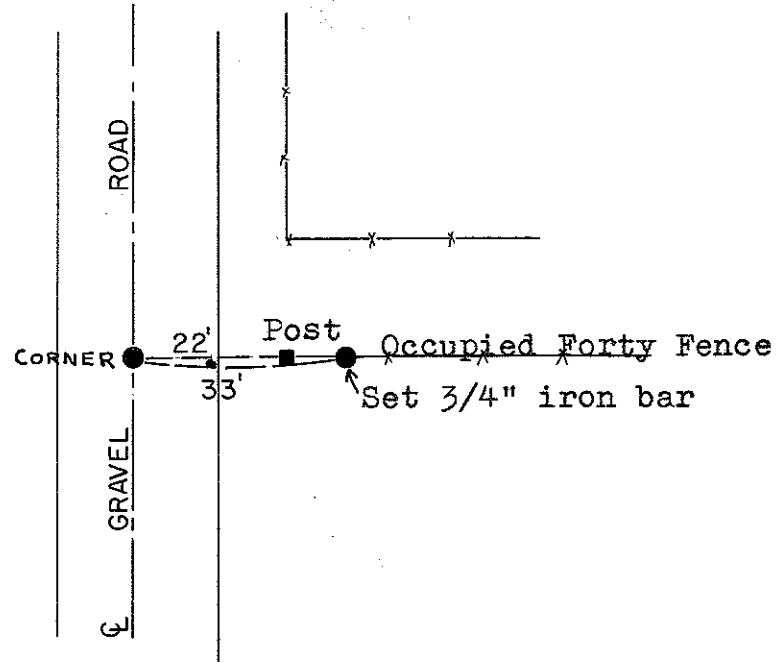
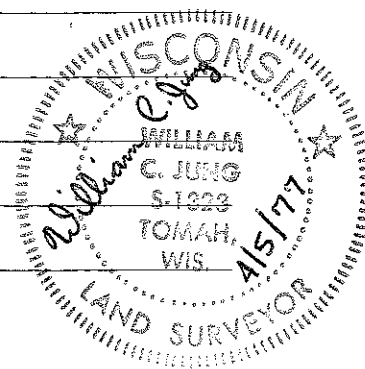

SURVEY CONTROL ORDER

Horizontal	_____
Vertical	_____

WISCONSIN COORDINATE SYSTEM

Corner	East (X)	North (Y)	Elevation (Z)	Zone
Control Sta. Name				

City, Village or Town Adrian

County of Monroe