

MONROE COUNTY  
CERTIFIED U.S. PUBLIC LAND SURVEY MONUMENT RECORD

INSTRUCTIONS: THIS RECORD SHALL SHOW THE LOCATION OF THE CORNER AND SHALL INCLUDE ALL OF THE FOLLOWING ELEMENTS (A-I)

FOUND STANDARD CAST IRON HARRISON MONUMENT AT QUARTER CORNER.

(A) IDENTIFY THE CORNER BY REFERENCE TO THE U.S. PUBLIC LAND SURVEY SYSTEM

■ = CORNER MONUMENT RESTORED

WITNESSES TO CORNER LOCATION:

- 1)
- 2)
- 3)

STATE PLANE COORDINATES (WISCONSIN SOUTH ZONE)  
NORTHING:  
EASTING:

MONROE COUNTY COORDINATES  
NORTHING: WISCAS N 350,398.00 THESE ARE "SURVEY GRADE" COORDINATES.  
EASTING: NADB3(2011) E 715,318.85

(B) DESCRIBE ANY RECORD EVIDENCE, MONUMENT EVIDENCE, OCCUPATIONAL EVIDENCE, TESTIMONIAL EVIDENCE OR ANY OTHER MATERIAL EVIDENCE YOU CONSIDERED, AND WHETHER THE MONUMENT WAS FOUND OR PLACED.

THIS MONUMENT WAS SET BY MONROE CO. SURVEYOR HARLEY SIMME  
BY HIS TIE SHEET DATED 11-11-77. WISDOT HAS A  
LANDMARK SHEET OF IT DATED 5-14-84. MOST RECENT TIE SHEET <sup>GR-2000</sup> 12-29-86.

(C) IN THE PLAN VIEW DRAWING BELOW, PROVIDE REFERENCE TIES TO AT LEAST 4 WITNESS MONUMENTS OR, IF THE LOCATION IS WITHIN A MUNICIPALITY, TO AT LEAST 2 WITNESS MONUMENTS. (WITNESS MONUMENTS SHALL BE MADE OF CONCRETE, NATURAL STONE, IRON, OR OTHER EQUALLY DURABLE MATERIAL.) DESCRIBE WITNESS MONUMENTS.

AZIMUTHS SHOWN ARE MONROE CO. WISCAS NADB3(2011).

(D) SHOW A PLAN VIEW DRAWING, DEPICTING THE RELEVANT MONUMENTS AND REFERENCE TIES, WHICH IS SUFFICIENTLY DETAILED TO ENABLE ACCURATE RELOCATION OF THE CORNER MONUMENT IF IT IS DISTURBED.

KEY



FOUND CAST IRON HARRISON MONUMENT

- SET PILOT HOLE 6" + 1/4" IN WING
- FOUND BRG. DISC B-41-137
- FOUND CHISELED +
- △ FOUND 1/2" DIA. REBAR @ PLW MARK

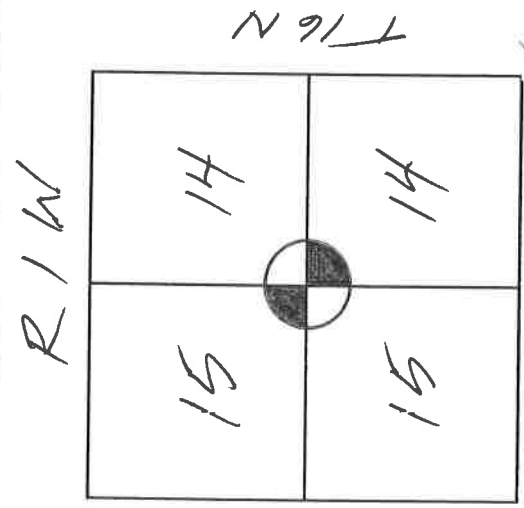
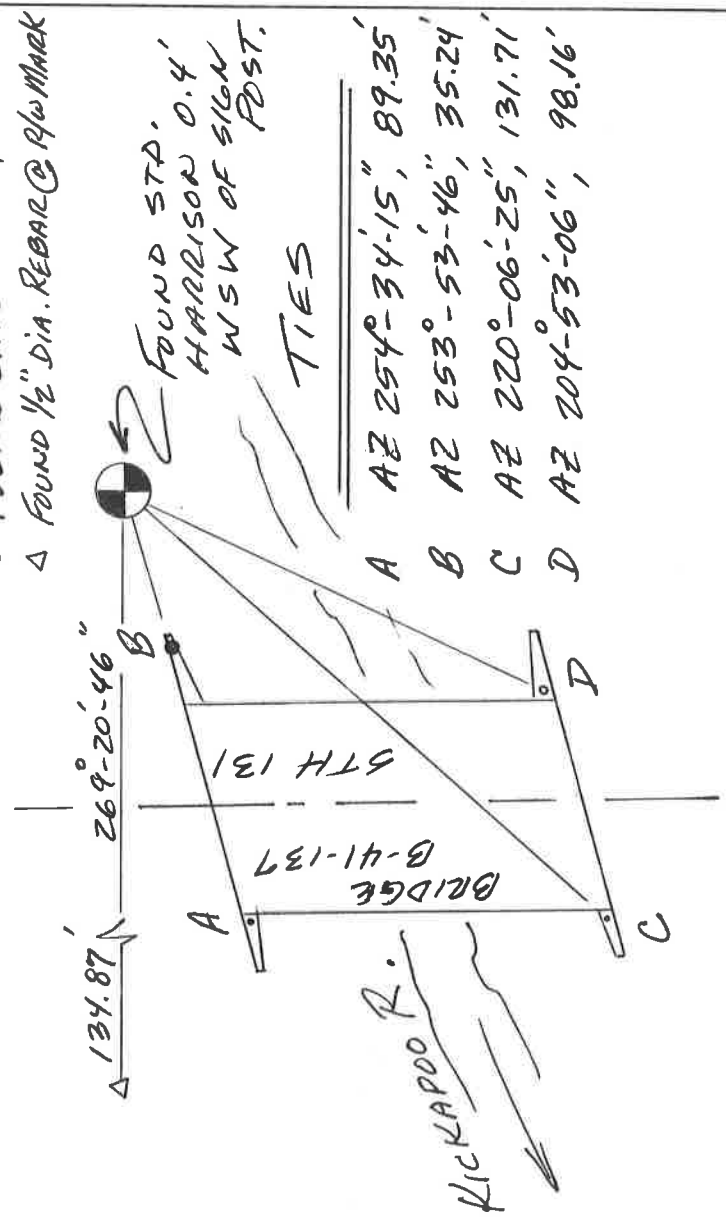

R | W

T 16 N

TOWN OF WILTON

(E) DESCRIBE ANY MATERIAL DISCREPANCY BETWEEN THE LOCATION OF THE CORNER AS RESTORED OR REESTABLISHED AND THE LOCATION OF THAT CORNER AS PREVIOUSLY RESTORED OR REESTABLISHED BY DISTANCE AND DIRECTION. SHOW THE DISCREPANCY ON THE PLAN VIEW DRAWING UNDER (D), ABOVE. SHOW THE DISTANCES BETWEEN THE CORNER AS PREVIOUSLY RESTORED OR REESTABLISHED AND (1) THE CORNER AS RESTORED OR REESTABLISHED, AND (2) TO AT LEAST 2 OF THE WITNESS MONUMENTS AS SHOWN ON THE DRAWING IN (D), ABOVE.

*None.*

(F) WAS THE CORNER RESTORED THROUGH ACCEPTANCE OF (1) AN OBLITERATED EVIDENCE LOCATION, OR (2) A FOUND PERPETUATED LOCATION?

*(2).*

(G & H) WAS THE CORNER REESTABLISHED THROUGH LOST CORNER PROPORTIONATE METHODS? IF SO SHOW THE METHOD, INCLUDING THE DIRECTION AND DISTANCES TO OTHER PUBLIC LAND SURVEY CORNERS USED AS EVIDENCE OR USED FOR PROPORTIONING IN DETERMINING THE CORNER LOCATION.

*No*

(I) I, Greg Faerberach, CERTIFY THAT THE LOCATION SHOWN ON THIS RECORD WAS DETERMINED BY ME OR UNDER MY DIRECTION AND CONTROL AND THAT THIS U.S. PUBLIC LAND SURVEY MONUMENT RECORD IS CORRECT AND COMPLETE TO THE BEST OF MY KNOWLEDGE AND BELIEF.

Gregory A. Faerberach 9-29-22

SIGNATURE

DATE

AFFIX LAND SURVEYOR SEAL

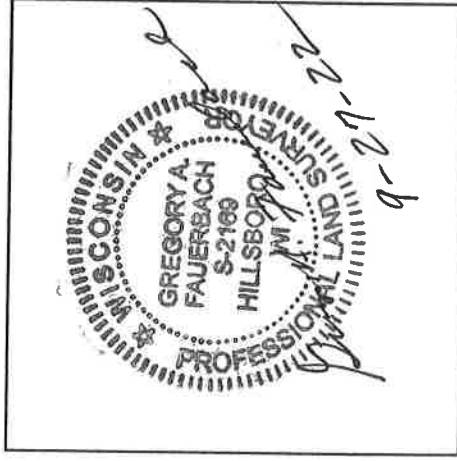

54522

I, Garold A. Sime, do hereby certify that on the 29<sup>th</sup> day of July 19 86, I found (evidence) ~~(no evidence)~~ of the E<sup>1</sup>/<sub>4</sub> Corner corner of Sec. 15, T16 N, R 1 W Fourth Principal Meridian, and I re-established said corner according to the Wisconsin Statutes as shown and described hereon.

Dated this 29<sup>th</sup> day of Dec. 19 86.

Garold A. Sime

Deputy County Surveyor  
Title

History of corner establishment since Original Government Survey

\*See previous land corner record

Description of corner evidence found:

Found Dept. of Transportation ties for corner and remonumented same from these ties.

COUNTY SURVEYOR FORM NO. 1

Description of corner and witness monuments, references and accessories used to perpetuate the original or re-established location of this corner:

Set Harrison Monument at corner

Witnesses to corner location:

Garold A. Sime, R.L.S.

Dallas Wilhite

Joel Tralmer

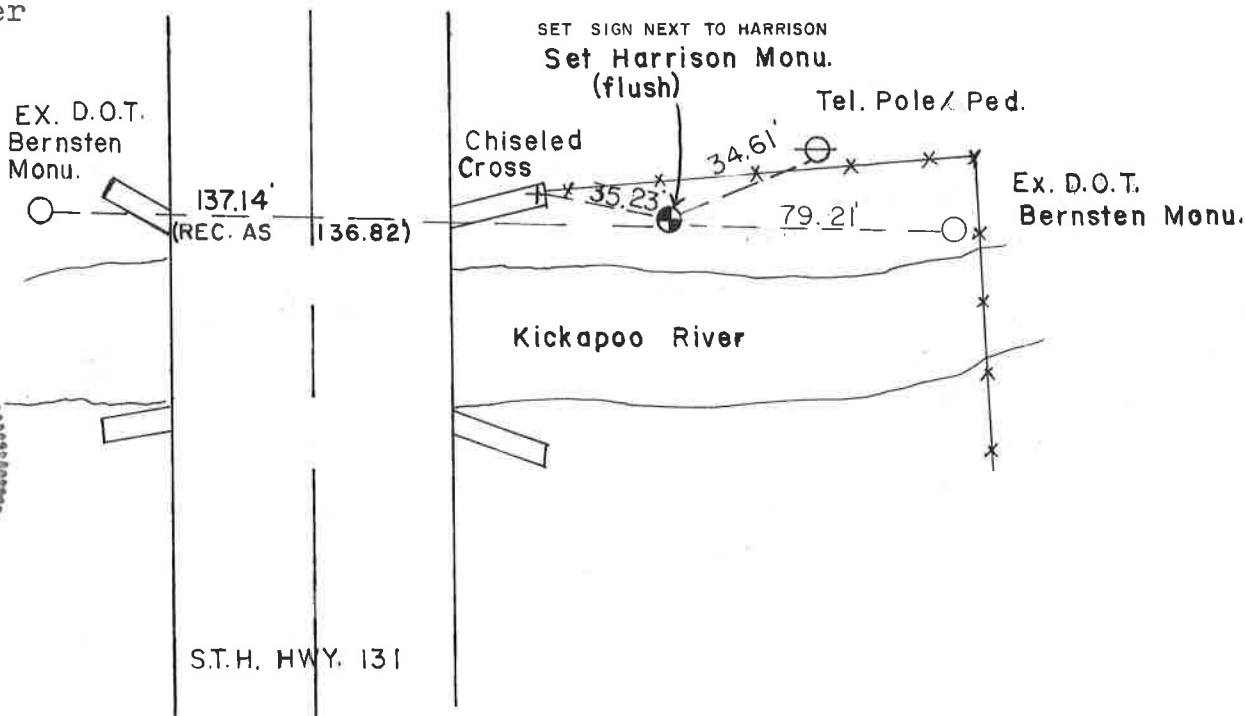
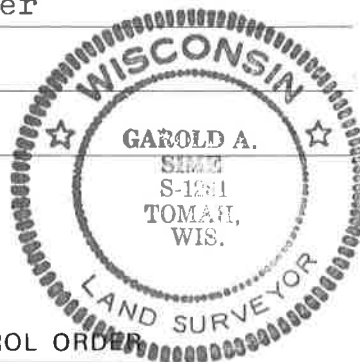

Section 15

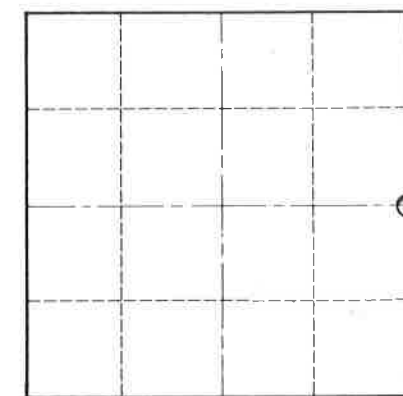

O = LOCATION CORNER

T 16 N R 1 W

WISCONSIN

SURVEY CONTROL ORDER

Horizontal				
Vertical				
Corner	East (X)	North (Y)	Elevation (Z)	Zone
Control Sta. Name				

~~City, Village~~ or Town Wilton

County of Monroe

COUNTY	MONROE		
TOWN	WILTON		
HIGHWAY	S.T.H. 131		
SECTION	TOWNSHIP	RANGE	
14	16 N	1 W	
TYPE OF LANDMARK			
HARRISON MONU IN PLACE			
SET BY MONROE CO. SURVEYOR 1977			

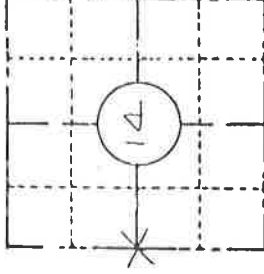

LOCATION SKETCH  
 (Location of landmark indicated by "x")

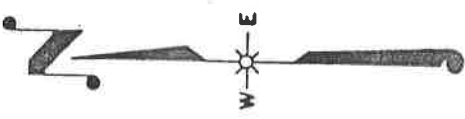

This space for copy of field notes or ties to the above described landmarks

- ⊙ = HARRISON MONU.
  - △ = WIS. D.O.T. BERNSTEN MONU.
- SET ALONG NEW S.T.H. 131 RW

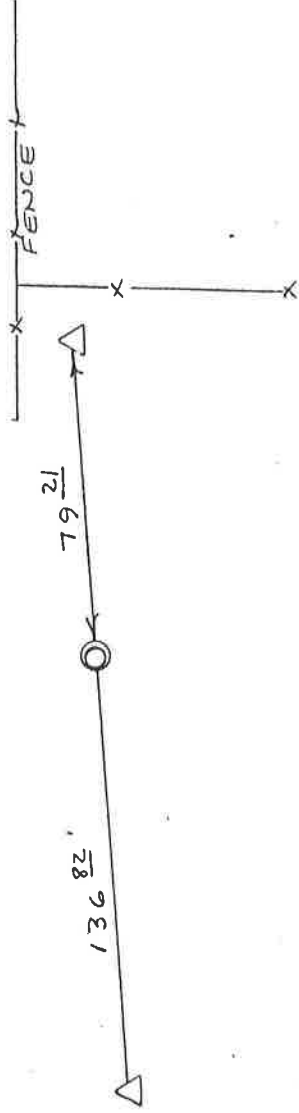

21601152000

CREW CHIEF M. WEGE.

FILED UNDER PROJECT NUMBER	5130-5-72	COUNTY CLERK'S OFFICE	WISCONSIN
SIC DISTRICT OFFICE NUMBER #	5	COUNTY OF	LACROSSE
LOCATED OR ESTABLISHED BY	PERPETUATED	DATE RECEIVED FOR RECORD	DATE COPY SENT TO COUNTY SURVEYOR
NAME	DERALD E. KADING	SIGNATURE OF COUNTY CLERK	
TITLE	SURVEY COORDINATOR		
DATE	5-18-80		

CERTIFICATE

CERTIFIED LAND CORNER

21601152000

No. 58

Page 1

I, William C. Jung, do hereby certify that on the 25th day of October 1977, I found (evidence) (~~no evidence~~) of the W 1/4 corner of Section 14, T 16 N, R 1 W, Fourth Principal Meridian, and I re-established said corner according to the Wisconsin Statutes as shown and described hereon.

History of original corner establishment:

Hamilton La Rue set this corner in January of 1897, and O. R. Dahl also set this corner in June of 1869.

Description of corner evidence found:

Found one of La Rue's bearing trees from his 1897 survey. Reset corner after allowing for tree size and magnetic declination.

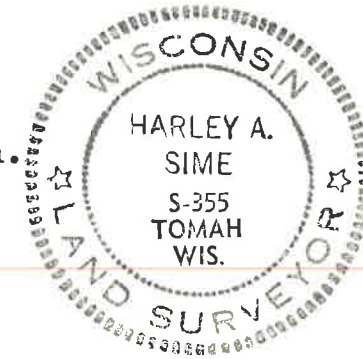

Dated this 11th day of Nov. 1977.

William C. Jung, R.L.S. 1323

Crew Chief, County Surveyor's  
Title Office

COUNTY SURVEYOR FORM NO. 1

Description of corner and witness monuments, references and accessories used to perpetuate the original or re-established location of this corner:

Set a Harrison marker.

Witnesses to corner location:

W. C. Jung

G. Dechant

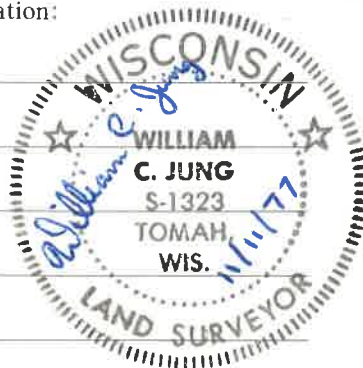

Magnetic North ↑

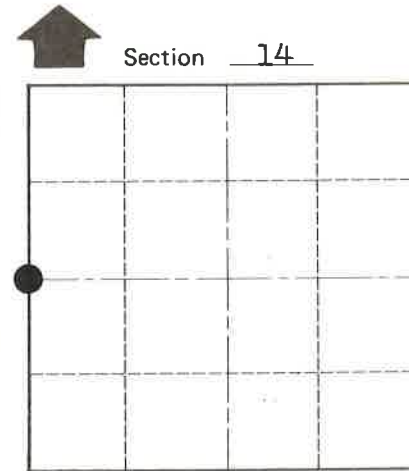
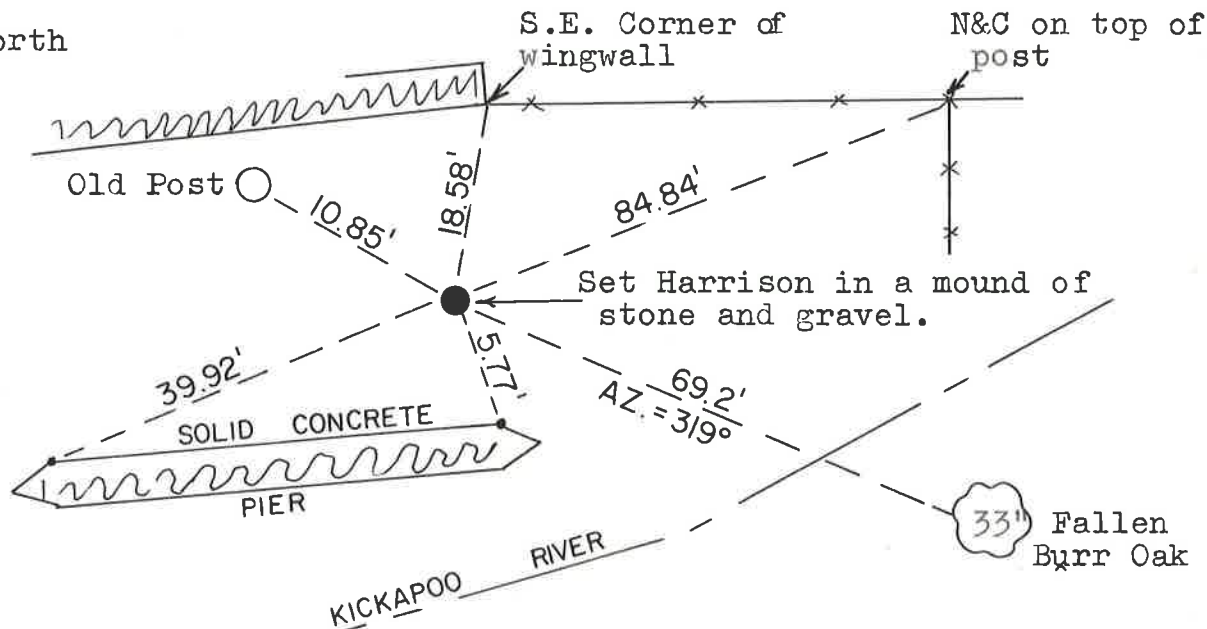

O = LOCATION CORNER

Approved: Harley Sime  
County Surveyor

SURVEY CONTROL ORDER

Horizontal	
Vertical	Scaled Elev.

WISCONSIN COORDINATE SYSTEM

Corner	East (X)	North (Y)	Elevation (Z)	Zone
Control Sta. Name	<u>1875115.246</u>	<u>679687.311</u>	<u>1100 +</u>	<u>SOUTH</u>

City, Village or Town Wilton

County of Monroe