

CERTIFICATE

CERTIFIED LAND CORNER

No. 99c

I, Garold A. Sime, do hereby certify that on the 28th day of July 19 78, I found ~~(evidence)~~ (no evidence) of the CEL/16 corner of Section 25, T 19 N, R 2 W Fourth Principal Meridian, and I re-established said corner according to the Wisconsin Statutes as shown and described hereon.

History of original corner establishment:

No known recorded history since the original government survey.

Description of corner evidence found:

Set as per law after surveying exterior of section

Dated this 11th day of Jan. 19 79.

Garold A. Sime, R.L.S. 1261

Crew Chief, County Surveyor's
Title Office

COUNTY SURVEYOR FORM NO. 1

Description of corner and witness monuments, references and accessories used to perpetuate the original or re-established location of this corner:

Witnesses to corner location:

G. Sime

D. Dade

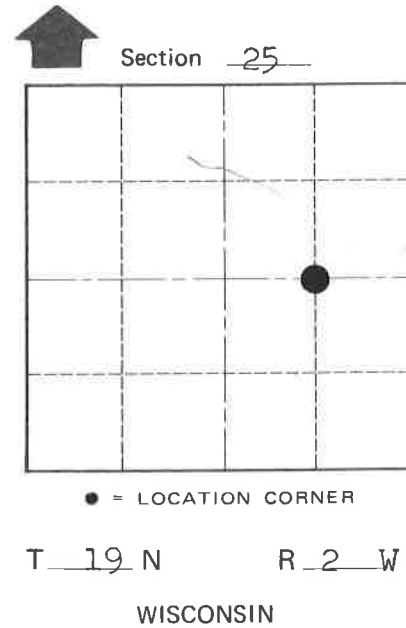
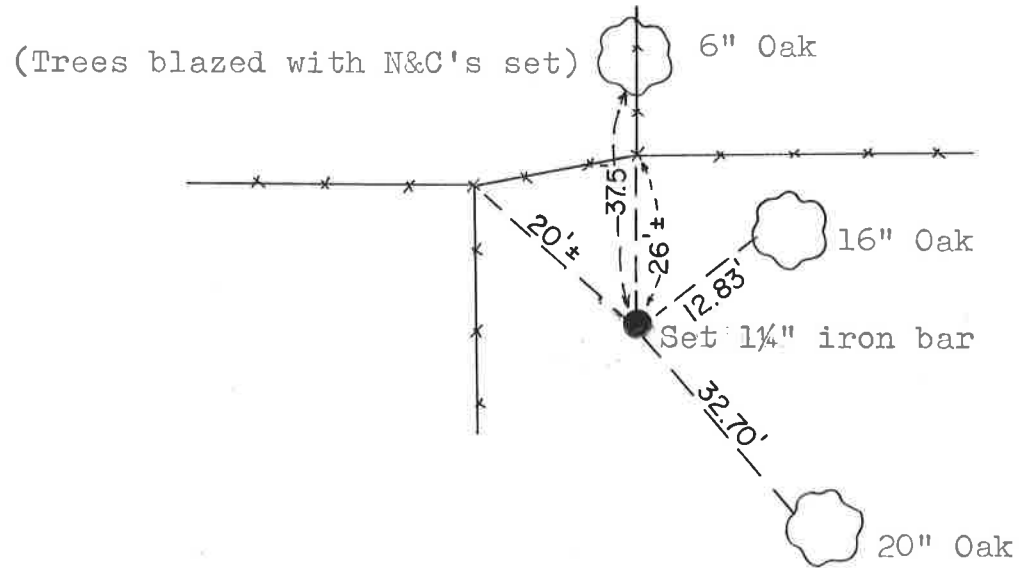

Approved by: Harley A. Sime
County Surveyor

SURVEY CONTROL ORDER

Horizontal _____
Vertical _____

WISCONSIN COORDINATE SYSTEM

Corner	East (X)	North (Y)	Elevation (Z)	Zone
Control Sta. Name				

City, Village or Town Grant

County of Monroe