

**U. S. Public Land Corner
Maintenance**

25

Corner: NW Sec. 11, T16N-R1E

41601030000

<u>Date</u>	<u>Crew</u>	<u>Monument type</u>
June 24, 2022	Zachariah P. Dechant Gary L. Dechant	Found Harrison intact, set new sign

<u>References:</u>	<u>Bearing</u>	<u>Distance</u>
1) Set 1"x24" angle iron in pasture	N60E	36.00'
2) Set 3/4"x24" round iron bar in pasture	S68E	25.17'
3) Set 1" x24" angle iron in pasture	S33E	28.53'
4) Set 3/4"x24" round iron bar in pasture	S22W	32.90'

Compass bearings
Trees double blazed

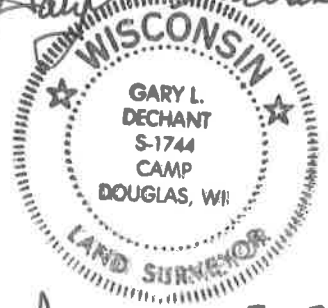
Gary L. Dechant

June 27, 2022

I, Gary L. Dechant, do hereby certify that on the 7th day of May 1993, I found (evidence) (~~no evidence~~) of the NW corner of Section 11, T16 N, R 1 E Fourth Principal Meridian, and I re-established said corner according to the Wisconsin Statutes as shown and described hereon.

Dated this 10th day of May 1993.

Gary L. Dechant
R.L.S. 1744
Title

History of corner establishment since Original Government Survey

No known history since the original government survey.

Description of corner evidence found:

Set corner on line with fence to east and at a distance matching the NW corner of the ~~NE~~-NW. This location fits other section data very well.

See Reverse Side For Maintenance

Description of corner and witness monuments, references and accessories used to perpetuate the original or re-established location of this corner:

Witnesses to corner location:

David E. Madison

Gary L. Dechant

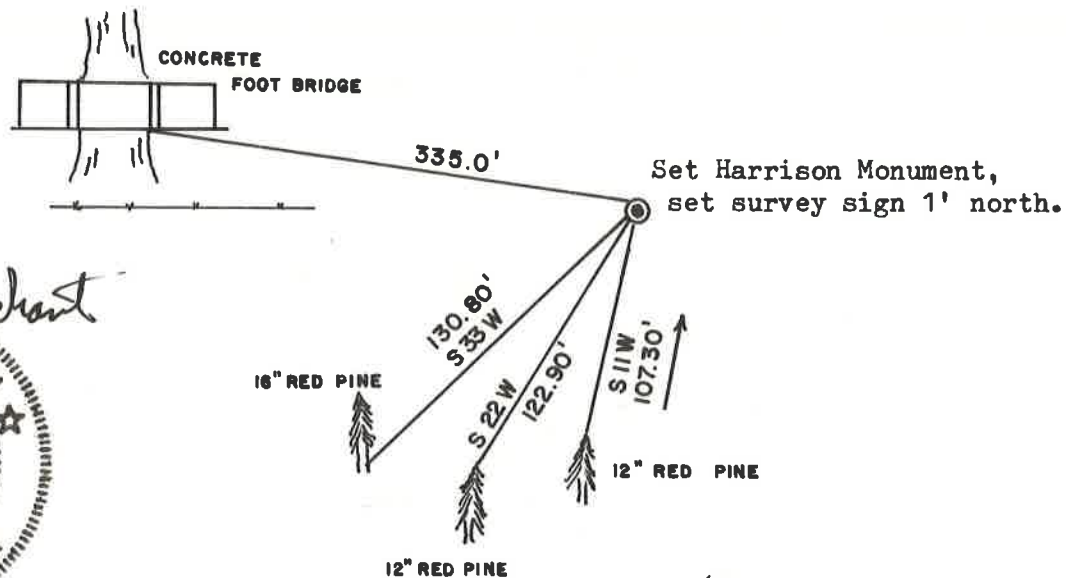

May 10, 1993
WISCONSIN COORDINATE SYSTEM

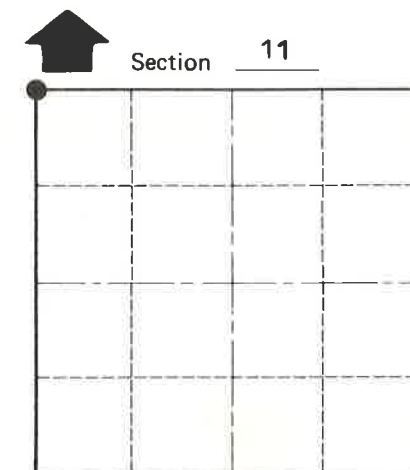

T 16 N R 1 E

WISCONSIN

(Trees double blazed with 20d nail set)

Arrow indicates slope distance & direction of slope.

City, Village or Town Clifton

County of Monroe

COUNTY SURVEYOR FORM NO. 1

SURVEY CONTROL ORDER

Horizontal				
Vertical				
Corner	East (X)	North (Y)	Elevation (Z)	Zone
Control Sta. Name				