

**U. S. Public Land Corner
Maintenance**

24

Corner: N1/4 Sec. 11, T16N-R1E

41601020020

<u>Date</u>	<u>Crew</u>	<u>Monument type</u>
June 23, 2022	Zachariah P. Dechant Gary L. Dechant	Found Harrison intact, at remnants of fence corner, sign 1' west

<u>References:</u>	<u>Bearing</u>	<u>Distance</u>
1) Set 3/4"x24" round iron bar, 6' SW 10" White Pine	N30E	19.17'
2) Set 3/4"x24" round iron bar, 6' NW of 17" White Pine (1993 BT)	S50E	25.16'
3) Set 3/4"x24" round iron bar, 6' NW OF 18" White Pine (1993 BT)	S33E	18.60'
4) Set 3/4"x24" round iron bar, 7' NE of 26" double White Pine (1993 BT)	SW	28.93'
5) Existing chiseled cross in stone ledge (outcrop)	N37E	28.04'

Compass bearings
Trees double blazed

Gary L. Dechant

June 28, 2022

CERTIFICATE

CERTIFIED LAND CORNER

41601020020

No. 24

I, Gary L. Dechant, do hereby certify that on the 7th day of May 1993, I found (evidence) ~~(no evidence)~~ of the N¹/₄ corner of Section 11, T16 N, R1 E Fourth Principal Meridian, and I re-established said corner according to the Wisconsin Statutes as shown and described hereon.

Dated this 10th day of may 1993.

Gary L. Dechant
Reg. Land Surveyor, S-1744
Title

History of corner establishment since Original Government Survey

Fred Holden was here in November of 1906.

See Reverse Side For Maintenance

Description of corner evidence found:

Accepted fence corner as the best available evidence, fits other conditions along the north section line very well.

Description of corner and witness monuments, references and accessories used to perpetuate the original or re-established location of this corner:

Witnesses to corner location:
David E. Madison
Gary L. Dechant

Set TCP monument and survey sign 1' west. Dug small pit N45W, 3'.

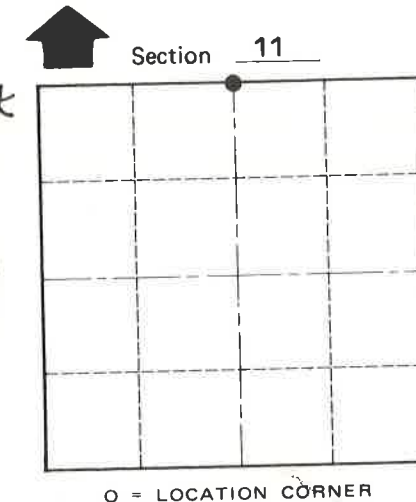
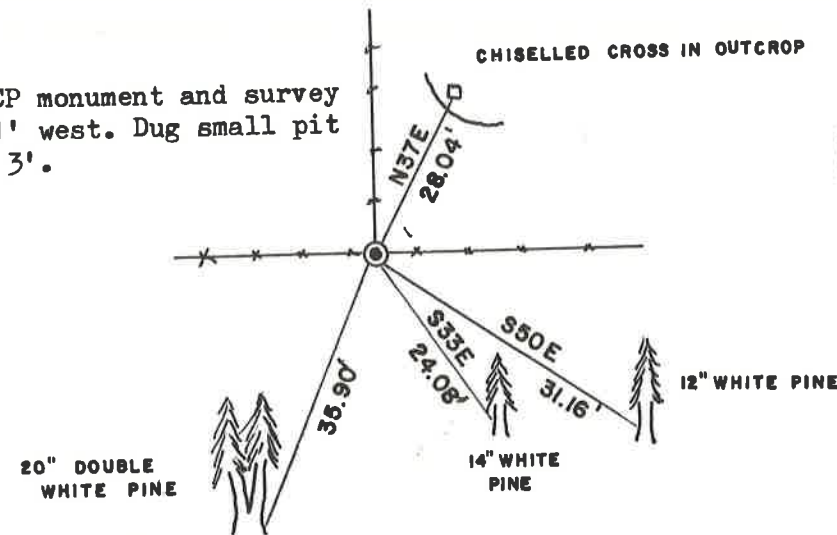

T 16 N R 1 E
WISCONSIN

(Trees double blazed with 20d nail set)

SURVEY CONTROL ORDER

Horizontal _____
Vertical _____

WISCONSIN COORDINATE SYSTEM

Corner	East (X)	North (Y)	Elevation (Z)	Zone
Control Sta. Name				

City, Village or Town Clifton
County of Monroe

COUNTY SURVEYOR FORM NO. 1