

**U.S. Public Land
Survey Monument Record**

16

Corner ID: E1/4 Sec. 5, T19N-R1E

Type of Monument: Set 1 1/4" x 8' round iron bar

41901052000

E 1/4 Corner Sec. 5, T19N-R1E

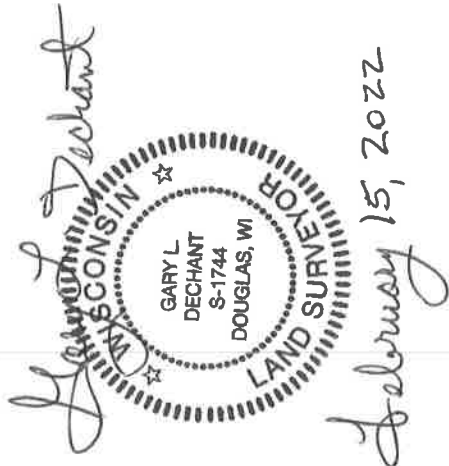
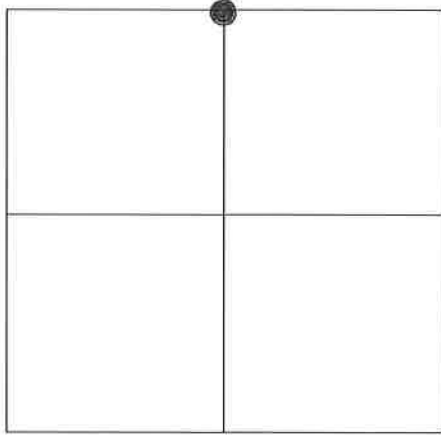

I certify that the U.S. Public Land Survey Monument Record is correct and complete to the best of my knowledge and belief.

Witnesses:

Al Hoff,

Gary Dechant

Basis for Monumentation Location: (show info such as history, evidence, testimony, found or method of location)

Original Government survey was done by George Cole in November of 1851.

No other known history since the original government survey.

Found no evidence of corner. Set corner by proportionate measurement.

● = Set 1 1/4" x 8' round iron bar

Set sign 1' north

○ = Set 3/4" x 24" round iron bar

County coordinate/bearing system

