

**U.S. PUBLIC LAND CORNER  
MAINTENANCE**

**#25**

**Corner ID: NW Sec. 11, T19N-R1E  
41901030000**

<u>DATE</u>	<u>CREW</u>	<u>MONUMENT INFO</u>
February 9, 2022	Zachariah P. Dechant Gary L. Dechant	Replaced deteriorating 1 1/2" iron pipe with 1 1/4"x8' round iron bar. Set sign 1' north. Verified by all three 1982 bearing trees.

	<u>Bearing</u>	<u>Distance</u>
1) Set 3/4"x 24" round iron bar 4' SW of 6" Jack Pine	N78E	48.71'
2) Set 3/4"x 24" round iron bar 4' NW of 18" double Maple (1982 BT)	S35E	110.20'
3) Set 3/4"x24" round iron bar 4' NE of 8" White Pine	S3W	77.18'
4) Set 3/4"x24" round iron bar 4' SE of 5" White Pine	N53W	55.71'

Compass bearings  
Trees double blazed

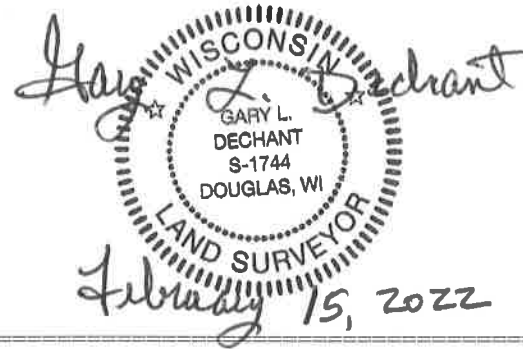

41901030000

I, William C. Jung, do hereby certify that on the 23rd day of February 1982, I found (evidence) ~~(evidence)~~ of the NW corner of Section 11, T19 N, R 1 E Fourth Principal Meridian, and I re-established said corner according to the Wisconsin Statutes as shown and described hereon.

History of corner establishment since Original Government Survey

In his survey notes of September of 1903, Fred Holden shows an iron pipe at this corner. In March of 1937 S. L. Kennedy found the remains of Holden's pipe and replaced it with a new pipe and called for a new B.T., 12" Jack Pine, S61.5°E, 151.14'.

Description of corner evidence found:

Found Kennedy's pipe and ties were taken. It did not seem to have been disturbed even though the distance to Kennedy's bearing tree was off some.

See Reverse Side For Maintenance

Approved: HARLEY A. SIME  
MONROE CO. SURVEYOR

Dated this 18th day of March 1982.

William C. Jung, R.L.S. 1323

County Surveyor's Office

*William C. Jung*

Description of corner and witness monuments, references and accessories used to perpetuate the original or re-established location of this corner:

Witnesses to corner location:

W. Jung

B. Meyer

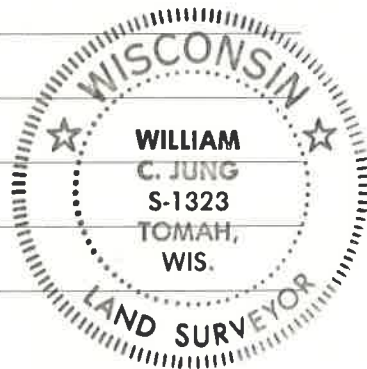

(All trees double blazed, nail in lower blaze)

10" WHITE PINE (TO LOWER BLAZE)

N56W  
137.58'

Out in marsh, Found 1 1/2"x4 3/2" iron pipe, drove down, left up 6".

152.6' (TO BLAZE)  
S64E

FOUND DEAD JACK PINE WITH SCAR

SCAR

S35E  
114.88'

6" DOUBLE MAPLE (TO LOWER BLAZE)

10" NORWAY (TO LOWER BLAZE)

S15W  
153.22'

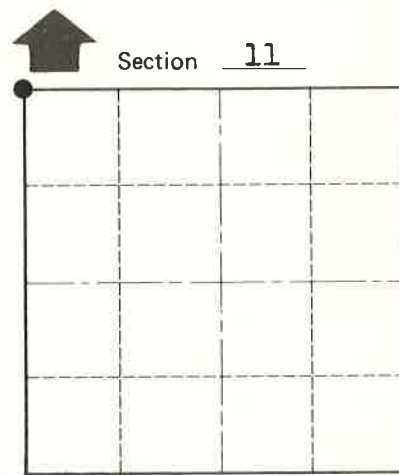

● = LOCATION CORNER

T 19 N R 1 E  
WISCONSIN

SURVEY CONTROL ORDER

Horizontal \_\_\_\_\_  
Vertical \_\_\_\_\_

WISCONSIN COORDINATE SYSTEM

Corner	East (X)	North (Y)	Elevation (Z)	Zone
Control Sta. Name				

City, Village or Town Scott  
County of Monroe

COUNTY SURVEYOR FORM NO. 1