

**U.S. PUBLIC LAND CORNER
MAINTENANCE**

#51

**Corner ID: NW Sec. 17, T16N-R1E
41601070000**

<u>DATE</u>	<u>CREW</u>	<u>MONUMENT INFO</u>
February 11, 2022	Zachariah P. Dechant Gary L. Dechant	Found Harrison intact at fence corner. Verified by 1980 bearing tree, Maple 70.48' SE. Old sign post ½' south. At fence corner. Newer power poles in place.
		<u>Bearing</u> <u>Distance</u>
		1) Set 3/4"x 24" round iron bar down 10" N44E 24.40'
		2) Set 3/4"x 24" round iron bar 7' NW of 9" Maple S40E 98.22'
		3) Set 3/4"x 24" round iron bar 4' NW of 12" Maple S25E 85.66'
		4) Set 3/4"x 24" round iron bar 5' SE of 16" White Pine N44W 87.04'

Compass bearings
Trees double blazed

Gary L. Dechant
WISCONSIN
GARY L.
DECHANT
S-1744
DOUGLAS, WI
LAND SURVEYOR
February 15, 2022

I, Harley A. Sime, do hereby certify that on the 27th day of March 1980, I found (evidence) ~~(no evidence)~~ of the N.W. corner of Sec 17, T16 N, R 1 E, Fourth Principal Meridian, and I re-established said corner according to the Wisconsin Statutes as shown and described hereon.

Dated this 8th day of April 1980.

Harley A. Sime R.L.S. 355

County Surveyor

History of original corner establishment:

No known history since the original government survey.

Description of corner evidence found:

Accepted the fence corner as best available evidence.

See Reverse Side For Maintenance

Description of corner and witness monuments, references and accessories used to perpetuate the original or re-established location of this corner:

Witnesses to corner location:

G. Dechant

C. Dade

T. Tormoen

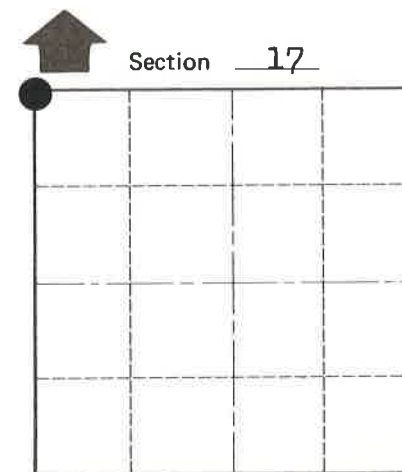
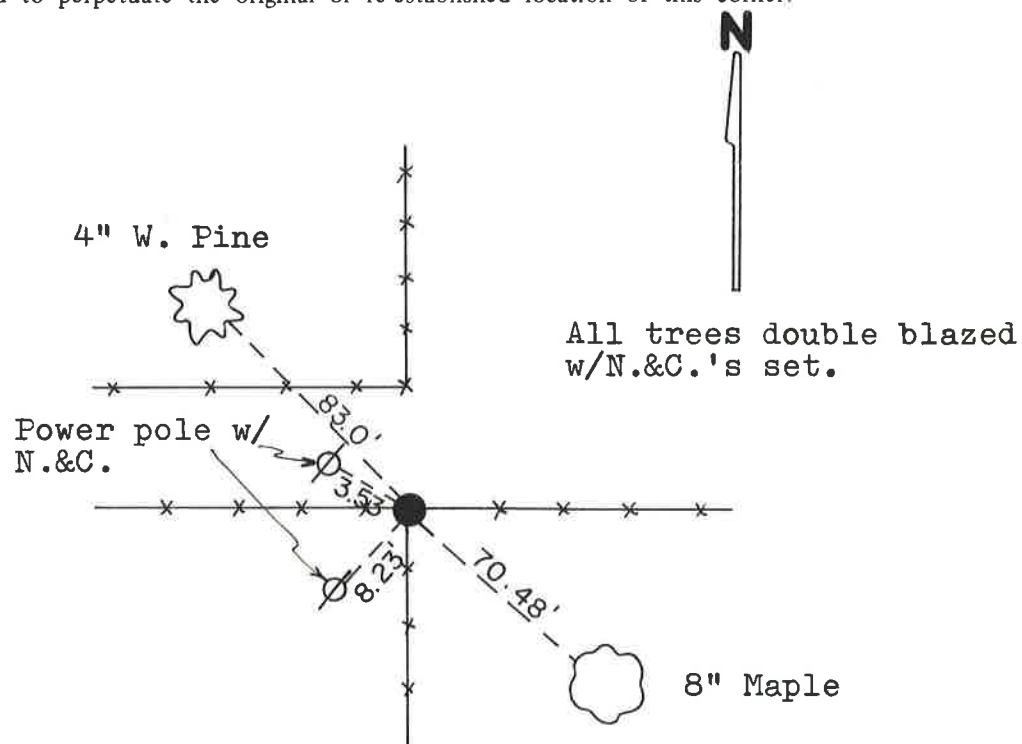

O = LOCATION CORNER

T 16 N R 1 E

WISCONSIN

Approved: **HARLEY A. SIME**
MONROE CO. SURVEYOR

SURVEY CONTROL ORDER

Horizontal	_____
Vertical	_____

WISCONSIN COORDINATE SYSTEM

Corner	East (X)	North (Y)	Elevation (Z)	Zone
Control Sta. Name				

City, Village or Town Clifton

County of Monroe

COUNTY SURVEYOR FORM NO. 1