

21902120000

I, Harley A. Sime, do hereby certify that on the 24th day of March 1981, I found (evidence) (~~was~~) of the NW corner of Section 18, T 19 N, R 1 W Fourth Principal Meridian, and I re-established said corner according to the Wisconsin Statutes as shown and described hereon.

Dated this 15th day of June 1981.

Harley A. Sime, R.L.S. 355

County Surveyor

Title

History of corner establishment since Original Government Survey

Fred Holden was here in May and April of 1902.  
A. S. Ingalls was here in April of 1873.  
D. Blencoe set a stone here.

Description of corner evidence found:

We could not find Blencoe's stone; therefore accepted the fence corner as the best available evidence as it fits other field evidence well.

COUNTY SURVEYOR FORM NO. 1

Description of corner and witness monuments, references and accessories used to perpetuate the original or re-established location of this corner:

Witnesses to corner location:

G. Dechant

B. Meyer

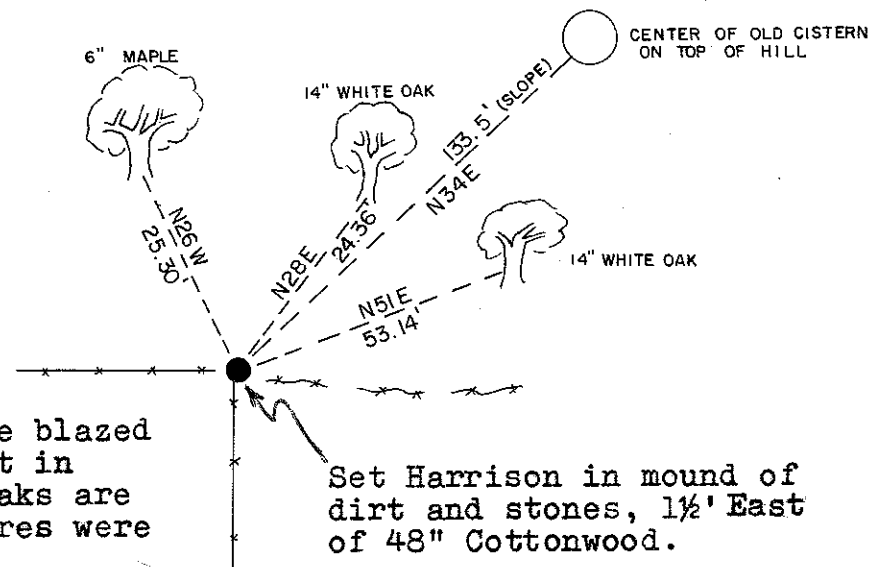

All trees are double blazed with R.R. spikes set in lower blaze. Both Oaks are scribed "BM"; pictures were taken.

Set Harrison in mound of dirt and stones, 1 1/2' East of 48" Cottonwood.

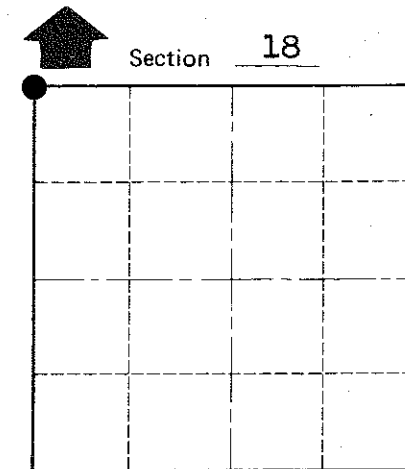

• = LOCATION CORNER

T 19 N R 1 W

WISCONSIN

Approved: **HARLEY A. SIME**  
**MONROE CO. SURVEYOR**

SURVEY CONTROL ORDER

Horizontal	_____
Vertical	_____

WISCONSIN COORDINATE SYSTEM

Corner	East (X)	North (Y)	Elevation (Z)	Zone
Control Sta. Name				

City, Village or Town Lincoln

County of Monroe