

21805240000

I, Gary L. Dechant, do hereby certify that on the 6th day of March 1984, I found (evidence) (no evidence) of the NW corner of Section 30, T 18 N, R 4 W Fourth Principal Meridian, and I re-established said corner according to the Wisconsin Statutes as shown and described hereon.

Dated this 8th day of March 1984.

Gary L. Dechant

Registered Land Surveyor, S-1744 Title

History of corner establishment since Original Government Survey

Fred Holden, in April of 1899, was here at this corner and lists two bearing trees in his notes.

Description of corner evidence found:

Accepted fence corner as best evidence as it fits the original government notes distance to the N 1/4 corner within 1'+ and fits conditions to the south very well also.

Approved: HARLEY A. SIME MONROE CO. SURVEYOR

Description of corner and witness monuments, references and accessories used to perpetuate the original or re-established location of this corner:

Witnesses to corner location:

Lawrence A. Feddersen S-1226

Gary L. Dechant

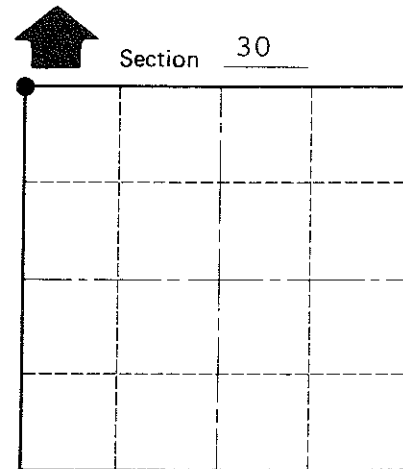
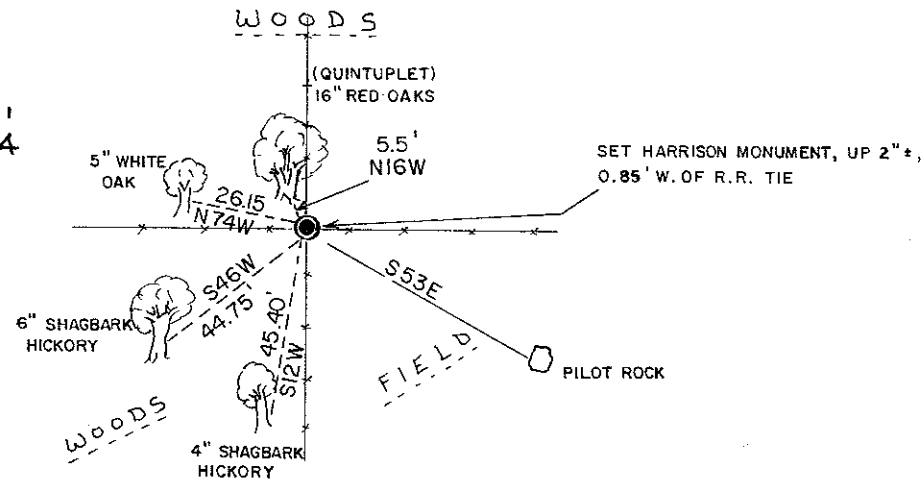
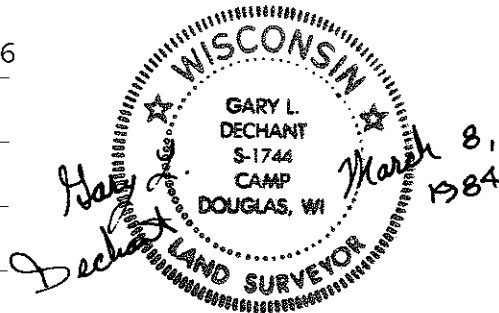

Section 30, T 18 N, R 4 W, WISCONSIN

SURVEY CONTROL ORDER

Table with 2 rows: Horizontal, Vertical

WISCONSIN COORDINATE SYSTEM

Table with 5 columns: Corner, East (X), North (Y), Elevation (Z), Zone

(Trees double blazed, scribed, and with N&C's set)

City, Village or Town Sparta, County of Monroe

COUNTY SURVEYOR FORM NO. 1