

**U.S. PUBLIC LAND CORNER  
MAINTENANCE**

**#101**

**Corner ID: SE Sec. 25, T19N-R1E  
41901250000**

<u>DATE</u>	<u>CREW</u>	<u>MONUMENT INFO</u>	
February 4, 2022	Zachariah P. Dechant Gary L. Dechant	Found Harrison Monument, down 6", in center of north-south trail, set sign 12' west.	
		<u>Bearing</u>	<u>Distance</u>
		N38E	49.75'
		S86E	37.60'
		S58W	24.73'
		N49W	34.43'
		N49W	47.10'

- 1) Set 3/4"x24" round iron bar 4' SW of 10" White Oak
- 2) Set 3/4"x24" round iron bar 4' NW of 6" White Oak
- 3) Set 3/4"x24" round iron bar 4' NE of 12" Maple
- 4) Set 3/4"x24" round iron bar 4' SE of 3" White Pine
- 5) 15" Oak, 1982 bearing tree

Compass bearings  
Trees double blazed

*Gary L. Dechant*  
GARY L. DECHANT  
S-1744  
DOUGLAS, WI  
LAND SURVEYOR  
*February 8, 2022*

I, William C. Jung, do hereby certify that on the 13th day of May, 1982, I found ~~evidence~~ (no evidence) of the SE corner of Section 25, T19 N, R 1 E Fourth Principal Meridian, and I re-established said corner according to the Wisconsin Statutes as shown and described hereon.

Dated this 21st day of Feb., 1983.

William C. Jung  
Deputy County Surveyor  
Title

History of corner establishment since Original Government Survey

No history recorded since the original government survey.

Description of corner evidence found:

There used to be a capped pipe at this corner, but D.N.R. employees told me on 5/12/82 that the pipe was knocked out by "mossers". I found the pipe West of the trail and in a pile of earth where it had been pushed by a bulldozer. I set the corner by single proportionate measurement using the SE of Section 36 and the E1/4 of Section 25 as my points of termination.



Description of corner and witness monuments, references and accessories used to perpetuate the original or re-established location of this corner:

Witnesses to corner location:

William Jung  
Gary Dechant

Approved: **HARLEY A. SIME**  
**MONROE CO. SURVEYOR**

Note: All bearing trees are double blazed with each distance to a nail in a blaze on the side of the tree.

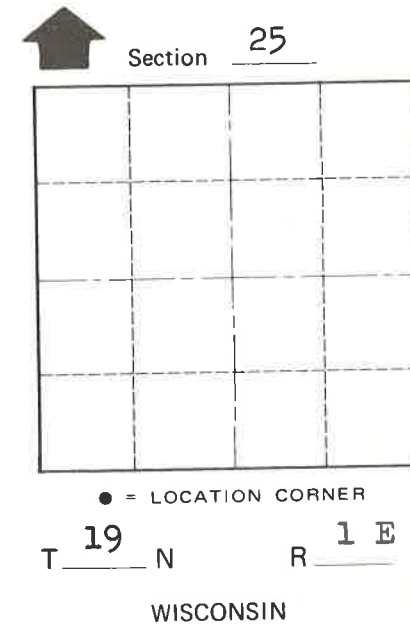
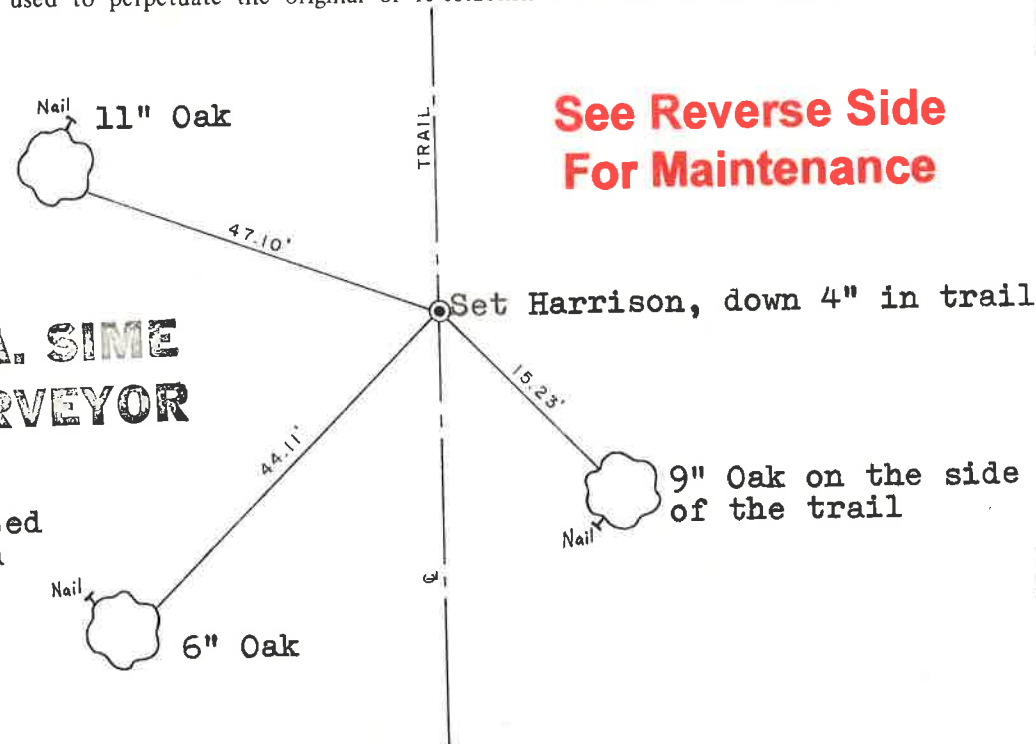

SURVEY CONTROL ORDER

Horizontal	_____
Vertical	_____

WISCONSIN COORDINATE SYSTEM

Corner	East (X)	North (Y)	Elevation (Z)	Zone
Control Sta. Name				

City, Village or Town Scott  
County of Monroe