

**U.S. PUBLIC LAND CORNER  
MAINTENANCE**

**#120**

**Corner ID: E1/4 Sec. 36, T19N-R1E**

**41901362000**

<u>DATE</u>	<u>CREW</u>	<u>MONUMENT INFO</u>		
January 6, 2022	Zachariah P. Dechant Gary L. Dechant	Found 2 1/4" iron pipe, 55' south of south edge of open swamp Juneau County Forestry signs 3' north & 3' east	<u>Bearing</u>	<u>Distance</u>
		1) Set 3/4"x24" round iron bar 4' SW of 6" White Pine	N17E	20.05'
		2) Set 3/4"x24" round iron bar 4' west of 5" White Oak	N85E	27.13
		3) Set 3/4"x24" round iron bar 6' NE of 8" White Pine	S53W	37.84'
		4) Set 3/4"x24" iron bar 4' SE of 10" White Pine	N70W	31.14'

Compass bearings  
Trees double blazed

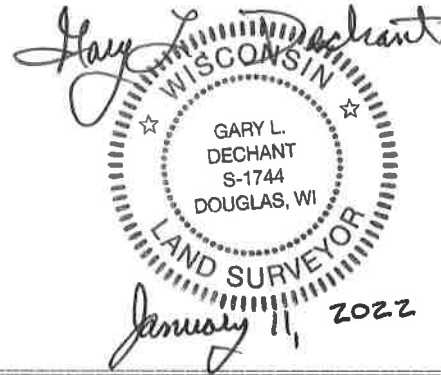

I, William C. Jung, do hereby certify that on the 13th day of May 1982, I found ~~(no evidence)~~ East 1/4 corner of Section 36, T19 N, R 1 E Fourth Principal Meridian, and I re-established said corner according to the Wisconsin Statutes as shown and described hereon.

Dated this 22nd day of Feb. 1983.

William C. Jung  
Deputy County Surveyor  
Title

History of corner establishment since Original Government Survey

No history recorded since the original government survey.

Description of corner evidence found:

I set the corner by single proportionate measurement, using the SE of Section 36 and the E1/4 of Section 25 as my points of termination. I searched the area extensively for an unrecorded monument like those I found to the North, but I found nothing.

**See Reverse Side For Maintenance**

Description of corner and witness monuments, references and accessories used to perpetuate the original or re-established location of this corner:

Witnesses to corner location:

William Jung

Gary Dechant

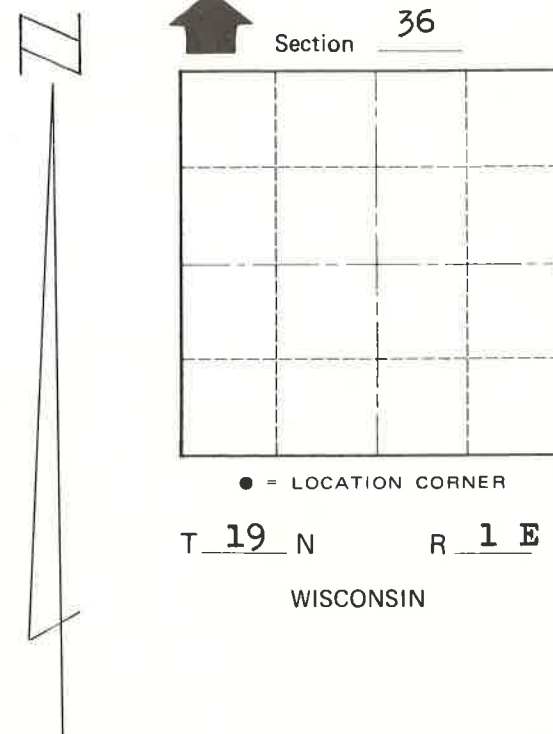
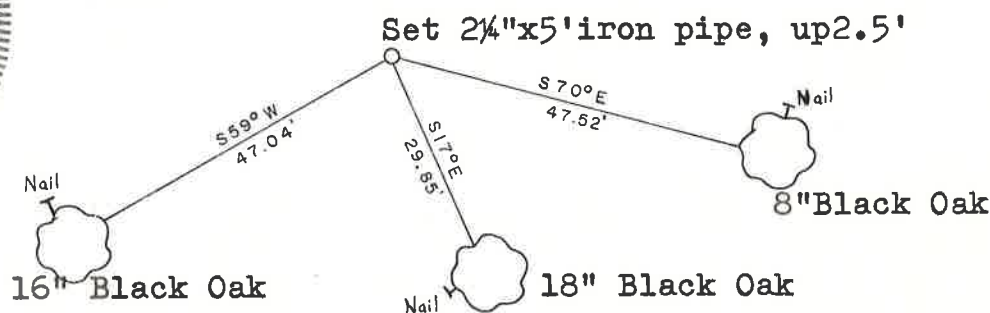

**Approved: HARLEY A. SIME**  
**MONROE CO. SURVEYOR**

SURVEY CONTROL ORDER

Horizontal	_____
Vertical	_____

WISCONSIN COORDINATE SYSTEM

Corner	East (X)	North (Y)	Elevation (Z)	Zone
Control Sta. Name				

Note: All bearing trees are double blazed with each distance to a nail in a blaze on the side of the tree.

~~City, Village or~~ Town Scott  
County of Monroe