

**U.S. PUBLIC LAND CORNER
MAINTENANCE**

#100

Corner ID: E1/4 Sec. 25, T19N-R1E

41901250000

<u>DATE</u>	<u>CREW</u>	<u>MONUMENT INFO</u>	
January 5, 2022	Zachariah P. Dechant Gary L. Dechant	Found 2" capped iron pipe most likely set by Kennedy in the 1930's. On west edge of open swamp, 225' south of centerline of road, set sign 1' north.	
		<u>Bearing</u>	<u>Distance</u>
1) Set 1 1/4"x4' round iron bar in swamp		East	25.68'
2) Set 3/4"x24" round iron bar 4' NE of 18" White Pine		S48W	102.88'
3) Set 3/4"x24" round iron bar 4' SE of 16" Black Oak (1982 BT)		N75W	35.06'
4) Set 3/4"x24" iron bar 4' SE of 4" Black Oak		N15W	93.52'

Compass bearings
Trees double blazed

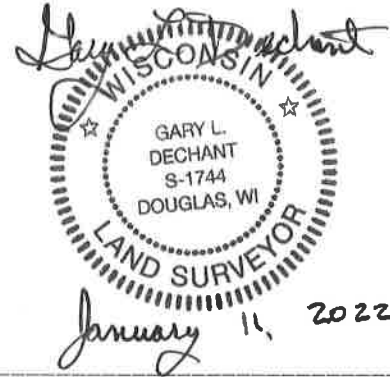

I, William C. Jung, do hereby certify that on the 8th day of March 19 82, I found (evidence) (~~was~~) of the E¹/₄ corner of Section 25, T 19 N, R 1 E Fourth Principal Meridian, and I re-established said corner according to the Wisconsin Statutes as shown and described hereon.

Dated this 18th day of March 19 82.

William C. Jung, R.L.S. 1323

County Surveyor's Office

William C. Jung

History of corner establishment since Original Government Survey
 In October of 1969 Fred Zietlow found a pipe at this corner.

Description of corner evidence found:

I found an unrecorded pipe which I accepted as the 1/4 corner. Its location fits my Town Line measurements to the South and North very well.

See Reverse Side For Maintenance

Description of corner and witness monuments, references and accessories used to perpetuate the original or re-established location of this corner:

Witnesses to corner location:

W. Jung

G. Dechant

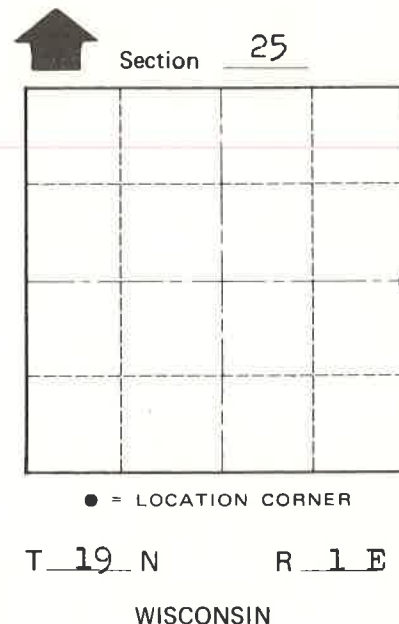
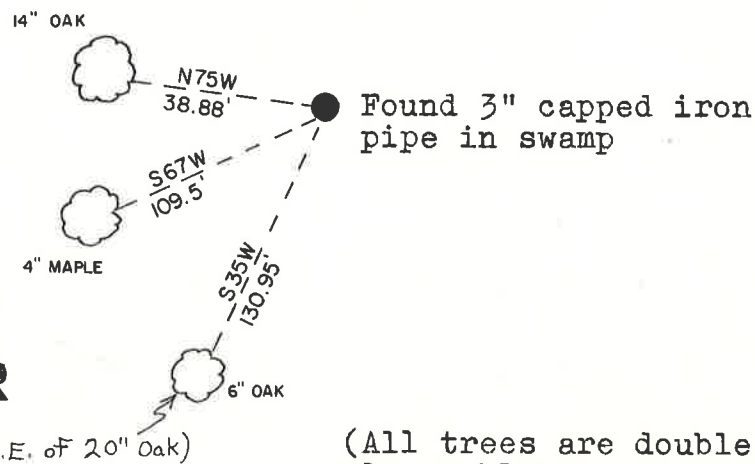

Approved: **HARLEY A. SIME**
MONROE CO. SURVEYOR

SURVEY CONTROL ORDER

Horizontal	_____
Vertical	_____

WISCONSIN COORDINATE SYSTEM

Corner	East (X)	North (Y)	Elevation (Z)	Zone
Control Sta. Name				

(All trees are double blazed with nail in lower blaze, distance to lower blaze)

~~City, Village or~~ Town Scott
 County of Monroe

COUNTY SURVEYOR FORM NO. 1