

**U. S. Public Land Corner
Maintenance**

#48

Corner: N1/4 Sec. 16, T15N-R1E

41501090020

<u>Date</u>	<u>Crew</u>	<u>Monument type</u>
December 8, 2021	Zachariah P. Dechant Gary L. Dechant	Corner destroyed during relocation of Norwood Road. Reset from previous survey points and rotted bearing tree stumps with nails. Reset a Harrison Monument and stones. Pit westerly 10.5', Set survey sign 1' west. Corner is 53' east of center of relocated road.

References:

	<u>Bearing</u>	<u>Distance</u>
1) Set 3/4"x24" iron pipe	N10E	26.14'
2) Set 1"x24" iron pipe	S65E	20.90'
3) Set 3/4"x24" iron pipe, 16' east of center of Norwood Road	S36W	51.04'
4) Set 3/4"x24" iron pipe, 18' east of center of Norwood Road	N60W	55.91'

Compass bearings

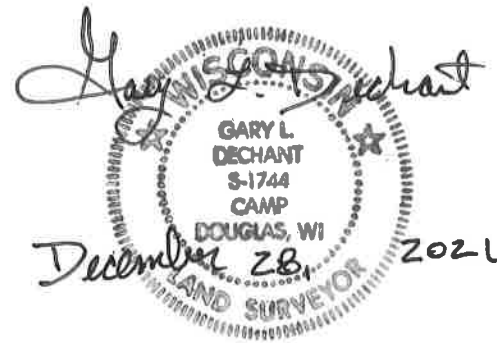

41501090020

I, William C. Jung, do hereby certify that on the 18th day of June 19 79, I found (evidence) ~~(no evidence)~~ of the North 1/4 corner of Section 16, T 15 N, R 1 E Fourth Principal Meridian, and I re-established said corner according to the Wisconsin Statutes as shown and described hereon.

Dated this 13th day of Feb. 19 81.

William C. Jung

William C. Jung, R.L.S. 1323
Title

History of corner establishment since Original Government Survey

Zietlow set an iron bar at this corner in March of 1972. He set it equidistant and on line between the section corners. Gary Sime found and accepted this iron bar in his survey of summer, 1976, while surveying out Section 9.

Description of corner evidence found:

Found the corner of record, removed the iron bar and set a Harrison marker.

Approved: **HARLEY A. SIME**
MONROE CO. SURVEYOR

See Reverse Side
For Maintenance

Description of corner and witness monuments, references and accessories used to perpetuate the original or re-established location of this corner:

Witnesses to corner location:

Jung
Pietz
Webb

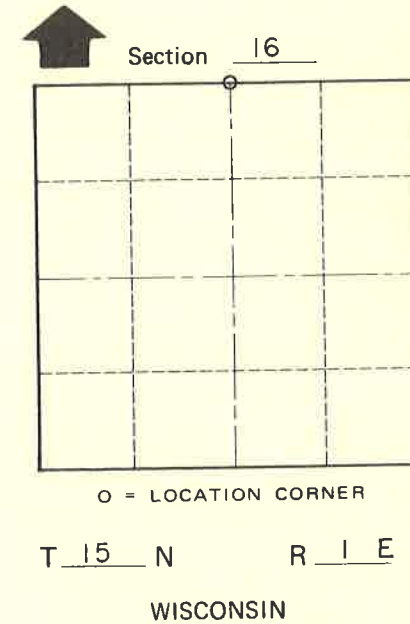
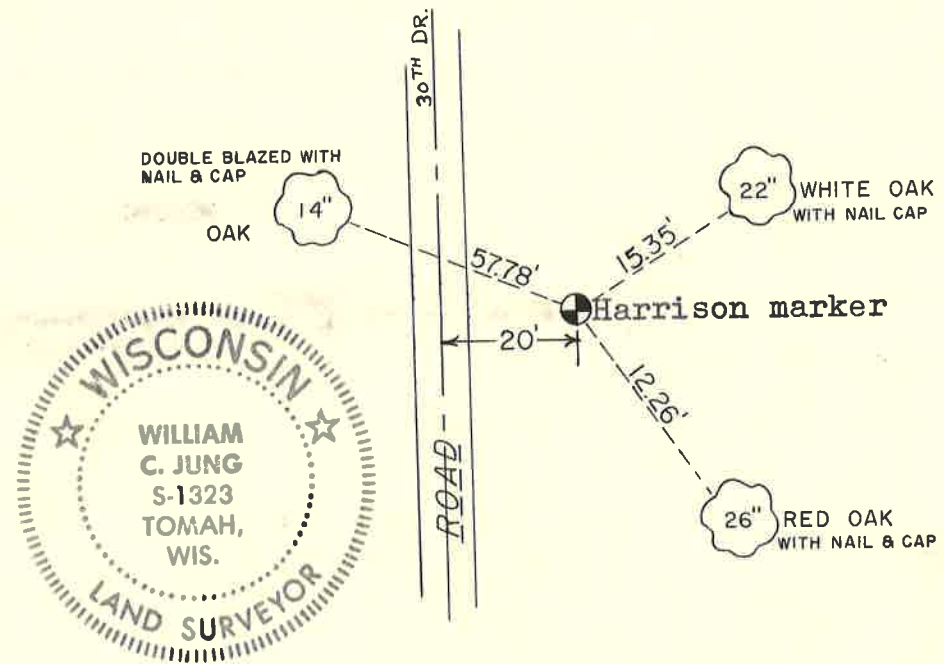

SURVEY CONTROL ORDER

Horizontal	_____
Vertical	_____

WISCONSIN COORDINATE SYSTEM

Corner	East (X)	North (Y)	Elevation (Z)	Zone
Control Sta. Name				

_____ or Town Glendale
County of Monroe

COUNTY SURVEYOR FORM NO. 1