

**U. S. Public Land Corner
Maintenance**

#21
Corner: SE Sec. 1, T17N-R4W
21704010000

<u>Date</u>	<u>Crew</u>	<u>Monument type</u>
September 24, 2021	Zachariah P. Dechant Gary L. Dechant	Existing Harrison intact, down 4", 3' north center line Gardener Ave, approx 150' west of driveway 10089 Gardener, fence line running north and south of road.

References:	<u>Bearing</u>	<u>Distance</u>
1)Set 2' section steel fence post, down 10" in field	N30E	36.95'
2)Set 3/4"x24" round iron bar in lawn	S20E	48.30'
3)Existing 3/4" round iron bar	South	33.03'
4)Set 2' section steel fence post, down 10" in field	S30W	49.23'
5) Set Railroad spike in lawn	N20W	46.26'

Compass bearings.
Harrison & reference markers 1, 2, 4, & 5 set on straight lines.

Gary L. Dechant

September 28, 2021

CERTIFICATE

CERTIFIED LAND CORNER

No. 21

I, Harley A. Sime, do hereby certify that on the 11 day of July, 19 75, I found (evidence) ~~(no evidence)~~ of the S.E. corner of Section 1, T17 N, R 4W, Fourth Principal Meridian, and I re-established said corner according to the Wisconsin Statutes as shown and described hereon.

Dated this 14 day of Jan., 19 76.

Harley A. Sime

County Surveyor

Title

History of original corner establishment:

**See Reverse Side
For Maintenance**

Description of corner evidence found:

Found a R.R. spike set over an iron pipe. Removed both and set a Harrison marker. The old corner was on record and had been used in previous surveys.

Description of corner and witness monuments, references and accessories used to perpetuate the original or re-established location of this corner:
Set Harrison in road, down 1".

Witnesses to corner location:

W.C. Jung- Crew Chief *W.C. Jung*

G. Dechant

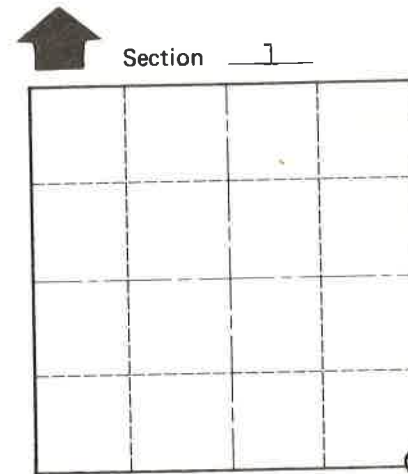
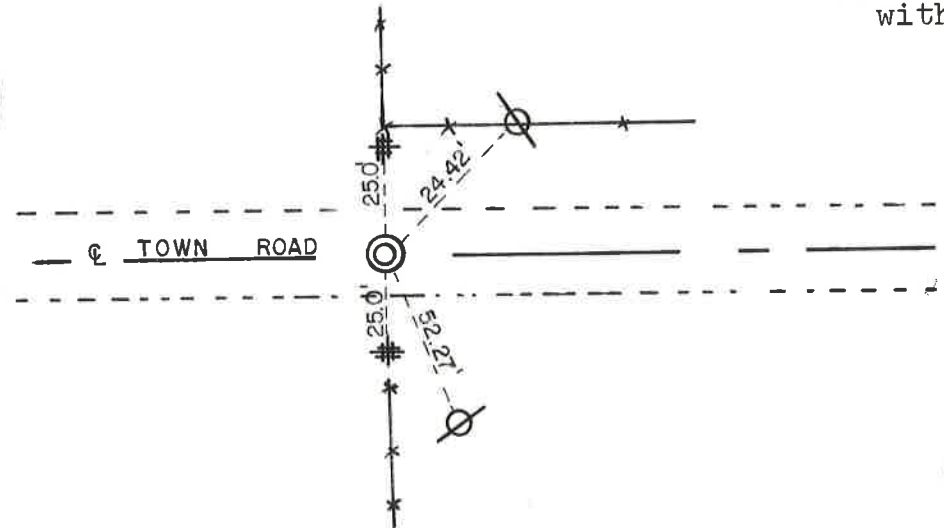
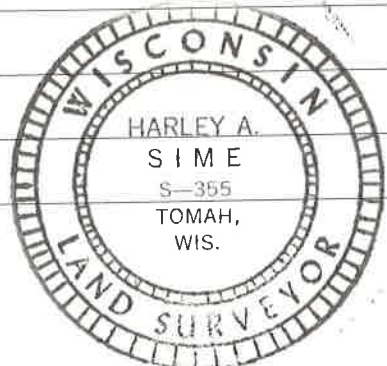

O = LOCATION CORNER

T 17 N R 4W

WISCONSIN

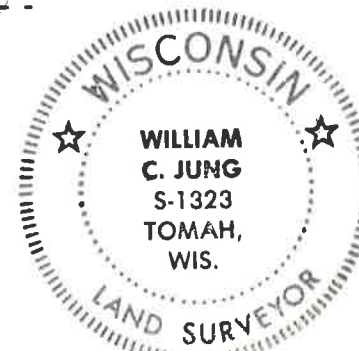

City, Village or Town Sparta

County of Monroe

SURVEY CONTROL ORDER

Horizontal _____

Vertical _____

WISCONSIN COORDINATE SYSTEM

Corner	East (X)	North (Y)	Elevation (Z)	Zone
Control Sta. Name				

COUNTY SURVEYOR FORM NO. 1