

#40

**U. S. Public Land Corner
Maintenance**

**Corner: E1/4 Sec. 12, T17N-R1W
21701122000**

<u>Date</u>	<u>Crew</u>	<u>Monument type</u>
September 17, 2021	Zachariah P. Dechant Gary L. Dechant	Existing Harrison intact, in remnants of east-west fence, placed concrete around Harrison. Set sign 1' west. Steel fence post 1' east.

References:

	<u>Bearing</u>	<u>Distance</u>
1)Set 2' section steel fence post, 4' SW of 6" Maple	N60E	33.33'
2)Set 2' section steel fence post, 4' NW 6" Black Cherry	S50E	40.41'
3)Set 2' section steel fence post, 4' NE of 12" Red Oak	S15W	12.05'
4)Set 2' section steel fence post, 4' East of 9" Maple	West	22.55'

Compass bearings.
Trees double blazed.



I, Harley A. Sime, do hereby certify that on the 5th day of July 1979, I found (evidence) (no evidence) of the West 1/4 corner of Section 12, T17 N, R 1 W Fourth Principal Meridian, and I re-established said corner according to the Wisconsin Statutes as shown and described hereon.

Dated this 30th day of Dec. 1980.

Approved: HARLEY A. SIME
MONROE CO. SURVEYOR
Title

History of corner establishment since Original Government Survey

No known history since the original government survey.

Description of corner evidence found:

Found an iron pipe not on record in E-W fence line. Pipe fit occupied conditions reasonably well. Replaced the iron pipe with Harrison Monument.

**See Reverse Side
For Maintenance**

COUNTY SURVEYOR FORM NO. 1

Description of corner and witness monuments, references and accessories used to perpetuate the original or re-established location of this corner:

Replaced existing iron pipe with Harrison Monument

Witnesses to corner location:

Dechant

Webb

~~Replaced~~ ~~With~~
 On 9/15/82 Crew: By Jung
 Comments C.M. Keach set a gas
pipe at this corner in Nov.
of 1914.

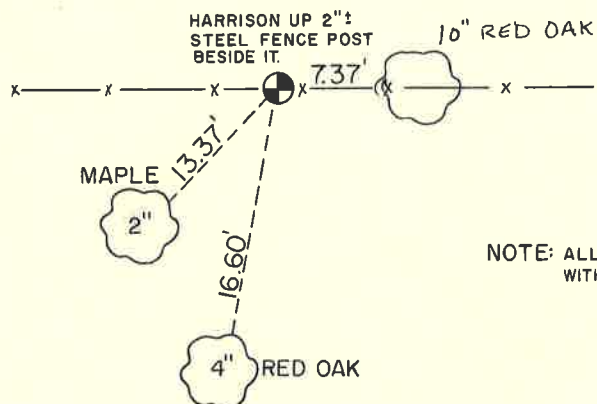

NOTE: ALL TREES DOUBLE BLAZED WITH NAIL & CAPS SET

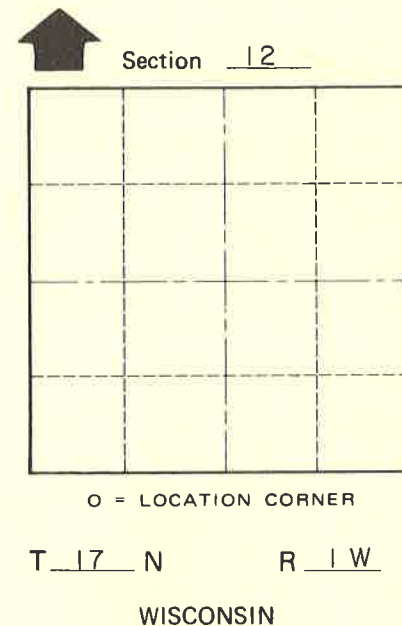

SURVEY CONTROL ORDER

Horizontal	_____
Vertical	_____

WISCONSIN COORDINATE SYSTEM

Corner	East (X)	North (Y)	Elevation (Z)	Zone
Control Sta. Name				

City, Village or Town Tomah
 County of Monroe