

106

U. S. Public Land Corner

Corner: S1/4 Sec. 27, T19N-R4W

Maintenance

21904270020

<u>Date</u>	<u>Crew</u>	<u>Monument type</u>
April 13, 2021	Zachariah P. Dechant Gary L. Dechant	Found 1 1/4" round iron bar, 8' north center of Carmel Ave & 30' east of center of Canton Road. Down 4".

References:

	<u>Bearing</u>	<u>Distance</u>
1) Set 1"x24" iron pipe	N65E	69.80'
2) Set 1"x24" iron pipe 4' north of 4" Apple	S8W	38.84'
3) Set 1"x24" iron pipe 6' north of 5" Spruce, 11' west driveway 7493 Carmel, 29' south center Carmel Ave.	S65W	91.72'
4) Set 1"x24" iron pipe	N8E	53.65'

Compass bearings

Corner and reference markers set on straight lines.

Old Blacksmith shop is gone.



I, Harley A. Sime, do hereby certify that on the 16 day of June 19 76, I found (evidence) ~~#####~~ of the S¼ corner of Section 27, T19 N, R4W # Fourth Principal Meridian, and I re-established said corner according to the Wisconsin Statutes as shown and described hereon.

Dated this 7TH day of Feb. 19 78.

History of original corner establishment:

Existing 1½" Iron Pipe on record

Description of corner evidence found:

Found existing 1½" Iron Pipe down about a foot, set 1¼"x30" Iron Bar inside of pipe, flush with road.

County Surveyor
Title

Approved: HARLEY A. SIME
MONROE CO. SURVEYOR

See Reverse Side For Maintenance

Description of corner and witness monuments, references and accessories used to perpetuate the original or re-established location of this corner:

Witnesses to corner location:

Garold A. Sime, Crew Chief H.A. Sime

D. Dade

B. Meyer

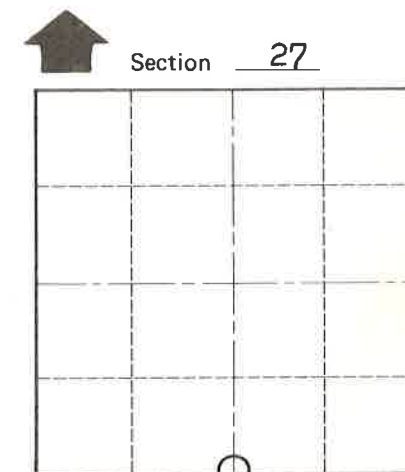
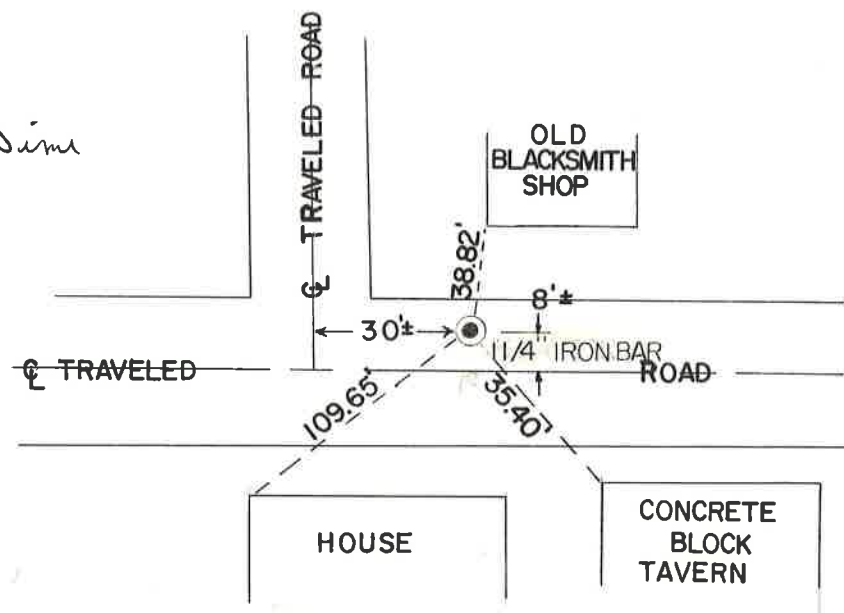

O = LOCATION CORNER

T 19 N R 4W #
WISCONSIN

SIGN PLACED 4-2-78 H. Sime

SURVEY CONTROL ORDER

Horizontal	_____
Vertical	_____

WISCONSIN COORDINATE SYSTEM

Corner	East (X)	North (Y)	Elevation (Z)	Zone
Control Sta. Name				

City, Village or Town Village of Cataract
Town of Little Falls
County of Monroe

COUNTY SURVEYOR FORM NO. 1