

CERTIFICATE

CERTIFIED LAND CORNER

No. 42

21804120020

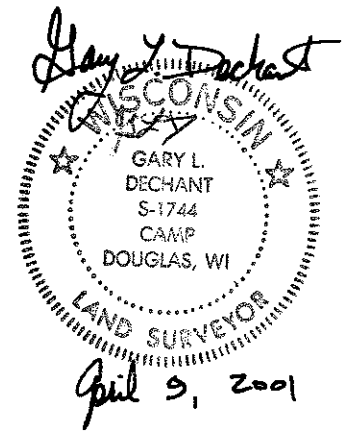

I, Gary L. Dechant, do hereby certify that on the 3rd day of April 2001, I found ~~(evidence)~~ (no evidence) of the N/4 corner of Section 13, T 18 N, R 4 W Fourth Principal Meridian, and I re-established said corner according to the Wisconsin Statutes as shown and described hereon.

Dated this 9th day of April 2001.

Gary L. Dechant
Registered Land Surveyor
Title

History of corner establishment since Original Government Survey

Fred Holden was here in 1908-1909.

Description of corner evidence found:

Found no evidence of corner. Set by single proportionate measurement.

COUNTY SURVEYOR FORM NO. 1

Description of corner and witness monuments, references and accessories used to perpetuate the original or re-established location of this corner:

40d NAIL (SURVEY PT.) 2' NW OF
6" WHITE OAK

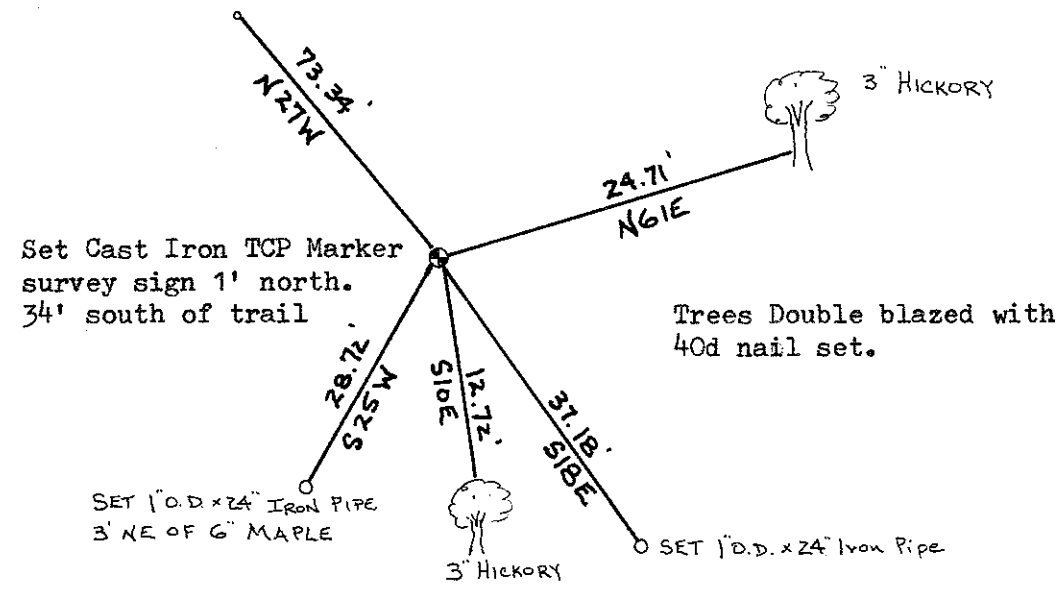

Set Cast Iron TCP Marker
survey sign 1' north.
34' south of trail

SET 1" O.D. x 24" IRON PIPE
3' NE OF 6" MAPLE

Trees Double blazed with
40d nail set.

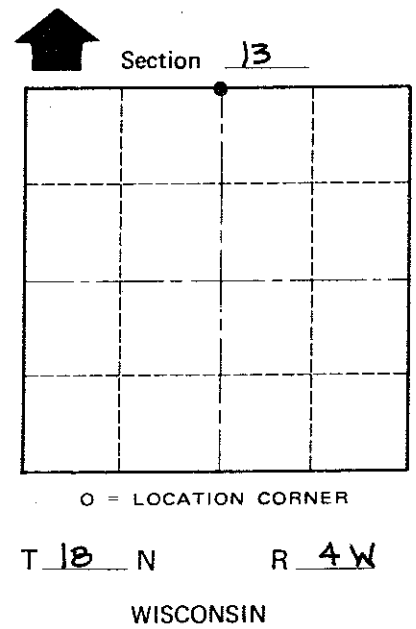

O = LOCATION CORNER
T 18 N R 4 W
WISCONSIN

Witnesses to corner location:

Zachariah P. Dechant

Gary L. Dechant

SURVEY CONTROL ORDER

Horizontal _____
Vertical _____

WISCONSIN COORDINATE SYSTEM

| Corner | East (X) | North (Y) | Elevation (Z) | Zone |
|-------------------|----------|-----------|---------------|------|
| Control Sta. Name | | | | |

City, Village or Town Little Falls
County of Monroe