

21804162000

I, William C. Jung, do hereby certify that on the 31st day of October, 1978, I found (evidence) (no evidence) of the E<sup>1</sup>/<sub>4</sub> corner of Section 16, T. 18 N, R. 4 W, Fourth Principal Meridian, and I re-established said corner according to the Wisconsin Statutes as shown and described hereon.

History of original corner establishment:

Schroeder was at this corner in April of 1893.

Description of corner evidence found:

Found an iron bar set in a previous survey by Fred Zietlow and replaced the iron bar with a Harrison. The occupied fence corner was accepted as the best available evidence.

Dated this 5th day of Jan., 1979.

William C. Jung, R.L.S. 1323

Crew Chief, County Surveyor's  
Title Office

COUNTY SURVEYOR FORM NO. 1

Description of corner and witness monuments, references and accessories used to perpetuate the original or re-established location of this corner:

Witnesses to corner location:

W. Jung

G. Dechant

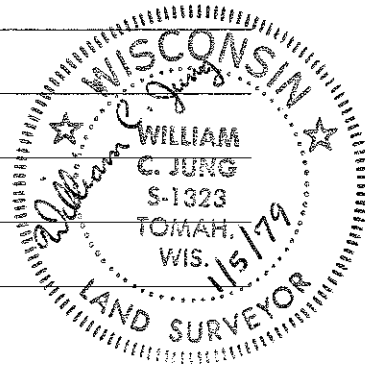

(All trees are double blazed with N&C's set)

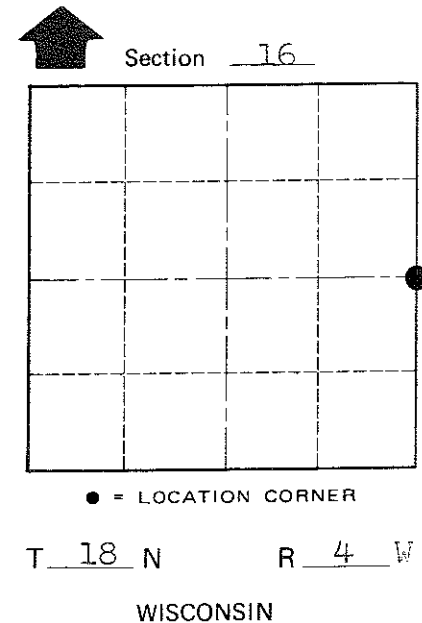
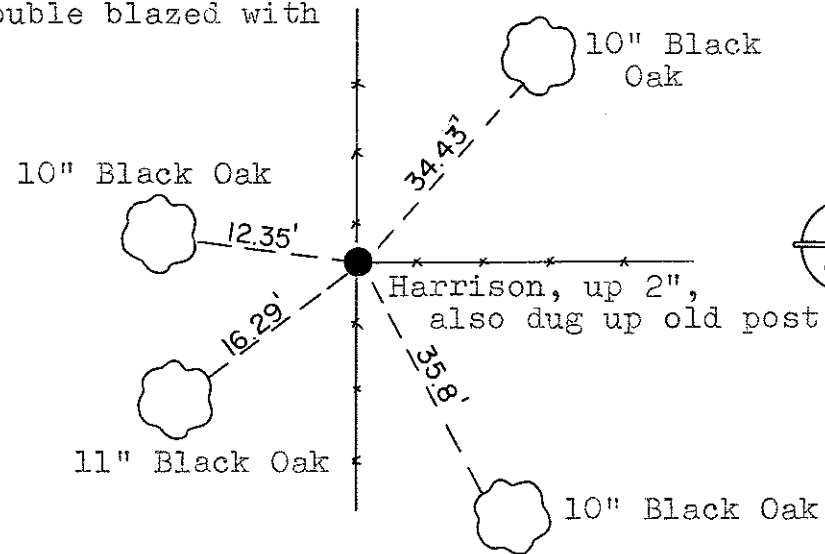

SURVEY CONTROL ORDER

|            |       |
|------------|-------|
| Horizontal | _____ |
| Vertical   | _____ |

Approved by: Harley A. Sime  
County Surveyor

WISCONSIN COORDINATE SYSTEM

| Corner            | East (X) | North (Y) | Elevation (Z) | Zone |
|-------------------|----------|-----------|---------------|------|
| Control Sta. Name |          |           |               |      |

City, Village or Town Little Falls

County of Monroe