

21804172020

I, Bryan H. Meyer, do hereby certify that on the eleventh day of November 1982, I found (evidence) ~~no evidence~~ of the Center 1/4 corner of Section 17, T 18 N, R 4 W Fourth Principal Meridian, and I re-established said corner according to the Wisconsin Statutes as shown and described hereon.

History of corner establishment since Original Government Survey

Fred Holden was here in June of 1907 and set a 1 1/2" iron pipe.

Description of corner evidence found:

Found Holden's 1 1/2" iron pipe and bearing tree.

Dated this 14th day of Dec. 1982.

Bryan H. Meyer

Registered Land Surveyor

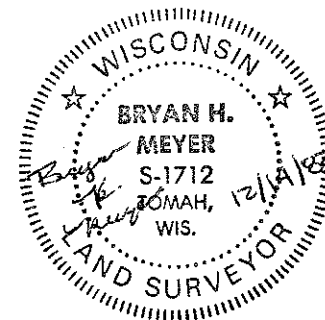

Approved: HARLEY A. SIME
MONROE CO. SURVEYOR

COUNTY SURVEYOR FORM NO. 1

Description of corner and witness monuments, references and accessories used to perpetuate the original or re-established location of this corner: The bearing trees shown are double blazed. Nails are set in hacks in the side of each tree. Distances are from the center of the pipe to the head of each nail.

Witnesses to corner location:

Bryan H. Meyer

Dallas Wilhite

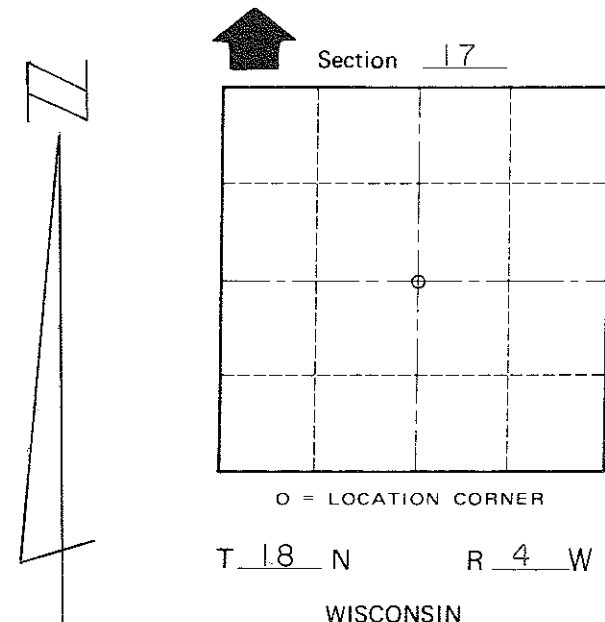
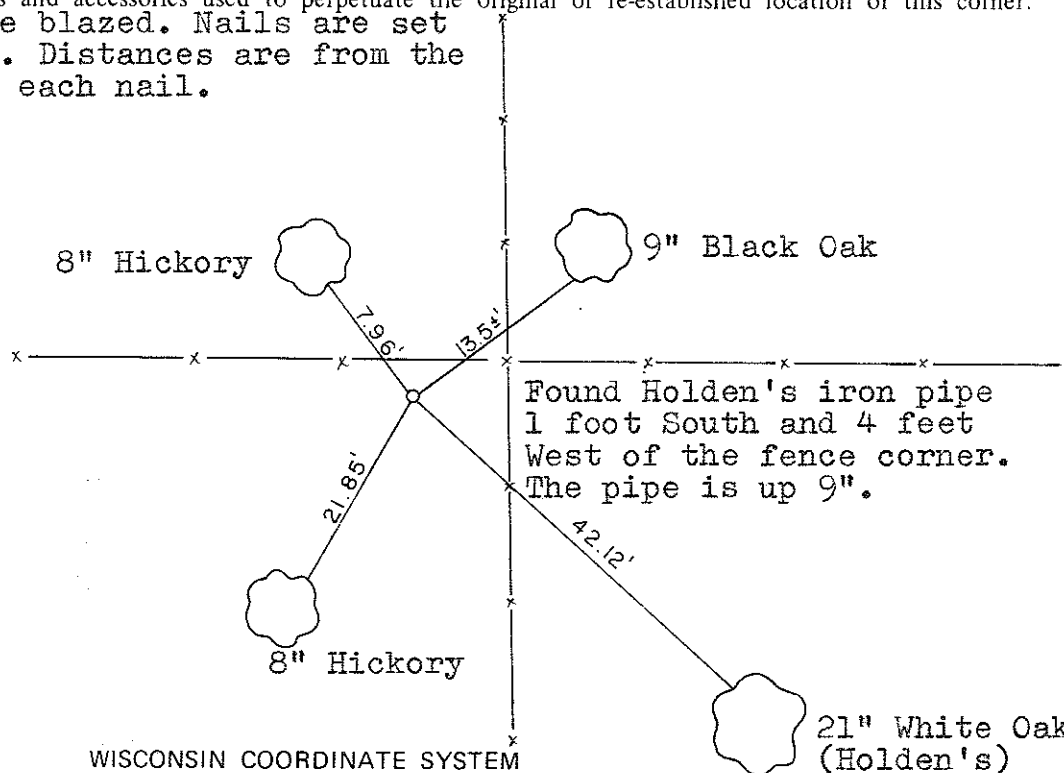

SURVEY CONTROL ORDER

Horizontal	_____
Vertical	_____

Corner	East (X)	North (Y)	Elevation (Z)	Zone
Control Sta. Name				

~~City, Village or~~ Town of Little Falls

County of Monroe