

21804170020



I, Bryan H. Meyer, do hereby certify that on the thirteenth day of November 1982, I found (evidence) ~~no evidence~~ of the South 1/4 corner of Section 17, T 18 N, R 4 W Fourth Principal Meridian, and I re-established said corner according to the Wisconsin Statutes as shown and described hereon.

Dated this 14th day of Dec. 1982.

Bryan H. Meyer
Registered Land Surveyor

Approved: HARLEY A. SIME
Title
MONROE CO. SURVEYOR

COUNTY SURVEYOR FORM NO. 1

Description of corner and witness monuments, references and accessories used to perpetuate the original or re-established location of this corner:

The bearing trees shown are double blazed, with scribing in the upper blaze. Nails are set in hacks in the side of each tree. Distances are from the Harrison to the head of Witnesses to corner location: each nail.

Bryan H. Meyer
William C. Jung

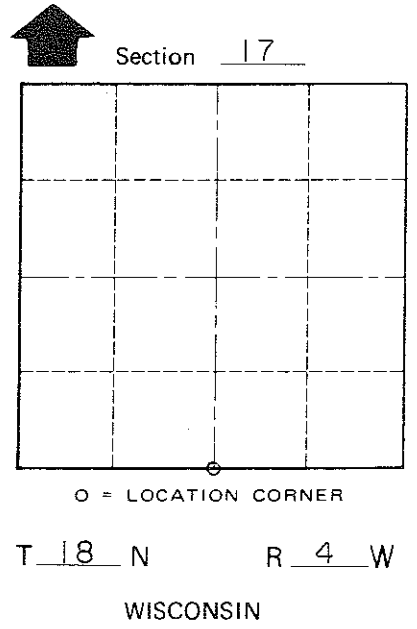
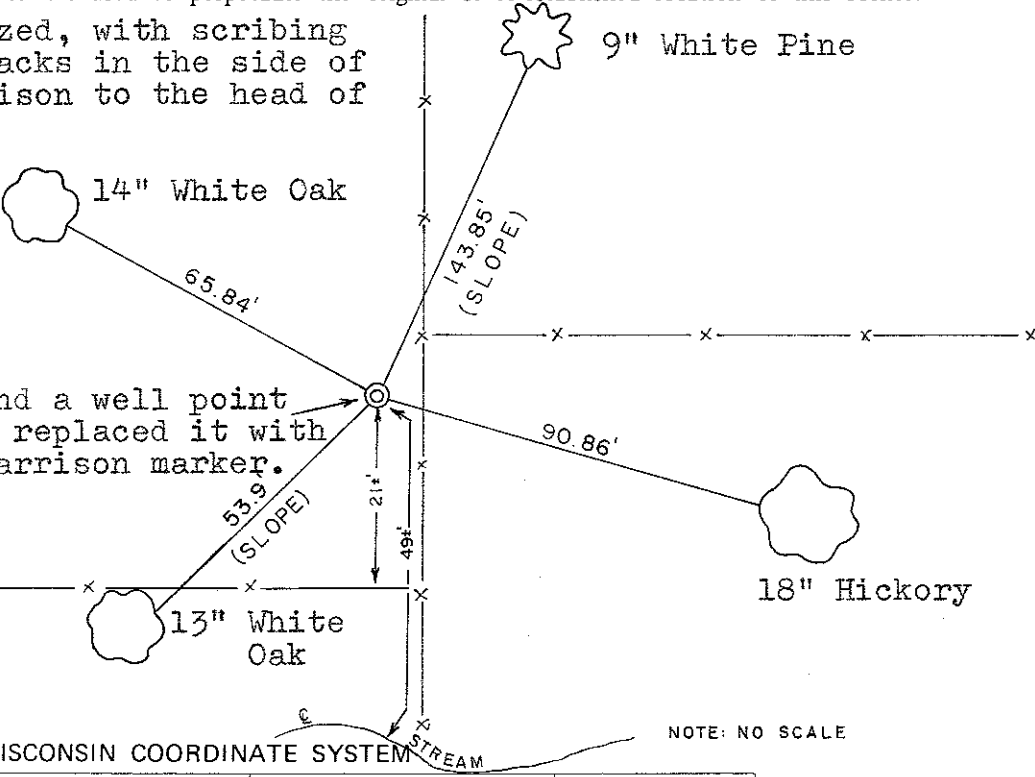

SURVEY CONTROL ORDER

Horizontal	_____
Vertical	_____

WISCONSIN COORDINATE SYSTEM

NOTE: NO SCALE

Corner	East (X)	North (Y)	Elevation (Z)	Zone
Control Sta. Name				

~~Village of~~ Town of Little Falls
County of Monroe

History of corner establishment since Original Government Survey

Fred Holden was here in June of 1907.

Description of corner evidence found:

Found an unrecorded well point near fence corner. This monument fits other section data very well, therefore I accepted it as the corner.