

2180420000

I, Gary L. Dechant, do hereby certify that on the 29th day of October 19 84, I found (no evidence) of the SW corner of Section 21, T 18 N, R 4W Fourth Principal Meridian, and I re-established said corner according to the Wisconsin Statutes as shown and described hereon.

History of corner establishment since Original Government Survey

No known history since the original government survey.

Description of corner evidence found:

East-West

Set corner in existing fence line at prorated distances to the original government survey notes between the N 1/4 corner of Section 29 and the SE corner of Section 21.

Dated this 30th day of Oct. 19 84.

Gary L. Dechant

Registered Land Surveyor, 1744 Title

COUNTY SURVEYOR FORM NO. 1

Description of corner and witness monuments, references and accessories used to perpetuate the original or re-established location of this corner:

Witnesses to corner location:

Lawrence A. Feddersen, S1226

Gary L. Dechant

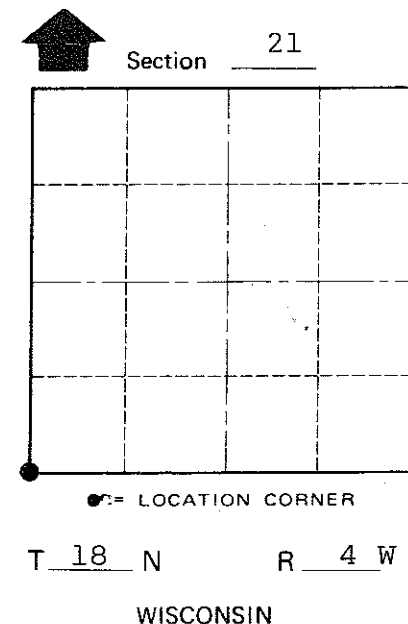
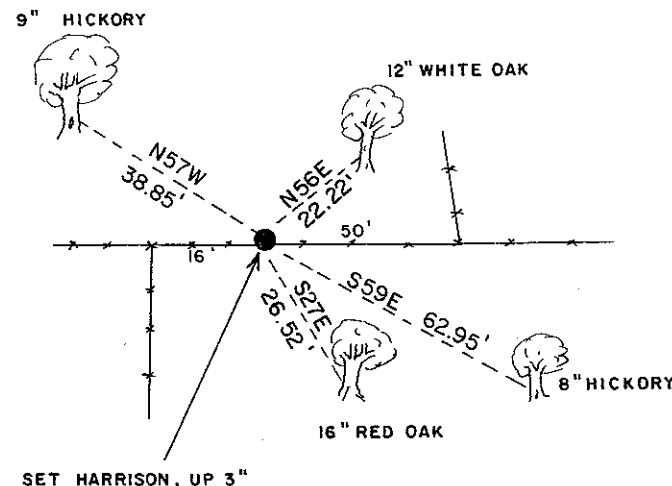

(Trees double blazed with N&C's)

SURVEY CONTROL ORDER

Table with 2 rows: Horizontal, Vertical.

WISCONSIN COORDINATE SYSTEM

Table with 5 columns: Corner, East (X), North (Y), Elevation (Z), Zone.

City, Village or Town Sparta
County of Monroe