

21804220000

I, Lawrence A. Feddersen, do hereby certify that on the twentythird day of April 19 96, I found ~~(evidence)~~ ~~(~~no evidence~~)~~ of the Southeast corner of Section 22, T 18 N, R 4 W Fourth Principal Meridian, and I re-established said corner according to the Wisconsin Statutes as shown and described hereon.

Dated this 29 day of April 19 96.

*Lawrence A. Feddersen*

Registered Land Surveyor

Title

History of corner establishment since Original Government Survey

No record of re-established corner.

Description of corner evidence found:

Accepted a 3 way downed fence as best possible evidence.

Description of corner and witness monuments, references and accessories used to perpetuate the original or re-established location of this corner:

Witnesses to corner location:

Lawrence A. Feddersen

Timothy J. Jeatran

Harold A. Haberlin

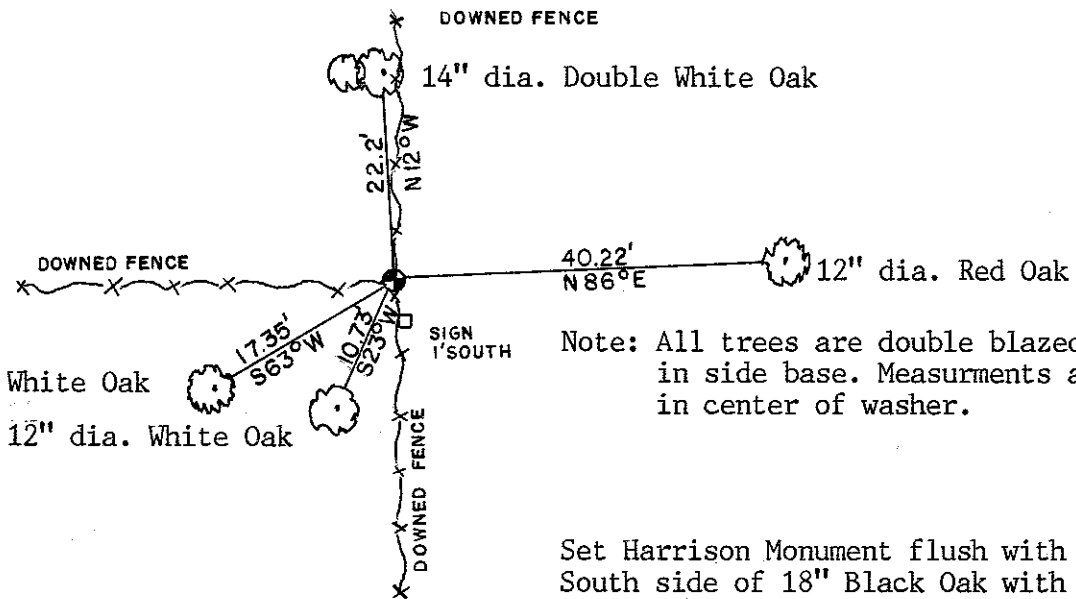

Note: All trees are double blazed with N&W in side base. Measurements are to nail in center of washer.

Set Harrison Monument flush with ground on South side of 18\" Black Oak with wire through it. Set sign 1' South.

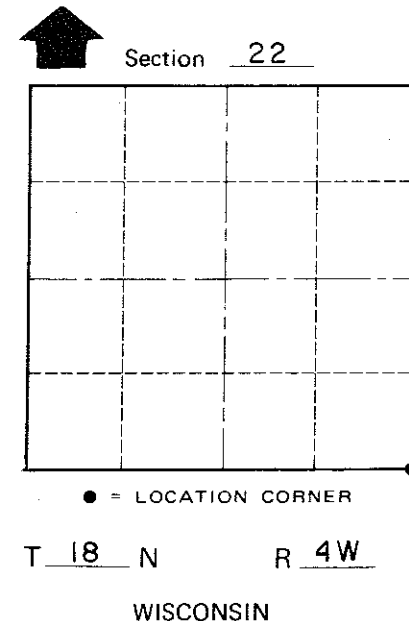

COUNTY SURVEYOR FORM NO. 1

SURVEY CONTROL ORDER

Horizontal	_____
Vertical	_____

WISCONSIN COORDINATE SYSTEM

Corner	East (X)	North (Y)	Elevation (Z)	Zone
Control Sta. Name				

~~City, Village or~~ Town of Sparta  
 County of Monroe