

21804302000

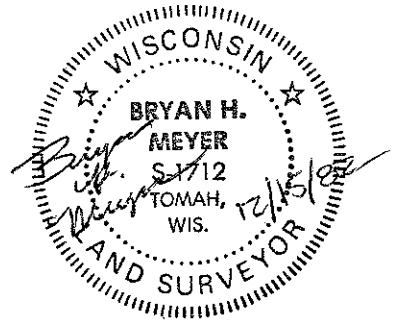

I, Bryan H. Meyer, do hereby certify that on the 12th day of August 1982, I found (evidence) ~~XXXXXXXXXX~~ of the West 1/4 corner of Section 29, T 18 N, R 4 W Fourth Principal Meridian, and I re-established said corner according to the Wisconsin Statutes as shown and described hereon.

Dated this 15th day of Dec. 1982.

Bryan H. Meyer
Registered Land Surveyor

History of corner establishment since Original Government Survey

Hamilton LaRue was at this corner in June of 1899. Harley Sime was here in April of 1963 and set an iron pipe. Larry Fedderson shows an existing 1 3/4" iron pipe at this corner in his November 1976 survey.
Description of corner evidence found:

Found a 1 1/2" iron pipe, up 8", and replaced it with a Harrison monument.

Approved: ^{Title} **HARLEY A. SIME**
MONROE CO. SURVEYOR

COUNTY SURVEYOR FORM NO. 1

Description of corner and witness monuments, references and accessories used to perpetuate the original or re-established location of this corner:

Bearing trees shown are double blazed with scribing in the upper blaze. Nails are set in hacks in the side of each tree. Distances are from the Harrison to the head of each nail.
Witnesses to corner location:

Bryan H. Meyer
John Fox

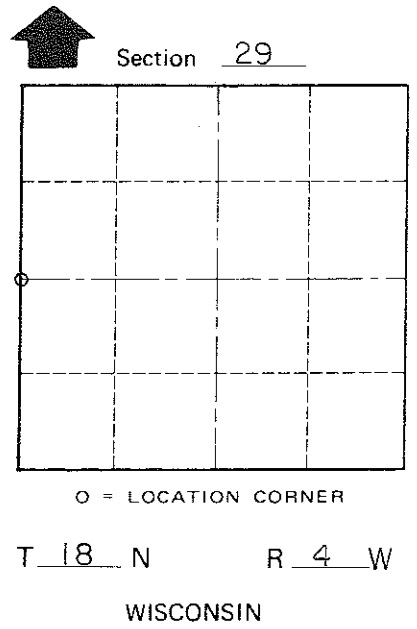
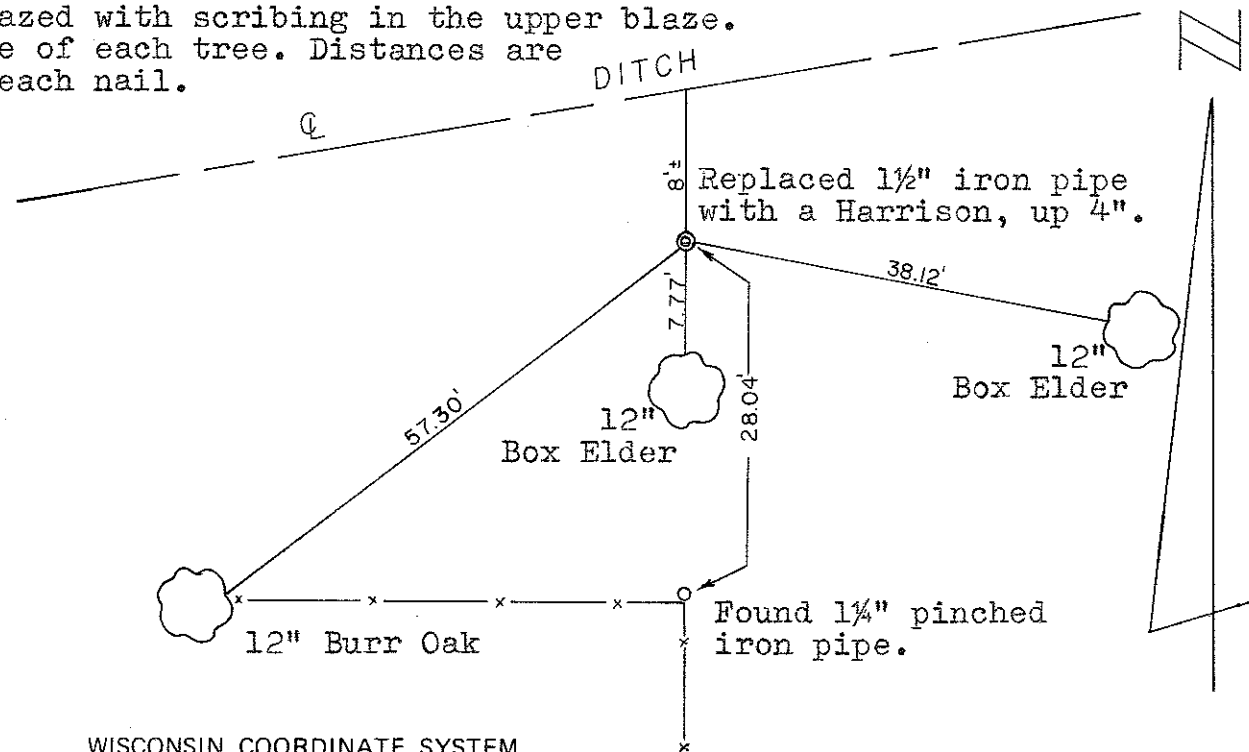

SURVEY CONTROL ORDER

Horizontal	_____
Vertical	_____

WISCONSIN COORDINATE SYSTEM

Corner	East (X)	North (Y)	Elevation (Z)	Zone
Control Sta. Name				

~~Village of~~ Town of Sparta
County of Monroe