

21804300000

I, Gary L. Dechant, do hereby certify that on the 27th day of February 19 84, I found (evidence) (no evidence) of the SE corner of Section 30, T 18 N, R 4 W Fourth Principal Meridian, and I re-established said corner according to the Wisconsin Statutes as shown and described hereon.

Dated this 29th day of Feb. 19 84.

Gary L. Dechant

Registered Land Surveyor, S-1744 Title

History of corner establishment since Original Government Survey

Fred Holden in April of 1899, then Deputy County Surveyor under Hamilton LaRue states he found the original corner here. Keach in 1903, County Surveyor of Jackson County, says there was old corner in stone pile and was verified by stumps.

Description of corner evidence found:

Did not find stone pile but used fence corner as best available evidence of the corner as it fits other field evidence very well. The original notes show a distance of 2620'± from this corner to the N¼ corner of Section 32 and Keach a distance of 2640. We have a computed distance of 2574'± indicating both previous surveys dropped a chain. For a check we also chained between the two corners and came up with a distance of 2578'± (rough chained) and also found a forty fence in between measuring 1289'±. From this SE corner to the SW corner of Section 30 fits the original distance by being 17'± short, as can well be understood by the terrain they had to chain over. From this corner to the E¼ corner it appears they also dropped a chain measuring 2574'± but which

Description of corner and witness monuments, references and accessories used to perpetuate the original or re-established location of this corner: seems to fit a pattern as each half mile North and South in both Section 29 and 30 is Short by 2/3 of a chain or by a full chain. Again can be understood as the terrain in both sections is very rugged.

Witnesses to corner location:

Lawrence A. Feddersen, S-1226

Gary L. Dechant

COUNTY SURVEYOR FORM NO. 1

Approved: HARLEY A. SIME MONROE CO. SURVEYOR

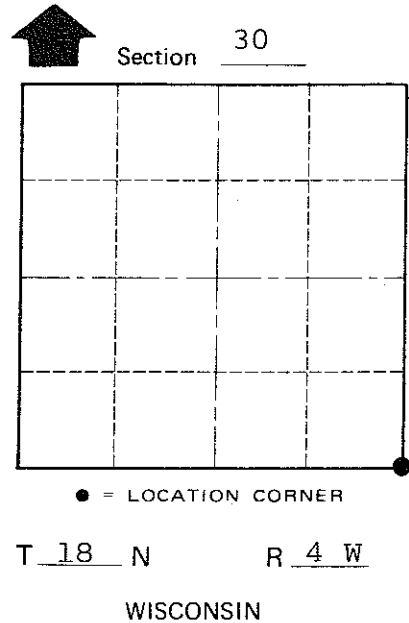
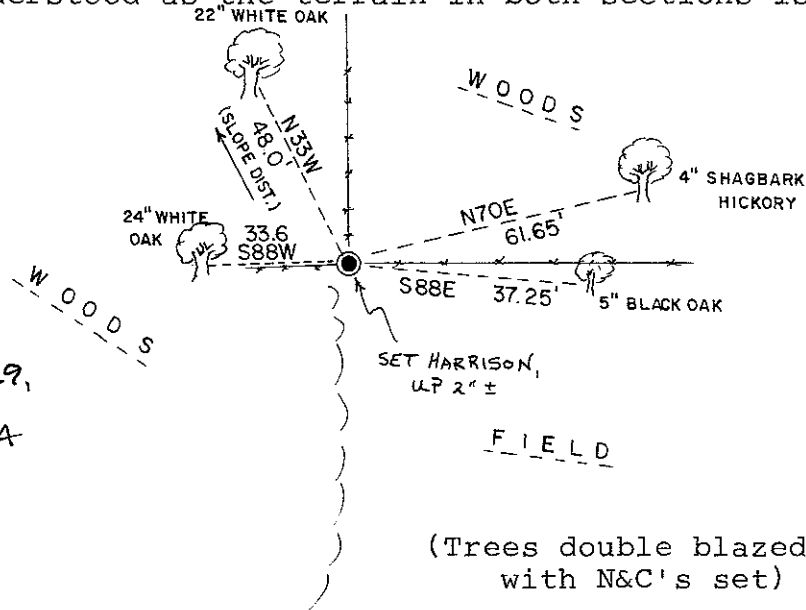
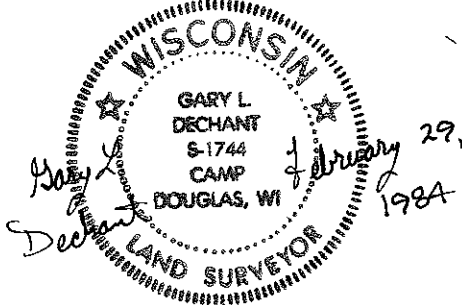

(Trees double blazed, scribed, and with N&C's set)

SURVEY CONTROL ORDER

Table with 2 rows: Horizontal, Vertical

WISCONSIN COORDINATE SYSTEM

Table with 5 columns: Corner, East (X), North (Y), Elevation (Z), Zone

City, Village, Town Sparta County of Monroe