

U.S. LAND CORNER MAINTENANCE

Corner ID : S1/4 Sec. 31, T18N-R4W
21804310200

DATE	CREW	MONUMENT TYPE -----
August 17, 2013	Zachariah P. Dechant Gary L. Dechant	Found 1" iron pipe over destroyed Harrison, B. T's now stumps, replaced 1" iron pipe with 3/4"x6' hexagon iron bar, new sign 2' south, 3' west of west bank of creek

References:

- Set 3/4"x24" hexagon iron bar, down 6"
- Set 1 1/4"x3' iron pipe, down 6"
- Set 3/4"x24" hexagon iron bar, down 6", 3' south of fence
- Set 3/4"x24" hexagon iron bar 14' east centerline of Fairway Road, down 12"

<u>Bearing</u>	<u>Distance</u>
N59W	40.10'
N6E	22.88'
S80W	17.26'
N77W	88.23'

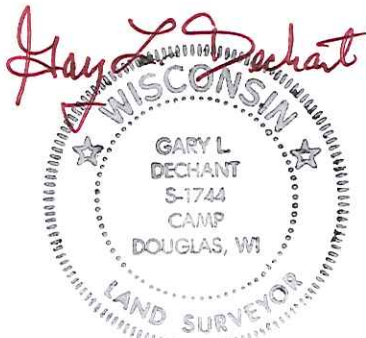

August 17, 2013

CERTIFICATE

CERTIFIED LAND CORNER

No. 12

21804310020

I, Harley A. Sime, do hereby certify that on the 2 day of May 1975, I found ~~(evidence)~~ (no evidence) of the N 1/4 corner of Section 6, T17 N, R 4W Fourth Principal Meridian, and I re-established said corner according to the Wisconsin Statutes as shown and described hereon.

History of original corner establishment:



Description of corner evidence found:

Dated this 14 day of Jan. 1976.

Set by single proportionate measurement between the section corners.

Harley A. Sime

County Surveyor
Title

COUNTY SURVEYOR FORM NO. 1

Description of corner and witness monuments, references and accessories used to perpetuate the original or re-established location of this corner:

Set Harrison marker in fence, flush with the ground.

Witnesses to corner location:

W.C. Jung- Crew Chief *W.C. Jung*

A. Lueck

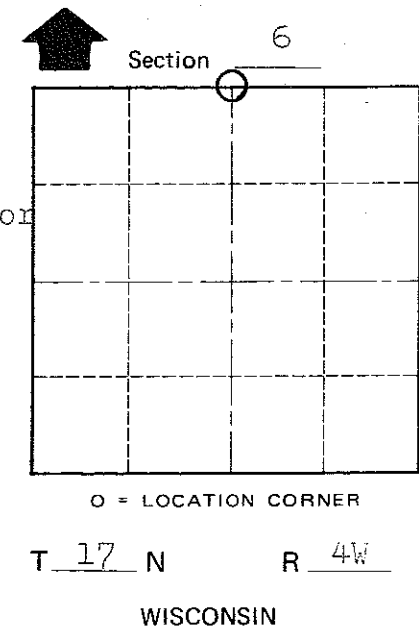
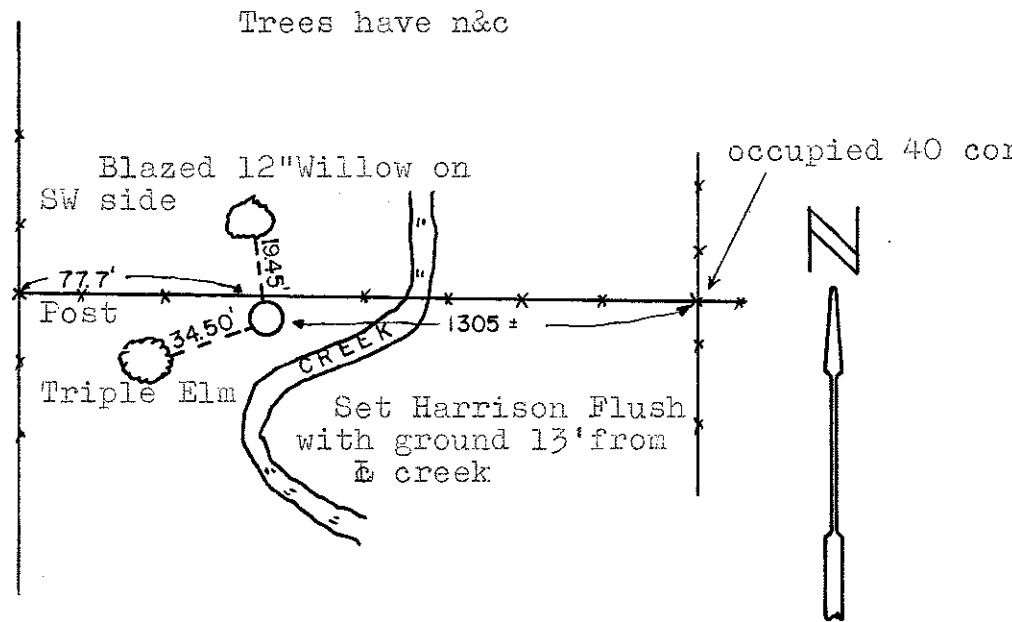
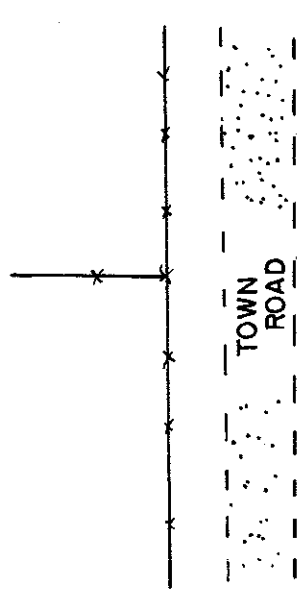
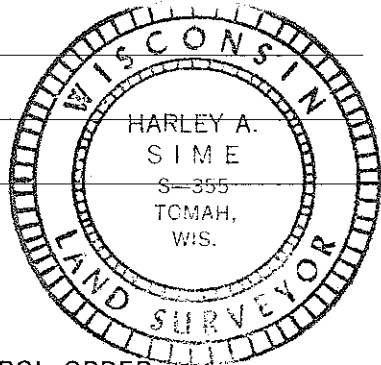

SURVEY CONTROL ORDER

Horizontal _____
Vertical _____

WISCONSIN COORDINATE SYSTEM

Corner	East (X)	North (Y)	Elevation (Z)	Zone
Control Sta. Name				

City, Village or Town Sparta

County of Monroe