

CERTIFICATE

I, Harley A. Sime, do hereby certify that on the 20 day of February 1975, I found (evidence) (~~no evidence~~) of the N¹/₄ corner of Section 5, T 17 N, R 4W, Fourth Principal Meridian, and I re-established said corner according to the Wisconsin Statutes as shown and described hereon.

Dated this 14 day of Jan. 1976.

Harley A. Sime
County Surveyor
Title

CERTIFIED LAND CORNER

History of original corner establishment:

C.M. Keach set a stake at this corner in May of 1903.

Description of corner evidence found:

Found a Harrison marker set by D. Marten in August of 1974.

No. 10

21804320020

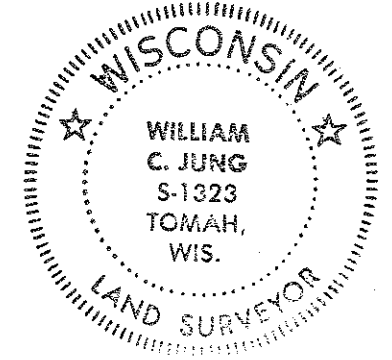

Description of corner and witness monuments, references and accessories used to perpetuate the original or re-established location of this corner: Harrison in fence corner, up 1".

Witnesses to corner location:

W.C. Jung - Crew Chief W.C. Jung
D. Malliet
A. Lueck

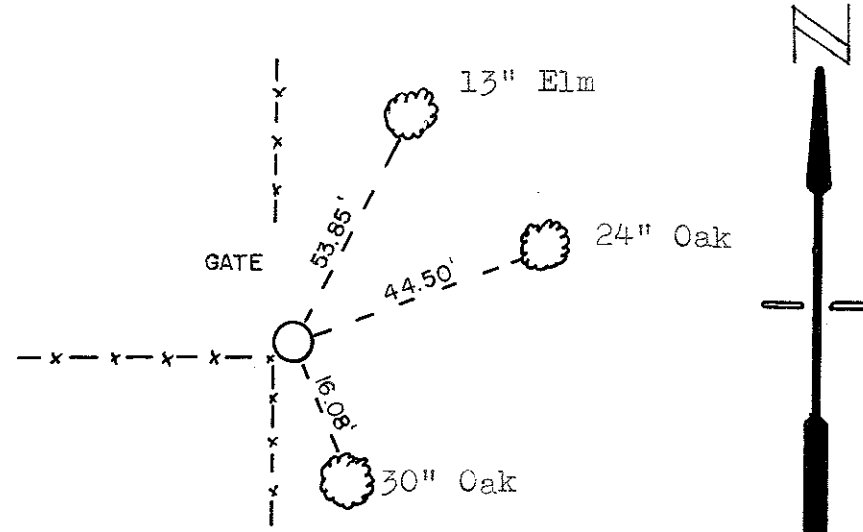
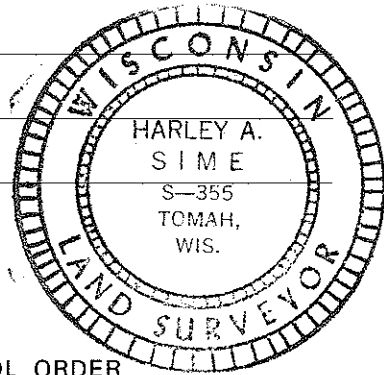

All trees blazed.

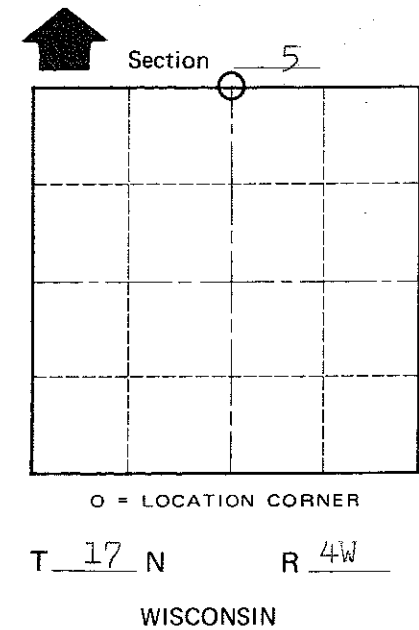

COUNTY SURVEYOR FORM NO. 1

SURVEY CONTROL ORDER

Horizontal _____
Vertical _____

WISCONSIN COORDINATE SYSTEM

Corner	East (X)	North (Y)	Elevation (Z)	Zone
Control Sta. Name				

City, Village or Town Sparta

County of Monroe