

#9

**U.S. PUBLIC LAND CORNER
MAINTENANCE**

Corner ID : NE Sec. 5, T17N-R4W

21804320000

<u>DATE</u>	<u>CREW</u>	<u>MONUMENT TYPE</u> -----
September 3, 2014	Zachariah P.Dechant Gary L. Dechant	Found Harrison, set steel post 1' east Existing double white oak 26.8' northeast only surviving BT

References:

	<u>Bearing</u>	<u>Distance</u>
1) Set 3/4"x24" square iron bar, down 6" 6' west of Double White Oak (BT)	N43E	25.74'
2) Set 3/4"x24" square iron bar, down 6" 2' north of 4" Cherry	S79E	21.20'
3) Set 3/4"x24" square iron bar, down 6"	N66W	19.31'
4) Set 3/4"x24" square iron bar, down 6" 5' southeast of 12" Hickory	N9W	34.44'



CERTIFICATE

CERTIFIED LAND CORNER

No. 9

I, Harley A. Sime, do hereby certify that on the 14 day of January 1976 found (evidence) (no evidence) of the N.E. corner of Section 5, T 17 N, R 4W, Fourth Principal Meridian, and I re-established said corner according to the Wisconsin Statutes as shown and described hereon.

Dated this 15 day of Jan. 19 76.

Harley A. Sime
County Surveyor
Title

History of original corner establishment:

See Reverse Side For Maintenance

Description of corner evidence found:

Projected a line through the N $\frac{1}{4}$ corner of Section 4 and the N1/16-NW $\frac{1}{4}$ -Sec. 4 and set at a distance from the aforesaid forty corner equivalent to that from the latter to the aforesaid N $\frac{1}{4}$ corner. This corner as set fits the Town line very well and existing occupied conditions.



COUNTY SURVEYOR FORM NO. 1

Description of corner and witness monuments, references and accessories used to perpetuate the original or re-established location of this corner:

Set Harrison marker, up 2".
Bottom 6" of the marker are broken off.

Witnesses to corner location:

W.C. Jung - Crew Chief
C. Pietz

7" Shagbark Hickory with n&c

Double White Oak with n&c

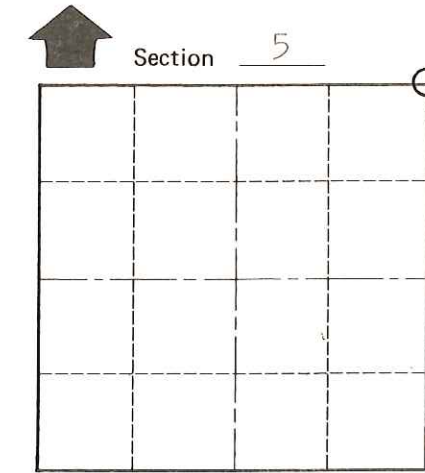
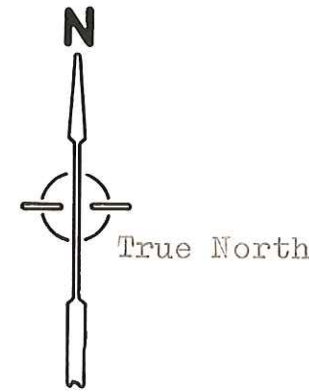
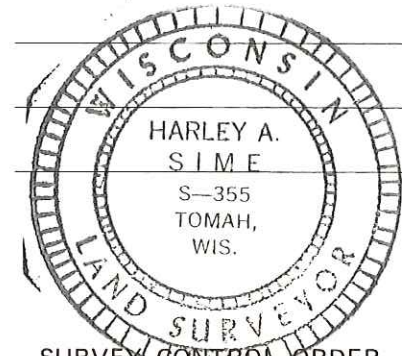

O = LOCATION CORNER
T 17 N R 4W
WISCONSIN

Note: This iron bar was our survey point.

All tie trees were blazed.

SURVEY CONTROL ORDER

Horizontal _____
Vertical _____

WISCONSIN COORDINATE SYSTEM

Corner	East (X)	North (Y)	Elevation (Z)	Zone
Control Sta. Name				

City, Village or Town Sparta

County of Monroe