

8

**U.S. PUBLIC LAND CORNER
MAINTENANCE**

Corner ID : N1/4 Sec. 4, T17N-R4W

21804330020

<u>DATE</u>	<u>CREW</u>	<u>MONUMENT TYPE -----</u>
September 3, 2014	Zachariah P. Dechant Gary L. Dechant	Found Harrison, top broke off. 55' north of Farmland Ave. 4' north of electric ped & 5' west of telephone ped just west of driveway fire no. 6556 Farmland Ave.

References:

	<u>Bearing</u>	<u>Distance</u>
1) Set 3/4"x24" square iron bar, down 6" in lawn	N76E	25.59'
2) Set 3/4"x24" square iron bar, down 6"	N67W	25.72'
3) Set 3/4"x24" square iron bar, down 6"	N14W	23.22'
4) Set 3/4"x24" square iron bar, down 6" 3' southwest of 8" Hickory	N30E	21.31'

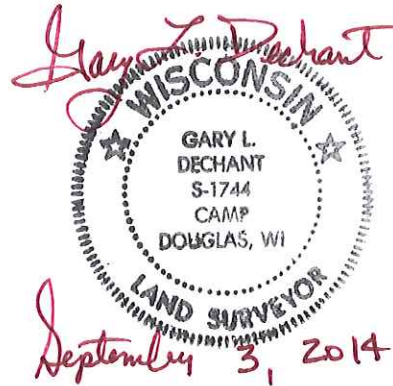

CERTIFICATE

I, Harley A. Sime, do hereby certify that on the 13 day of January, 1976, I found (evidence) (no evidence) of the N ¼ corner of Section 4, T 17 N, R 4W, Fourth Principal Meridian, and I re-established said corner according to the Wisconsin Statutes as shown and described hereon.

Dated this 15 day of Jan., 1976.

Harley A. Sime
County Surveyor
Title

CERTIFIED LAND CORNER

History of original corner establishment:

Description of corner evidence found:

Found 1/2" iron pipe. Accepted this pipe and replaced it with a Harrison marker. This iron pipe was not on record to our knowledge but it does fit the Town line very well and other available evidence and was thus accepted. An unrecorded pipe was also found at the N1/16-NW1/4-Section 4.

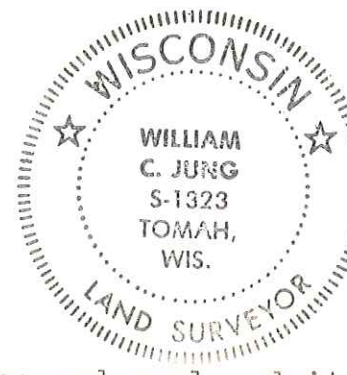

No. 8

See Reverse Side For Maintenance

COUNTY SURVEYOR FORM NO. 1

Description of corner and witness monuments, references and accessories used to perpetuate the original or re-established location of this corner:

Set Harrison, up 2" in fence. Broke off top 8" of pipe. Left the rest of the pipe in and set the Harrison next to and over it.

Witnesses to corner location:

W.C. Jung - Crew Chief *W.C. Jung*
G. Sime

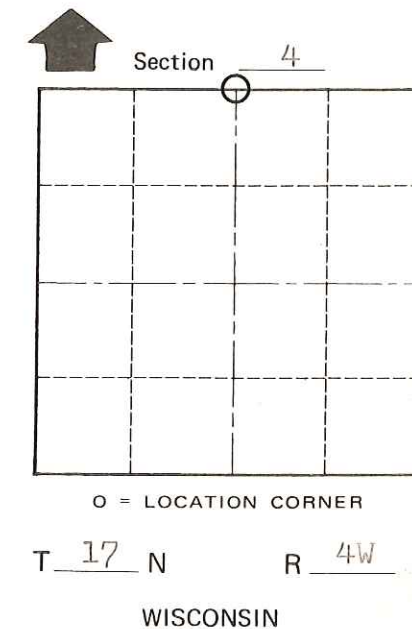
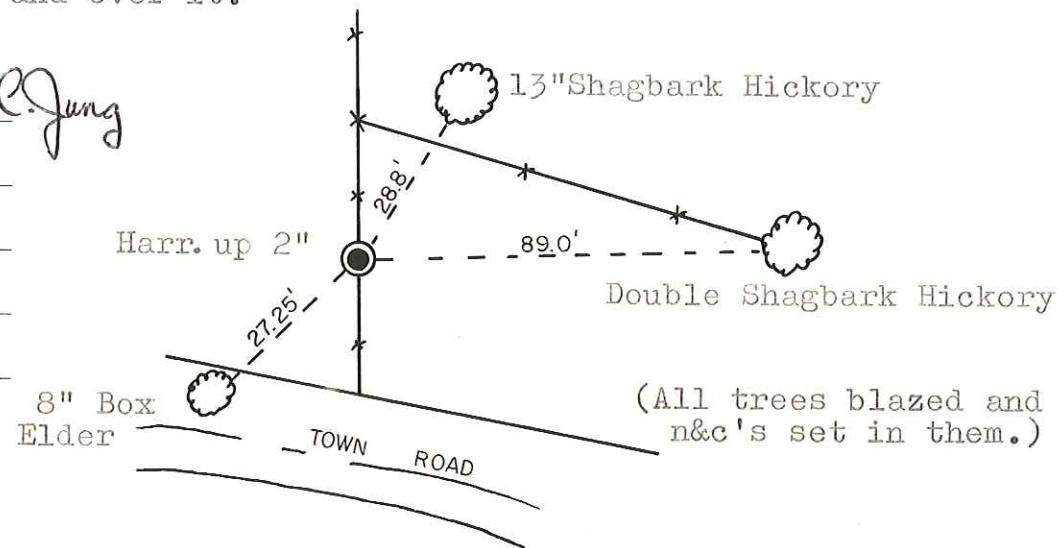
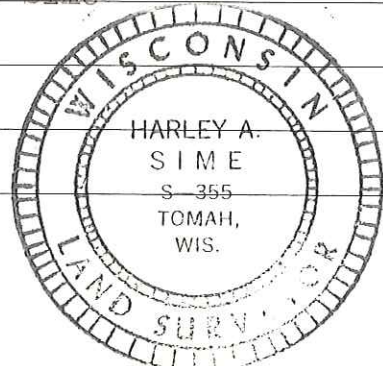

SURVEY CONTROL ORDER

Horizontal	_____
Vertical	_____

WISCONSIN COORDINATE SYSTEM

Corner	East (X)	North (Y)	Elevation (Z)	Zone
Control Sta. Name				

City, Village or Town Sparta

County of Monroe