

CERTIFICATE

CERTIFIED LAND CORNER

No. 7

21804330000

I, Harley A. Sime, do hereby certify that on the 13 day of January 1976, I found (evidence) (no evidence) of the N.W. corner of Section 3, T 17 N, R 4W, Fourth Principal Meridian, and I re-established said corner according to the Wisconsin Statutes as shown and described hereon.

Dated this 15 day of Jan. 1976.

Harley A. Sime  
County Surveyor  
Title

History of original corner establishment:

Description of corner evidence found:

Set after surveying out Sections 3 & 4 and gathering further information on the line North into T18N-R4W. The corner was set so as to best fit existing occupied conditions and the original government notes.

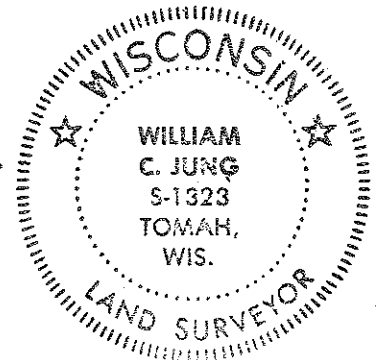

Description of corner and witness monuments, references and accessories used to perpetuate the original or re-established location of this corner:

Set 1 1/4" x 30" iron bar.

**IMPORTANT!** 6/4/76 - Found a 1" iron pipe, down 8"+, at a magnetic bearing of S64°W and a distance of 4.3 ft. from the iron bar we set in January. The pipe was not on record. Left both monuments in. We had already used the bar as the corner for a survey earlier this spring, so we will continue to use the bar as the corner.

Witnesses to corner location:

W.C. Jung - Crew Chief  
G. Sime

Set 1 1/4" x 30" Iron Bar, Down 15" in open field

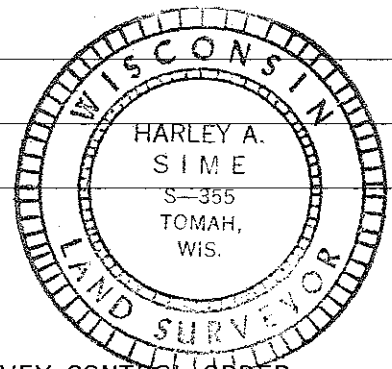
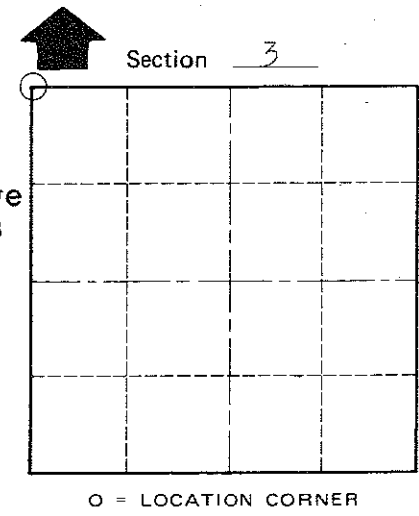
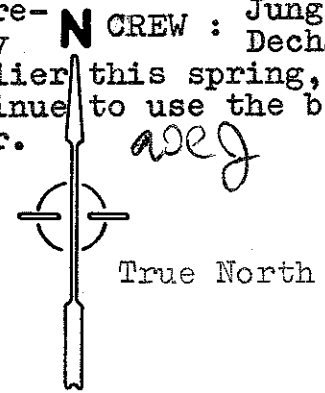
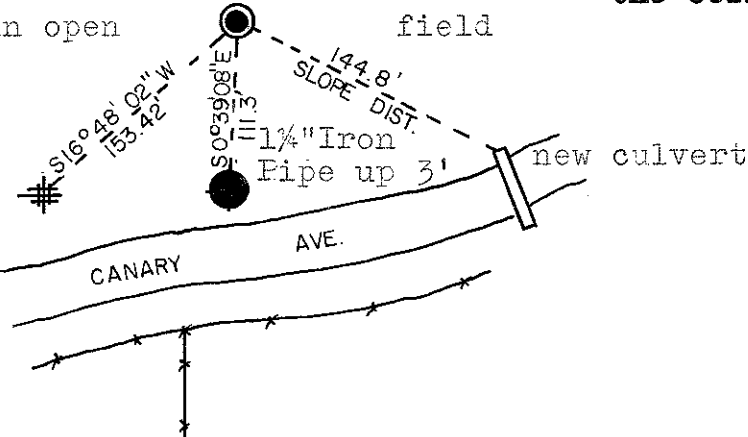

COUNTY SURVEYOR FORM NO. 1

SURVEY CONTROL ORDER

Table with 2 rows: Horizontal, Vertical

WISCONSIN COORDINATE SYSTEM

Table with 5 columns: Corner, East (X), North (Y), Elevation (Z), Zone

City, Village or Town Sparta  
County of Monroe