

CERTIFICATE

CERTIFIED LAND CORNER

No. 118

21804342000

I, Gary L. Dechant, do hereby certify that on the 15th day of July 19 86, I found ~~(evidence)~~ (no evidence) of the W 1/4 corner of Section 35, T 18 N, R 4 W Fourth Principal Meridian, and I re-established said corner according to the Wisconsin Statutes as shown and described hereon.

Dated this 17th day of July 19 86.

Gary L. Dechant
Registered Land Surveyor-1744
Title

History of corner establishment since Original Government Survey

No known recorded history since the original government survey.

Description of corner evidence found:

Set by single proportionate measurement.

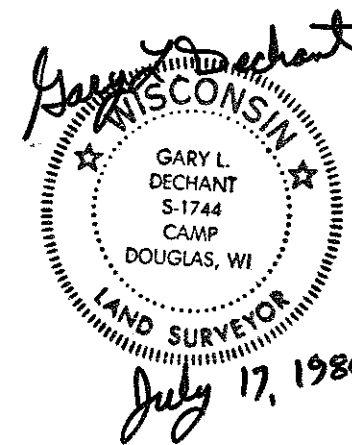

Description of corner and witness monuments, references and accessories used to perpetuate the original or re-established location of this corner:

Trees are double blazed with P.K. Nails set in hack in tree

Witnesses to corner location:

David E. Madison
Gary L. Dechant

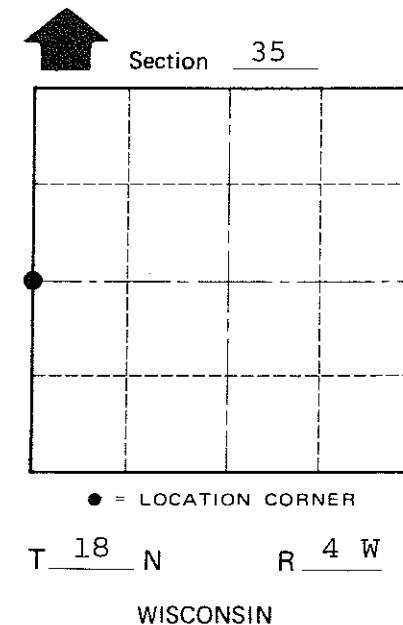
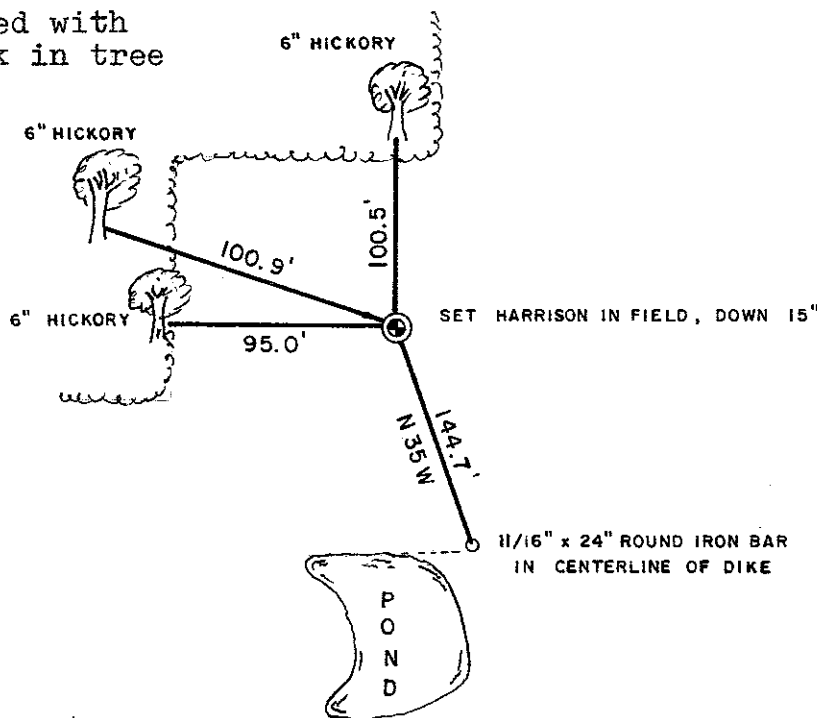

COUNTY SURVEYOR FORM NO. 1

SURVEY CONTROL ORDER

Horizontal	_____
Vertical	_____

WISCONSIN COORDINATE SYSTEM

Corner	East (X)	North (Y)	Elevation (Z)	Zone
Control Sta. Name				

~~City, Village or~~ Town Sparta
County of Monroe