

I, Harley A. Sime, do hereby certify that on the 13 day of January 1976, I found (evidence) (~~no evidence~~) of the N 1/4 corner of Section 2, T 17 N, R 4W, Fourth Principal Meridian, and I re-established said corner according to the Wisconsin Statutes as shown and described hereon.

Dated this 15 day of Jan. 1976.

Harley A. Sime
County Surveyor
Title

History of original corner establishment:

Description of corner evidence found:

Set by field evidence found along the North line of the NE 1/4 of Section 2, including deeds in the court house regarding the old school house site and the ground presently occupied at the old school. The kink at this corner fits existing conditions and is supported by aerial photos.

21804350020

COUNTY SURVEYOR FORM NO. 1

Description of corner and witness monuments, references and accessories used to perpetuate the original or re-established location of this corner:

Set 2 1/2" iron pipe, up 2', in swamp.

Witnesses to corner location:

W.C. Jung - Crew Chief W.C. Jung
G. Sime

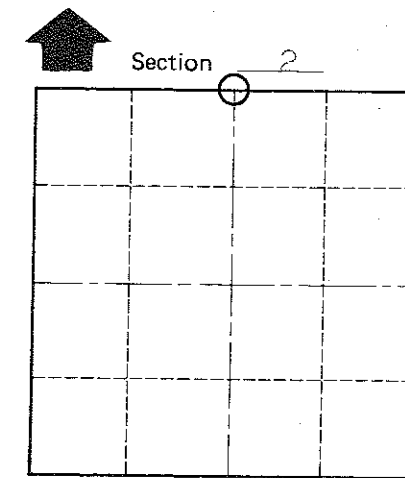
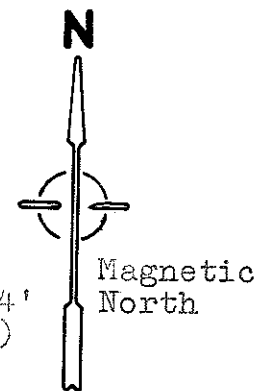
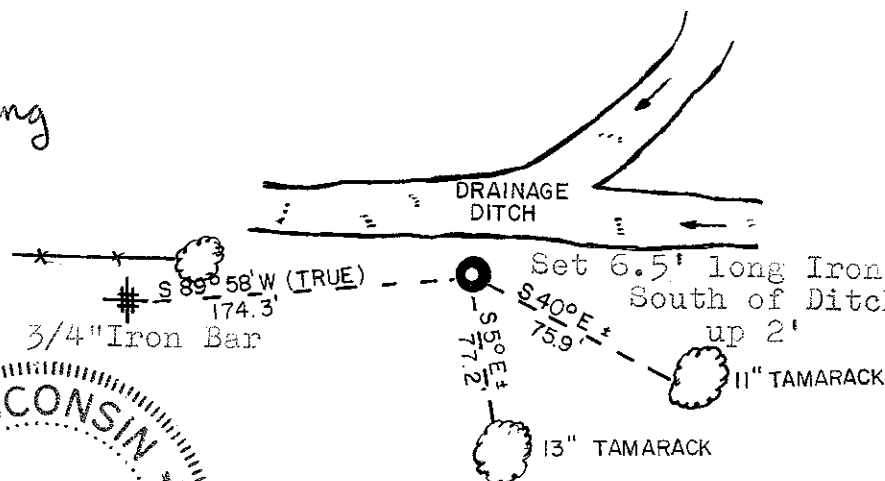
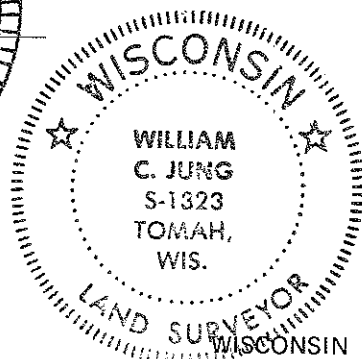
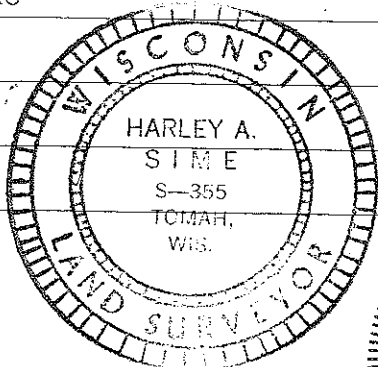

O = LOCATION CORNER

T 17 N R 4W
WISCONSIN

SURVEY CONTROL ORDER

Horizontal	_____
Vertical	_____

Corner	East (X)	North (Y)	Elevation (Z)	Zone
Control Sta. Name				

City, Village or Town Sparta
County of Monroe