

21804100020

I, William C. Jung, do hereby certify that on the 14th day of September 1985 I found (evidence) ~~(no evidence)~~ of the North 1/4 corner of Section 15, T 18 N, R 4 W, Fourth Principal Meridian, and I re-established said corner according to the Wisconsin Statutes as shown and described hereon.

Dated this 16th day of Nov. 1985.

William C. Jung
Registered Land Surveyor 1323
Title

History of corner establishment since Original Government Survey

Fred Zietlow and Duane Marten set an iron bar at the occupied corner in March of 1972.

Description of corner evidence found:

I found the iron bar at the occupied corner and accepted it as the best available evidence of the original government corner. I removed the bar and replaced it with a Harrison marker.

Description of corner and witness monuments, references and accessories used to perpetuate the original or re-established location of this corner:

Witnesses to corner location:

William C. Jung

Bryan Meyer

Dallas Wilhite

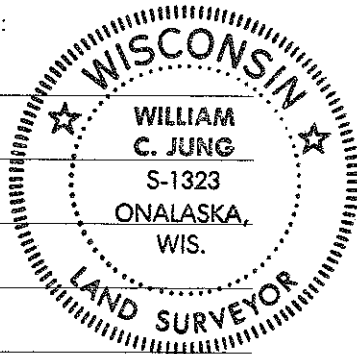

Approved: Harley Sime
County Surveyor

SURVEY CONTROL ORDER

Horizontal _____
Vertical _____

Corner	East (X)	North (Y)	Elevation (Z)	Zone
Control Sta. Name				

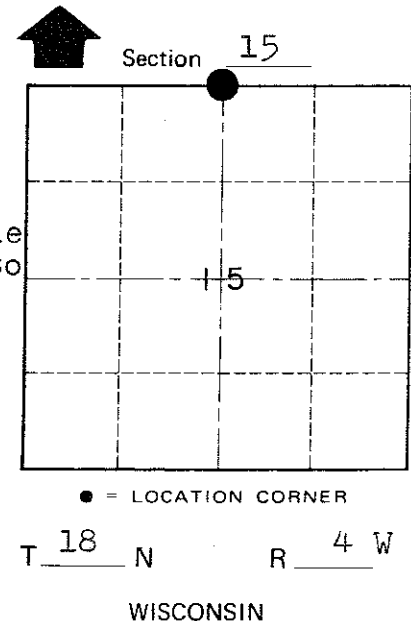
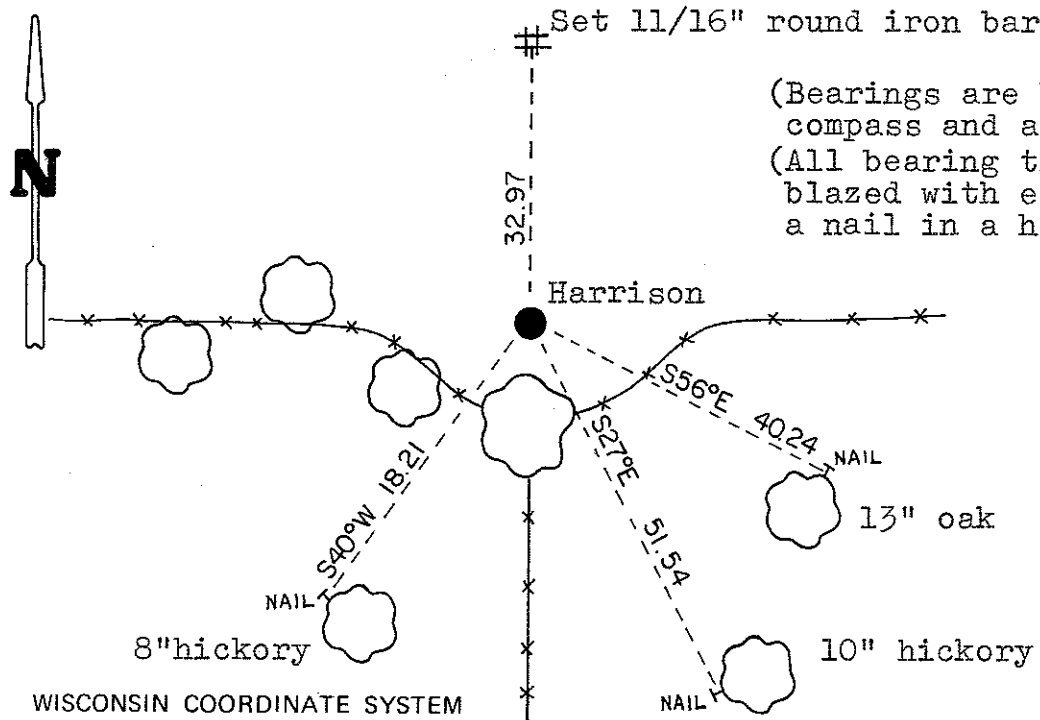

COUNTY SURVEYOR FORM NO. 1

City, Village or Town Little Falls
County of Monroe
Wisconsin