

2180410000

I, William C. Jung, do hereby certify that on the 19th day of October 1985, I found (evidence) ~~(no evidence)~~ of the Northeast corner of Section 15, T 18 N, R 4W, Fourth Principal Meridian, and I re-established said corner according to the Wisconsin Statutes as shown and described hereon.

Dated this 16th day of Nov. 1985.

William C. Jung

Registered Land Surveyor 1323  
Title

History of corner establishment since Original Government Survey

Fred Zietlow and Duane Marten set an iron bar at the occupied corner in March of 1972.

Description of corner evidence found:

I found the iron bar at the occupied corner and accepted it as the best available evidence of the original government corner. I removed the bar and replaced it with a Harrison marker.

Description of corner and witness monuments, references and accessories used to perpetuate the original or re-established location of this corner:

Witnesses to corner location:

William C. Jung  
Bryan Meyer  
Dallas Wilhite

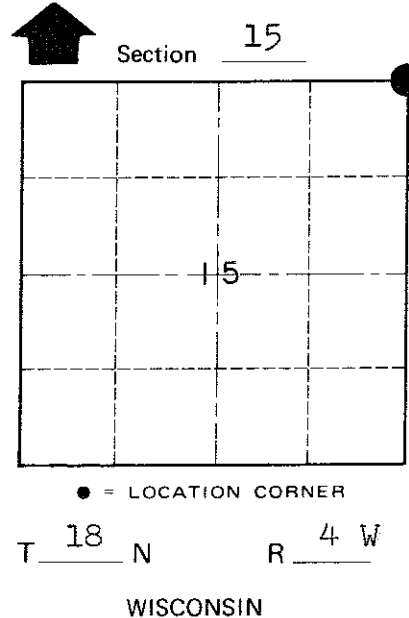
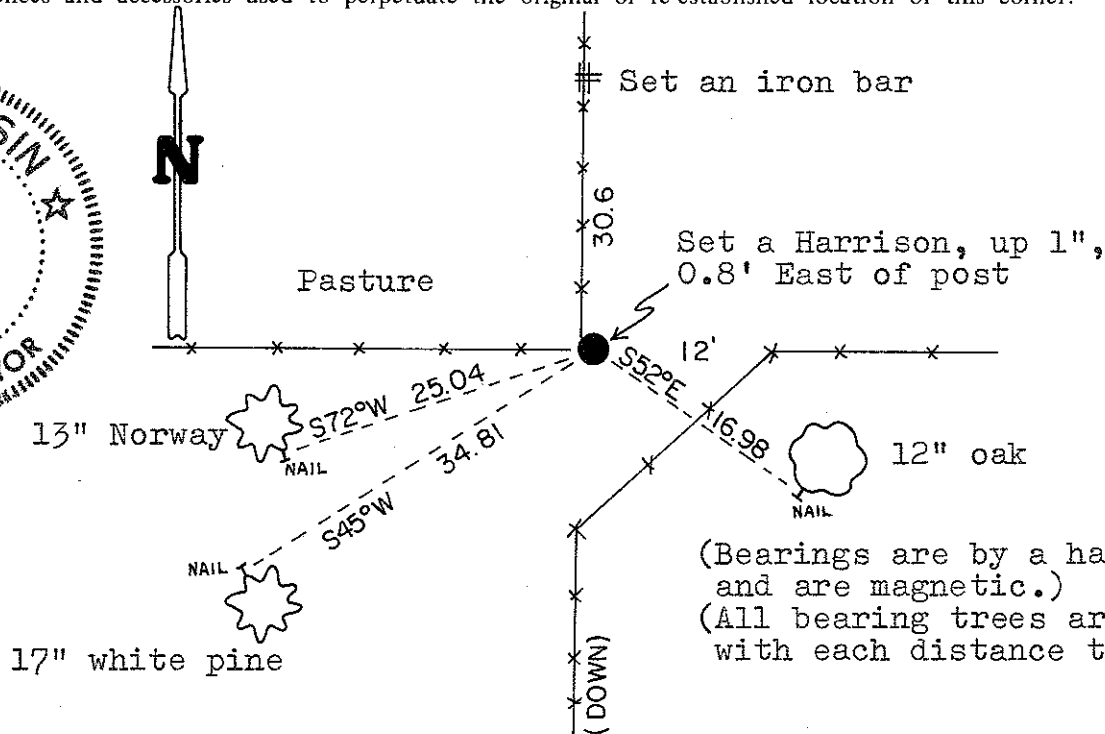
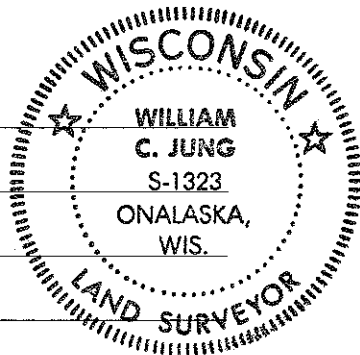

Approved: Harley Sime  
County Surveyor

SURVEY CONTROL ORDER

Horizontal	_____
Vertical	_____

WISCONSIN COORDINATE SYSTEM

Corner	East (X)	North (Y)	Elevation (Z)	Zone
Control Sta. Name				

(Bearings are by a hand compass and are magnetic.)  
(All bearing trees are double blazed with each distance to a nail in a hack.)

City, Village or Town Little Falls  
Monroe  
County of Wisconsin

COUNTY SURVEYOR FORM NO. 1