

21804112000

I, William C. Jung, do hereby certify that on the 26th day of October 1985, I found (evidence) ~~(no evidence)~~ of the East 1/4 corner of Section 11, T 18 N, R 4 W, Fourth Principal Meridian, and I re-established said corner according to the Wisconsin Statutes as shown and described hereon.

Dated this 9th day of Nov. 1985.

William C. Jung
Registered Land Surveyor 1323
Title

History of corner establishment since Original Government Survey

Fred Holden was at this corner in January of 1908 and found the original corner. He blazed a new bearing tree, a 10" white oak, S7°E, 38.7 feet.

Description of corner evidence found:

I accepted the occupied fence corner as the best available evidence of the original government corner. The white oak to the Southeast could possibly be Holden's bearing tree. I searched the area around the corner very thoroughly for evidence of the corner other than the fence corner but found none.

Description of corner and witness monuments, references and accessories used to perpetuate the original or re-established location of this corner:

Witnesses to corner location:

William C. Jung
Bryan Meyer

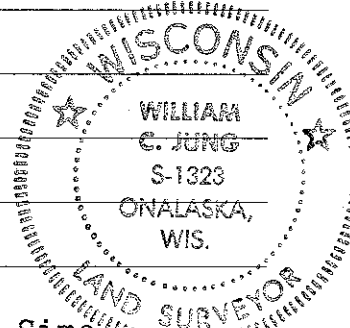

Approved: Harley Sime
County Surveyor

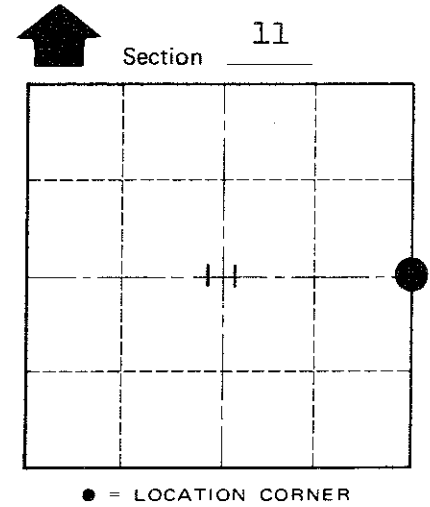
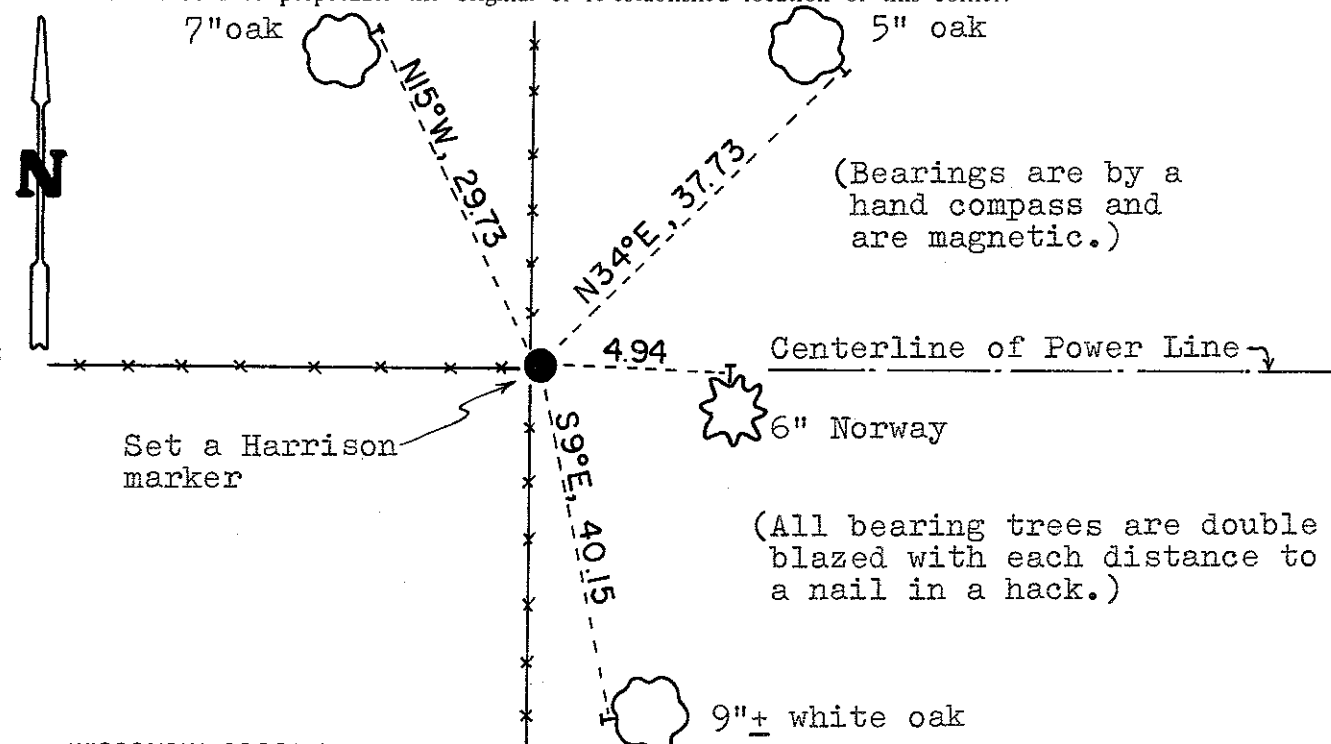

T 18 N R 4 W
WISCONSIN

COUNTY SURVEYOR FORM NO. 1

SURVEY CONTROL ORDER

Horizontal	_____
Vertical	_____

WISCONSIN COORDINATE SYSTEM

Corner	East (X)	North (Y)	Elevation (Z)	Zone
Control Sta. Name				

City, Village or Town Little Falls
County of Monroe
Wisconsin