

21804092000

I, Gary L. Dechant, do hereby certify that on the 18th day of August 19 87, I found (evidence) (XXXXXXXX) of the E 1/4 corner of Section 9, T18 N, R 4 W Fourth Principal Meridian, and I re-established said corner according to the Wisconsin Statutes as shown and described hereon.

Dated this 19th day of Aug. 19 87.

Gary L. Dechant

Reg. Land Surveyor, S-1744

Title

History of corner establishment since Original Government Survey

No known recorded history since the original government survey.

Description of corner evidence found:

Accepted existing fence corner as best available evidence. Fits the section corner to the south within 11 feet of the original notes and very close to a straight line between section corners. However, it appears the original surveyors dropped two chains measuring to the NE corner of the Section.

COUNTY SURVEYOR FORM NO. 1

Description of corner and witness monuments, references and accessories used to perpetuate the original or re-established location of this corner:

Witnesses to corner location:

Scott Teebo

Gary L. Dechant

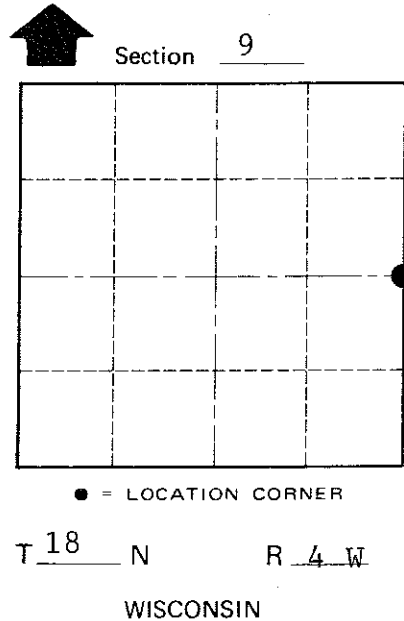
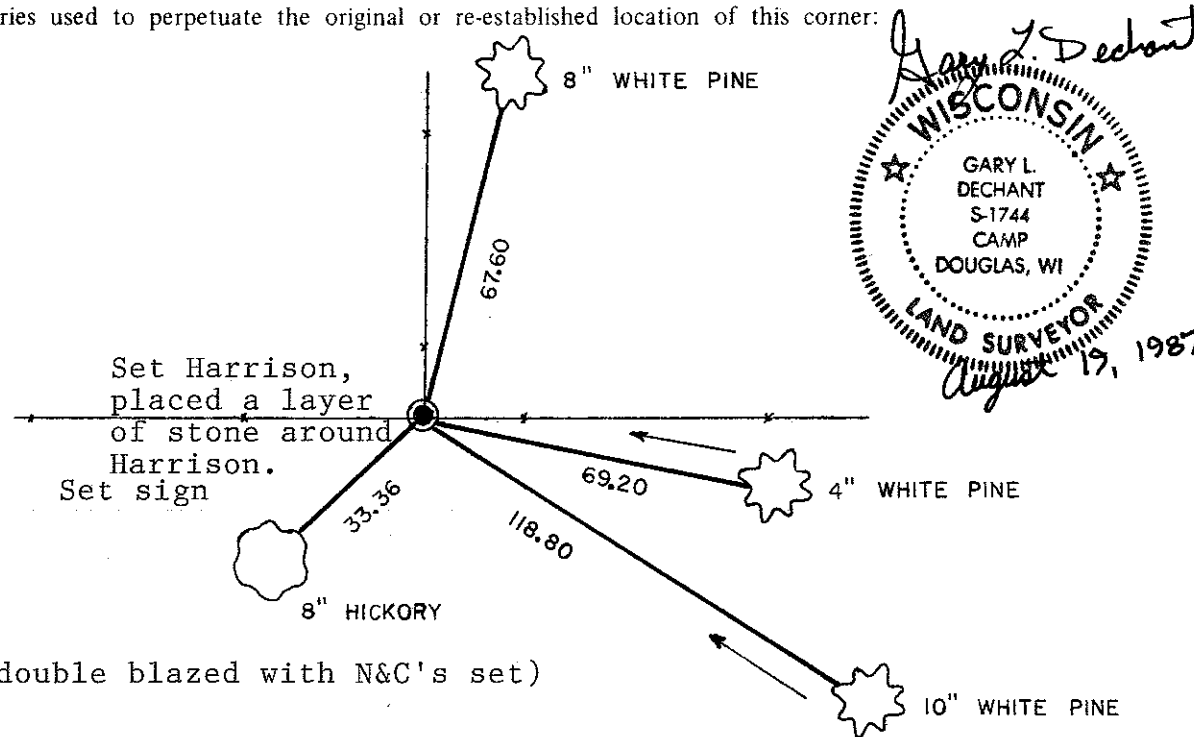

(Trees double blazed with N&C's set)

SURVEY CONTROL ORDER

Horizontal	_____
Vertical	_____

WISCONSIN COORDINATE SYSTEM

Corner	East (X)	North (Y)	Elevation (Z)	Zone
Control Sta. Name				

XXXXXXXXXX Town Little Falls
County of Monroe