

21804052000

I, William C. Jung, do hereby certify that on the 7<sup>th</sup> day of July 1979, I found (evidence) ~~(no evidence)~~ of the East 1/4 corner of Section 5, T 18 N, R 4 W, Fourth Principal Meridian, and I re-established said corner according to the Wisconsin Statutes as shown and described hereon.

Dated this 3rd day of Feb. 1981.

William C. Jung  
William C. Jung, R.L.S. 1323

Approved: HARLEY A. SIME  
MONROE CO. SURVEYOR

Description of corner and witness monuments, references and accessories used to perpetuate the original or re-established location of this corner:

History of original corner establishment:

Fred Holden reestablished this corner in April of 1906. Ray Hurlburt set a pipe at this corner in December of 1967. Duane Marten used this pipe in his survey of December, 1973, as did Garold Sime in March of 1978.

Description of corner evidence found:

Found the corner of record, removed the pipe and replaced it with a Harrison marker.

COUNTY SURVEYOR FORM NO. 1

Witnesses to corner location:

Jung  
Pietz

NOTE: TREES DOUBLE BLAZED WITH NAIL & CAP SET

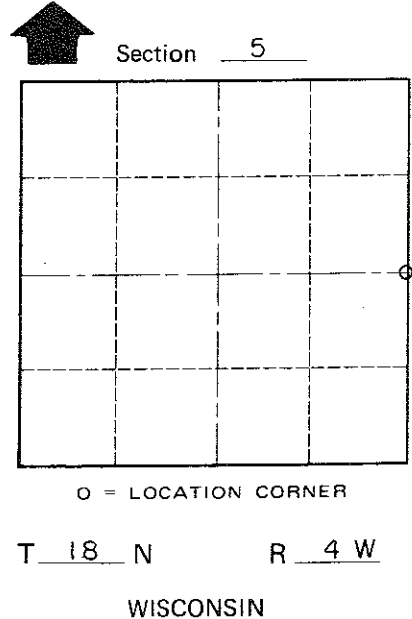
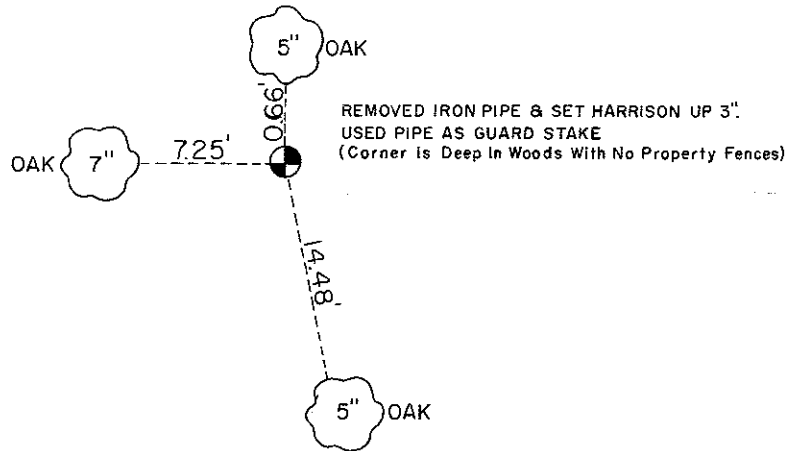
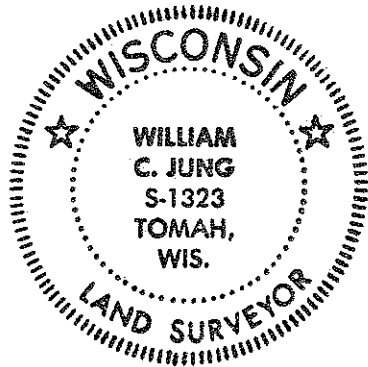

SURVEY CONTROL ORDER

Horizontal \_\_\_\_\_  
Vertical \_\_\_\_\_

WISCONSIN COORDINATE SYSTEM

Corner	East (X)	North (Y)	Elevation (Z)	Zone
Control Sta. Name				

or Town Little Falls  
County of Monroe