

18

**U.S. PUBLIC LAND CORNER
MAINTENANCE**

Corner ID : E1/4 Sec.3, T18N-R4W

21804032000

<u>DATE</u>	<u>CREW</u>	<u>MONUMENT TYPE -----</u>
October 29, 2014	Zachariah P.Dechant Gary L. Dechant	Existing Harrison in tact NE side large Burr Oak (BT) Existing 3/4" iron bar, up 10" east side of Harrison. Fence running east has been removed.

References:

	<u>Bearing</u>	<u>Distance</u>
1) Set 3/4"x24" square iron bar down 14" in field	North	23.88'
2) Set 3/4"x24" square iron bar, down 6"	East	18.98'
3) Set 3/4"x24" square iron bar, down 6", 1' east of fence, 6' east of 12" White Oak	S2E	32.17'
4) Set 3/4"x24" square iron bar, down 6", 3' south of fence	S87W	19.27'



October 29, 2014

I, Harley A. Sime, do hereby certify that on the eighteenth day of June 1980, I found (evidence) ~~(no evidence)~~ of the West 1/4 corner of Section 2, T 18 N, R 4 W Fourth Principal Meridian, and I re-established said corner according to the Wisconsin Statutes as shown and described hereon.

Dated this eighth day of Jan. 19 81.

Harley A. Sime - R.L.S. 355

County Surveyor Monroe County Wisconsin.

History of corner establishment since Original Government Survey

Larry Fedderson was here in July of 1976 and set a 1 1/4" iron bar.

Description of corner evidence found:

I found Fedderson's iron bar and replaced it with a Harrison.

See Reverse Side For Maintenance

COUNTY SURVEYOR FORM NO. 1

Description of corner and witness monuments, references and accessories used to perpetuate the original or re-established location of this corner:

Witnesses to corner location:

Gary Dechant

M. Scott Sowers

Todd Tormoen

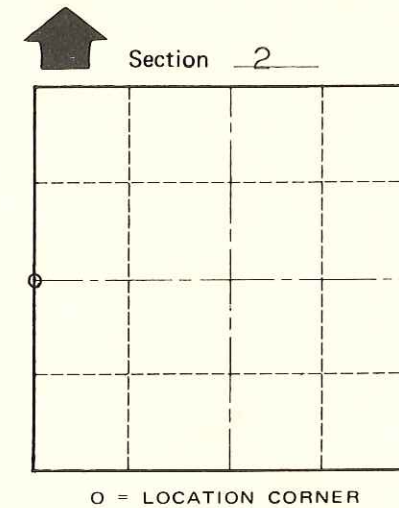
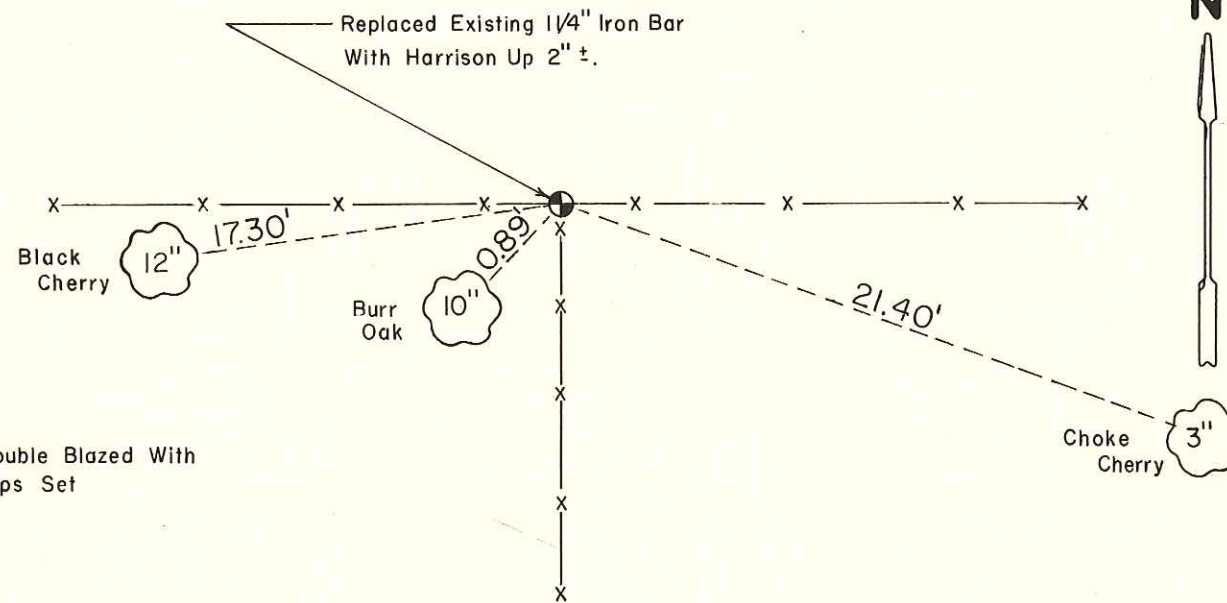

O = LOCATION CORNER
T 18 N R 4 W
WISCONSIN

All Trees Double Blazed With Nail & Caps Set

**Approved: HARLEY A. SIME
MONROE CO. SURVEYOR**

SURVEY CONTROL ORDER

Horizontal	_____
Vertical	_____

WISCONSIN COORDINATE SYSTEM

Corner	East (X)	North (Y)	Elevation (Z)	Zone
Control Sta. Name				

~~City, Village or~~ Town of Little Falls
County of Monroe
Wisconsin