

CERTIFICATE

CERTIFIED LAND CORNER

No. 14

21804012000

I, Garold A. Sime, do hereby certify that on the 21st day of November 1991, I found ~~XXXXXX~~ (no evidence) of the W $\frac{1}{2}$ corner of Section 6, T. 18 N, R. 3 W Fourth Principal Meridian, and I re-established said corner according to the Wisconsin Statutes as shown and described hereon.

Dated this 12th day of Dec. 1991.

Garold A. Sime

Monroe County Surveyor
Title

History of corner establishment since Original Government Survey

W. Kenyon was at this corner in June of 1895.

Description of corner evidence found:

I established this corner on line and by single proportionate measurement between existing section corners.

COUNTY SURVEYOR FORM NO. 1

Description of corner and witness monuments, references and accessories used to perpetuate the original or re-established location of this corner:

Set Harrison Monument at corner

Witnesses to corner location:

Garold A. Sime, R.L.S.

John Kenworthy

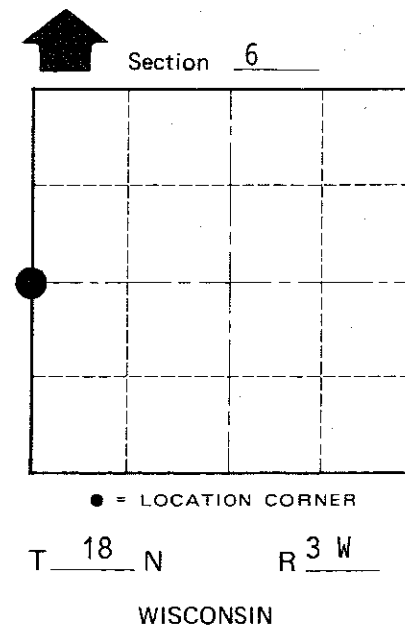
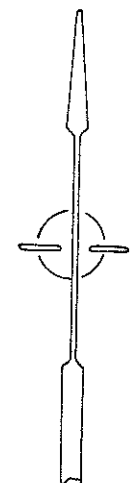
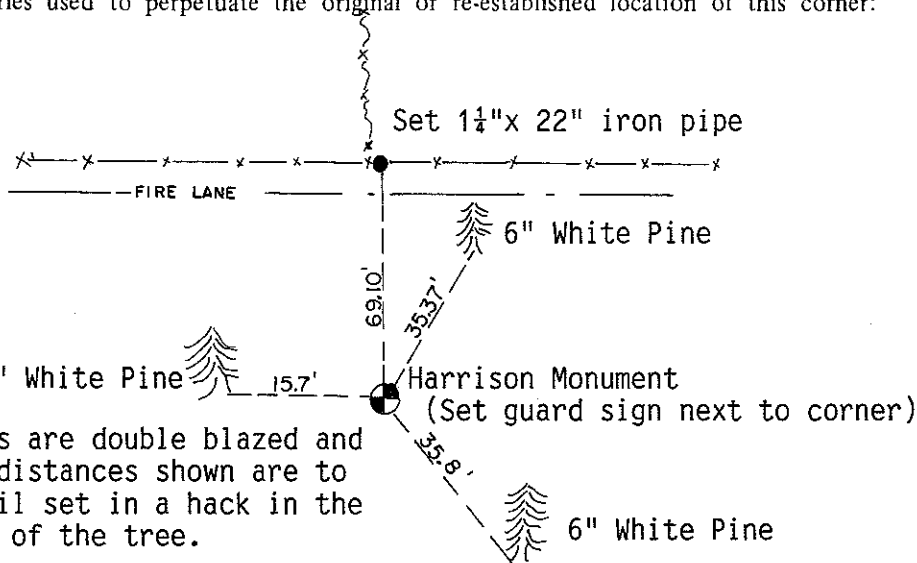
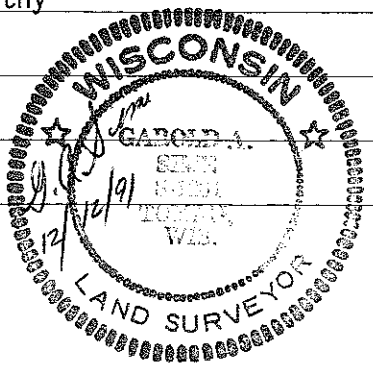

SURVEY CONTROL ORDER

Horizontal	_____
Vertical	_____

WISCONSIN COORDINATE SYSTEM

Corner	East (X)	North (Y)	Elevation (Z)	Zone
Control Sta. Name				

~~XXXXXX~~ or Town of Lafayette

County of Monroe