

21804070000

I, Mark R. Heidecke, do hereby certify that on the 6th day of December 19 79, I found ~~(evidence)~~ (no evidence) of the Southwest corner of Section 8, T.18 N. R.4 W Fourth Principal Meridian, and I re-established said corner according to the Wisconsin Statutes as shown and described hereon.

Dated this 9th day of January 1980.

Mark R Heidecke

Registered Land Surveyor  
Title

History of corner establishment since Original Government Survey

No subsequent history of monument perpetuation since the Original U.S. Government Survey in Monroe County.

Description of corner evidence found:

A Harrison Monument was set at this corner in an East and West fence line by doubling West the distance and line between the South 1/4 corner and an old fence corner at the South 1/16 corner of the Southwest 1/4. This location is compatible with the interior occupation within Section 8.

Description of corner and witness monuments, references and accessories used to perpetuate the original or re-established location of this corner:

Witnesses to corner location:

Mark Heidecke

Lawrence Feddersen

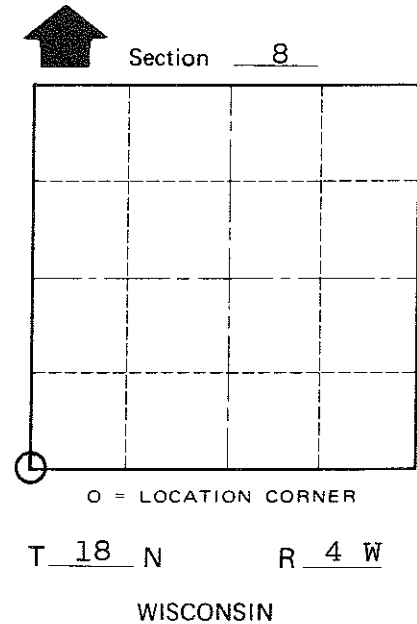
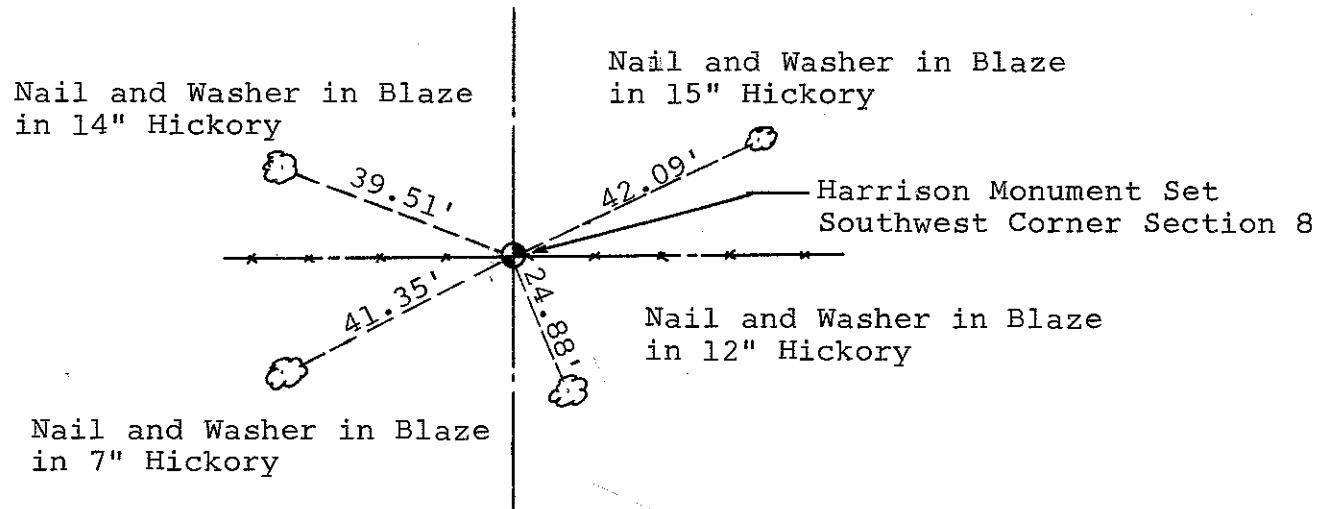

COUNTY SURVEYOR FORM NO. 1

SURVEY CONTROL ORDER

Horizontal
Vertical

WISCONSIN COORDINATE SYSTEM

Corner	East (X)	North (Y)	Elevation (Z)	Zone
Control Sta. Name				

~~XXXXXX~~ Town of Little Falls  
County of Monroe