

21804080000

I, Gary L. Dechant, do hereby certify that on the 18th day of August 19 87, I found (evidence) (~~XXXXXXXX~~) of the SW corner of Section 9, T 18 N, R 4 W Fourth Principal Meridian, and I re-established said corner according to the Wisconsin Statutes as shown and described hereon.

History of corner establishment since Original Government Survey

Fred Holden was here in May or June of 1907.

Description of corner evidence found:

Set corner in existing north-south fence and on line with the S $\frac{1}{4}$ and SE corners of the section. This location fits within 4 feet of the original notes to the south, but is about 1 $\frac{1}{2}$ chains short to the W $\frac{1}{4}$ of Section 9. I did not prorate this corner as I feel the original surveyors had problems in Section 9 and did not want to carry it into the sectionsto the south. Also, Holden shows a distance along the east side of section 17 of 5306.40 finding no shortage on the line running north between sections 16 and 17.

Dated this 19th day of Aug. 19 87.

Gary L. Dechant

Reg. Land Surveyor, S-1744

Title

Description of corner and witness monuments, references and accessories used to perpetuate the original or re-established location of this corner:

Witnesses to corner location:

Scott Teebo

Gary L. Dechant

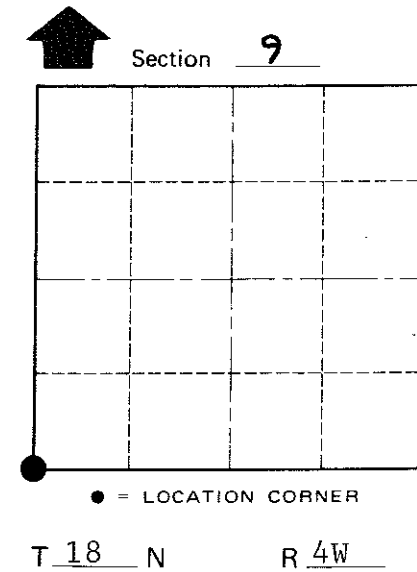
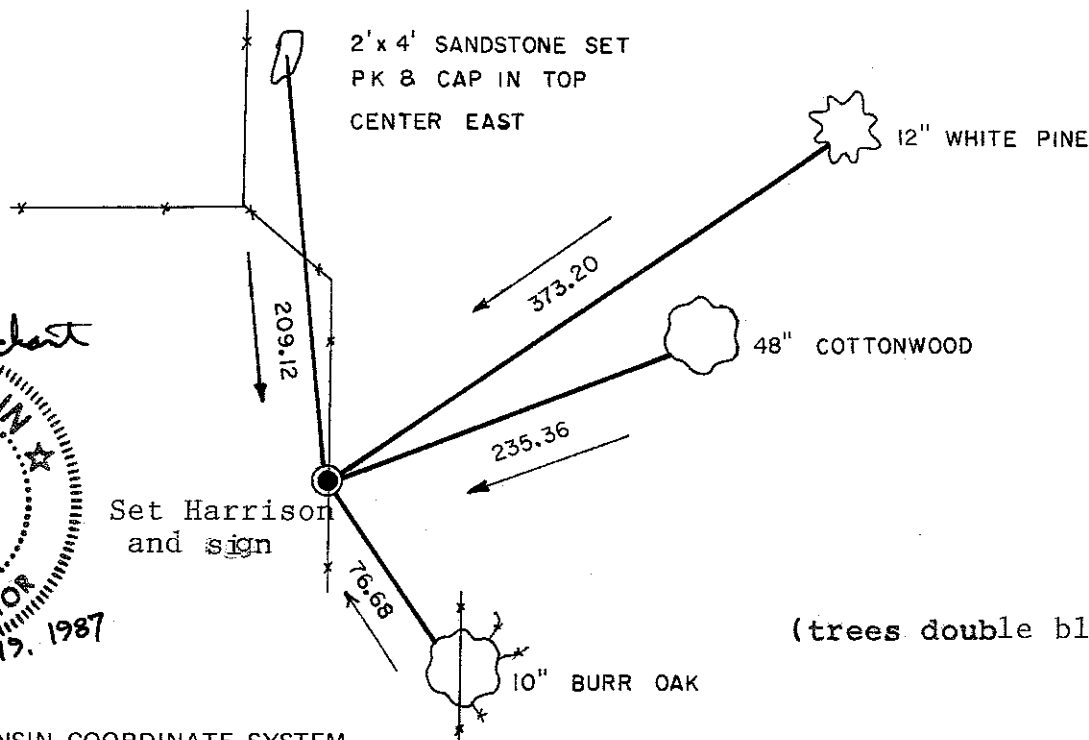

(trees double blazed with N&C's set)

COUNTY SURVEYOR FORM NO. 1

SURVEY CONTROL ORDER

Horizontal	_____
Vertical	_____

WISCONSIN COORDINATE SYSTEM

Corner	East (X)	North (Y)	Elevation (Z)	Zone
Control Sta. Name				

~~XXXXXXXX~~ Town Little Falls

County of Monroe