

U.S. LAND CORNER MAINTENANCE

Corner ID : E1/4 Sec. 22, T18N-R1E
41801222000

DATE	CREW	MONUMENT TYPE -----
August 27, 2013	Zachariah P. Dechant Gary L. Dechant	Existing 1 1/4" iron bar in centerline "PP", 18' north of centerline Excelsior Ave, 12' south of concrete bridge

Highway construction is currently taking place. Milling of the old pavement is to be part of the reconstruction.

References:

- 1) Set 1/2"x24" iron pipe down 8", 6' north of guard rail
- 2) Existing Al disc in SE corner of Bridge abutment
- 3) Existing 3/4" iron bar west side of plastic r/w post, down 6"
- 4) Existing 3/4" iron bar west side of plastic r/w post

Bearing	Distance
West	61.54'
N55E	21.06'
S59E	54.66'
S59W	112.55'

Angles measured between points	1-2	144°52'37"
	2-3	64°31'02"
	3-4	121°46'42"
	4-1	28°49'39"

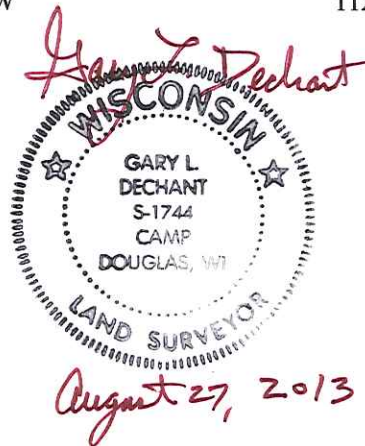

I, William C. Jung, do hereby certify that on the eighth day of May 1981, I found (evidence) ~~(no evidence)~~ of the East 1/4 corner of Section 22, T 18 N, R 1 E, Fourth Principal Meridian, and I re-established said corner according to the Wisconsin Statutes as shown and described hereon.

Dated this 2nd day of Sept. 1981.

William C. Jung
 William C. Jung, R.L.S. 1323
 Title

History of original corner establishment:

Donald Mulock was at this corner in August of 1967 and set a R.R. spike. Feddersen set a 1 1/4" iron bar by an existing 3/4" iron bar in May of 1976. Malliet used this 1 1/4" iron bar in his survey of September, 1977.

Description of corner evidence found:

Found the 1 1/4" iron bar, removed it and replaced it with a Harrison marker.

1996 UPDATE: This corner was in danger of being destroyed when the bridge just to the North was to be replaced. On March 12, 1996 new ties were taken and the Harrison removed. On September 25, 1996, a 1 1/2" x 30" round iron bar was set at the corner location and newer ties were taken as illustrated below.

Description of corner and witness monuments, references and accessories used to perpetuate the original or re-established location of this corner:

Witnesses to corner location:

William C. Jung
Carlton R. Pietz

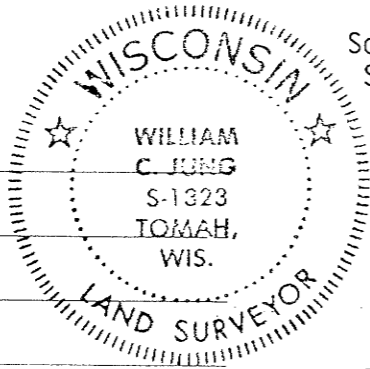

Southeast bolt at Southwest end of bridge rail.

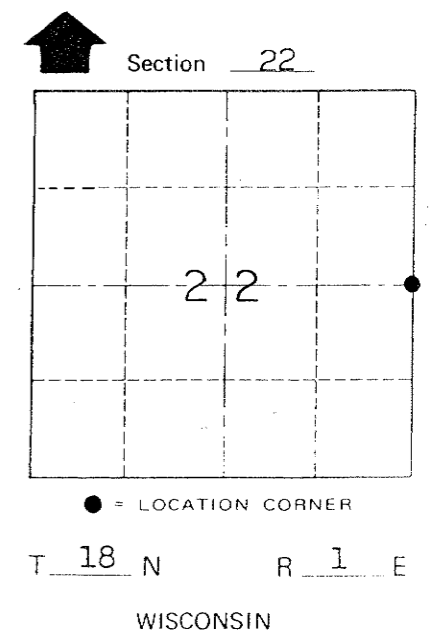
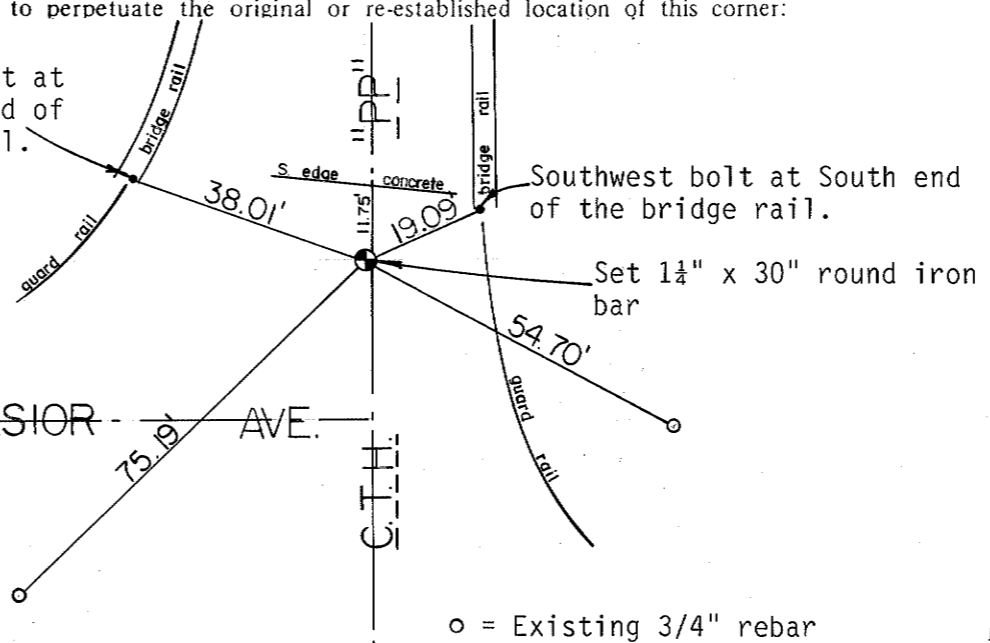

Approved: HARLEY A. SIME
 MONROE CO. SURVEYOR

SURVEY CONTROL ORDER

Horizontal	_____
Vertical	_____

1996 CREW: Bryan H. Meyer
 Matthew Schrieber
 September 25, 1996

WISCONSIN COORDINATE SYSTEM

Corner	East (X)	North (Y)	Elevation (Z)	Zone
Control Sta. Name				

~~City/Village of~~ Town of Byron
 County of Monroe

H. A. Sime and Associates
 P. O. Box 50
 Tomah, Wisconsin 54660
 Phone: (608)-372-5392

COUNTY SURVEYOR FORM NO. 1